

#	BEARING	DIST.	PER D.B. 1482-419
1	S 3°-40'-.40" E	20.61'	(S 4°-45'-10" E)
2	S 26°-55'-.30" E	64.34'	(N 28°-00' W)
3	S 59°-55'-.30" E	19.18	(N 61°-00' W)
4	N 66°-19'-.56" W	20.01'	
5	N 44°-36'-.50" W	35.96'	
6	N 3°-40'-.40" W	33.41'	
7	N 26°-55'-.30" W	35.67'	

DB 4213 525-556

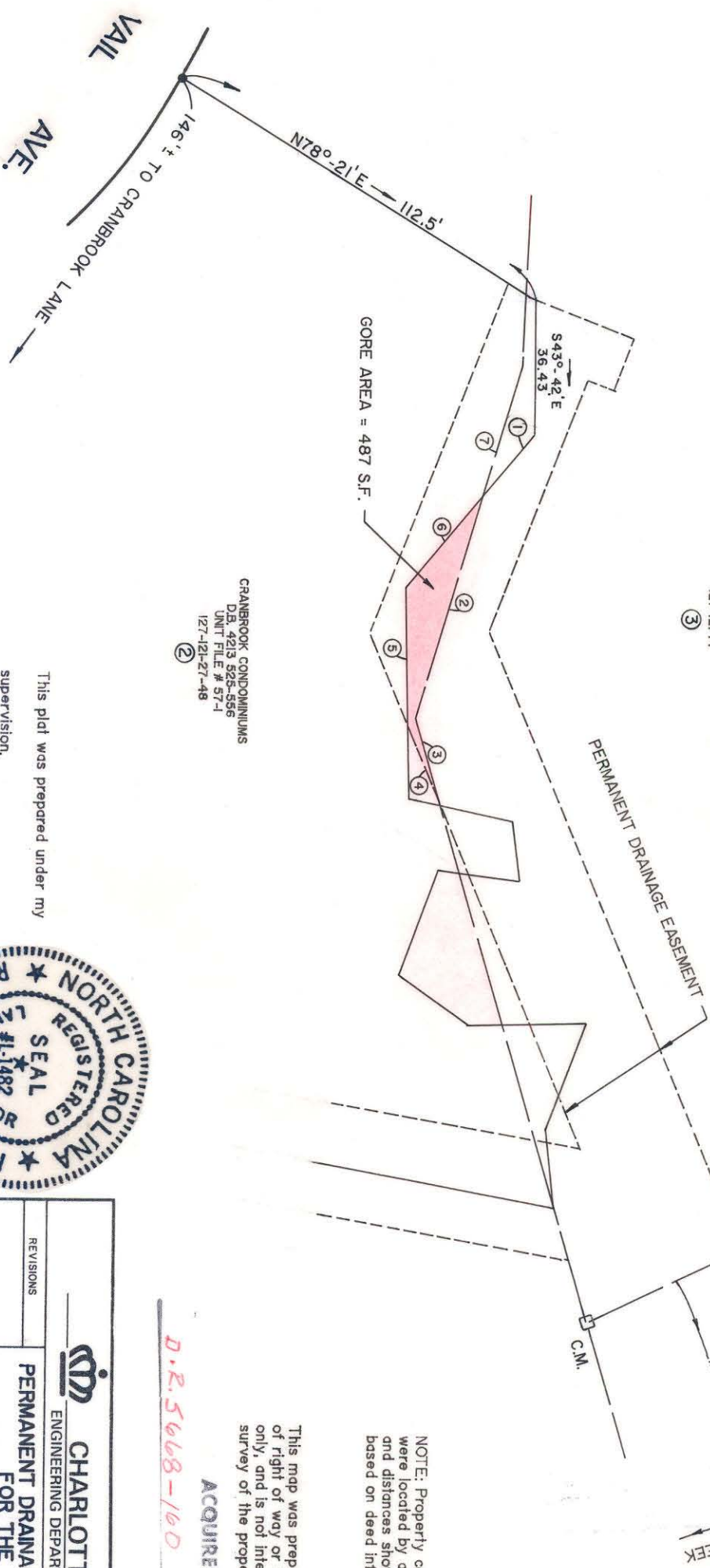

MARTHA WASHINGTON HOMES, INC.
D.B. 1482-419; M.B. 3-126
127-12-14

CRANBROOK CONDOMINIUMS
D.B. 4213 525-556
UNIT FILE # 57-1
127-12-27-48

GORE AREA = 487 S.F.

N78°-21'E 112.5'
146' TO CRANBROOK LANE
VAIL AVE

PERMANENT DRAINAGE EASEMENT

500'±
BRIAR CREEK

PROPERTY LINE LEGEND:
..... MARTHA WASHINGTON HOMES, INC.
..... CRANBROOK CONDOMINIUMS

NOTE: Property corners shown circled were located by actual survey. Bearings and distances shown in parenthesis are based on deed information.

This map was prepared for the purpose of right of way or easement acquisition only, and is not intended to be a boundary survey of the property shown.

ACQUIRED 12-23-87
D.R. 5668-160

This plat was prepared under my supervision.

R. Dennis Smith

N.C. Reg. Surveyor No. L-1482.



<p>CHARLOTTE ENGINEERING DEPARTMENT</p>		<p>JOB NO. 512-87-114</p>	
<p>PERMANENT DRAINAGE ESM'T. FOR THE CITY OF CHARLOTTE</p>		<p>FILE NO.</p>	
<p>APPERT GORE AREA BETWEEN MARTHA WASHINGTON HOMES, INC. AND CRANBROOK CONDOMINIUMS</p>		<p>SHEET 4 OF 4</p>	
<p>REVISIONS</p>	<p>DRAWN BY M.K.C.</p>	<p>DATE 7/15/87</p>	<p>SCALE 1" = 40'</p>
<p>CHECKED BY <i>R.D.S.</i></p>	<p>SURVEY SUPERV. <i>R. Dennis Smith</i></p>		

127-12-14