

IP is 471.83' Measured North-westerly along the Northern Margin of the 60' Idlewild Rd R/W to the Easterly Margin of the Idlebrook Dr. R/W

THOMAS & MINNIE EDWARDS  
TAX CODE 133-211-15  
DEED 1300-420

ASSOC. REFORMED PRES. 1.61'  
CHURCH GEN. SYNOD  
TAX CODE 133-211-14  
DEED 3214-135  
3357-076

DETAIL A  
SCALE 1" = 20'

THOMAS & MINNIE EDWARDS  
TAX CODE 133-211-21  
DEED 4947-522

TOTAL AREA (BY DEED) 36,248 SF  
UTILITY EASEMENT 165 SF

AREA TO BE ACQUIRED 1,364 SF  
AREA REMAINING 34,884 SF

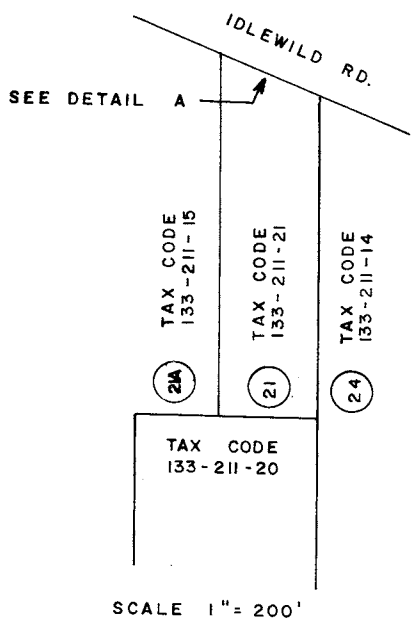

ACQUISITION BY CITY  
RECORDED IN DEED BOOK  
6180-0962  
DATE 12/29/89

This map was prepared for the purpose of fee simple, right of way or easement acquisition only, and is not intended to be a boundary survey of the property shown.

NOTE: Bearings and distances shown in parenthesis are based on deed information.  
This plat was prepared under my supervision  
*Henry [Signature]*  
NC Regl. Surveyor No. L-3015

I. CONSTR. EASEMENT

<b>CHARLOTTE</b> ENGINEERING DEPARTMENT		JOB NO. 512-85 -127 FILE NO.
REVISIONS 1. 5/16/89 2. 6/23/89 ADJ. PARCEL NO.	IDLEWILD ROAD WIDENING PROPERTY OF THOMAS & MINNIE EDWARDS	SHEET 21
DRAWN BY EDW CHECKED BY JAT		OF
DATE FEB. 1989		SCALE AS SHOWN

122-211