

I, _____ REVIEW OFFICER OF MECKLENBURG COUNTY, CERTIFY THAT THE MAP OR PLAT TO WHICH THIS CERTIFICATION IS AFFIXED MEETS ALL STATUTORY REQUIREMENTS OF NORTH CAROLINA GENERAL STATUTES FOR RECORDING.

REVIEW OFFICER _____ DATE _____ TAX # 14504228 EMBP PROPERTIES, LLC DB 14603, PG 769 LOT 21, BLOCK 1 MB 6, PG 3 2710 MAYFLOWER ROAD

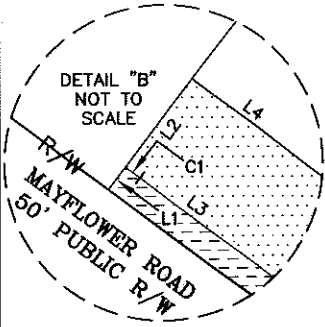

TAX # 14504230 RBP INVESTMENTS LLC DB 18605, PG 935 LOT 19, BLOCK 1 MB 6, PG 3 2616 PHILLIPS AVENUE

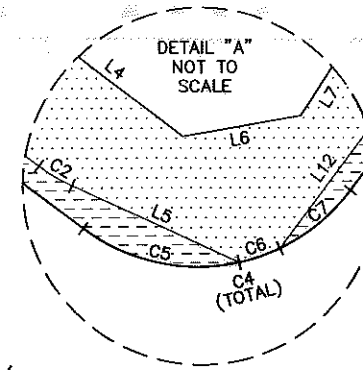

TAX # 14504229 TOMMY LEE HEMPHILL AND WIFE RUTH ANN H. HEMPHILL DB 3101, PG 58 LOT 20, BLOCK 1 MB 6, PG 3 2624 PHILLIPS AVENUE

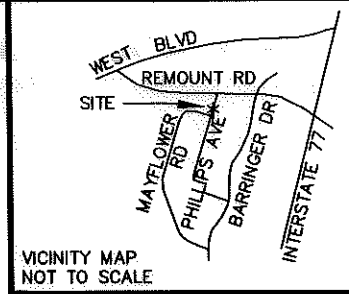
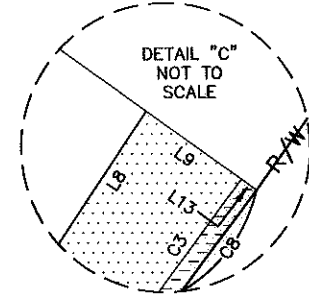

TAX # 14504402 ROBERT WILLIAMS AND CATHERINE WILLIAMS DB 3614, PG 935 LOT 44, BLK 2 MB 6, PG 3 2715 MAYFLOWER ROAD



TAX # 14504507 PAUL GILLARD JR AND BETTY W GILLARD DB 3115, PG 208 LOT 37, BLK 3 MB 6, PG 3 2625 PHILLIPS AVENUE



- NOTE:
- 1) BEARINGS AND DISTANCES SHOWN IN PARENTHESES ARE BASED ON RECORDED MAP OR DEED INFORMATION.
 - 2) TOTAL AREA: 13,561 SF, 0.311 AC
 - 3) AREA IN TCE: 2,233 SF, 0.051 AC
 - 4) AREA IN SUE: 573 SF, 0.013 AC
 - 5) FEE AREA REMAINING: 13,561 SF, 0.311 AC

TAX # 14504401 LELIA PAYTON-JOHNSON DB 23296, PG 551 LOT 1, BLK 2 MB 6, PG 3 2701 MAYFLOWER ROAD



TAX # 14504508 DARLENE C STEWART DB 8938, PG 779 LOT 36, BLK 3 MB 6, PG 3 2629 PHILLIPS AVENUE



TAX # 14504509 FRANK SUTHERLAND AND JANICE SUTHERLAND DB 15454, PG 955 LOT 35, BLK 3 MB 6, PG 3 2635 PHILLIPS AVENUE

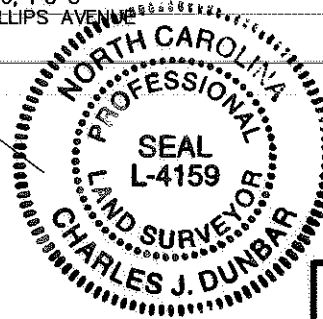

I, CHARLES J. DUNBAR, CERTIFY THAT THIS PLAT WAS PREPARED UNDER MY SUPERVISION AND THAT THIS PLAT WAS PREPARED FOR THE PURPOSE OF EASEMENTS ONLY, AND IS NOT INTENDED TO BE A BOUNDARY SURVEY OF PROPERTY SHOWN.

CHARLES J. DUNBAR NC PLS L-4159 DATE 5/6/10

LEGEND

- TCE = TEMPORARY CONSTRUCTION EASEMENT
 SUE = PERMANENT SIDEWALK AND UTILITY EASEMENT
- [Dotted pattern] = TCE
 - [Dashed pattern] = SUE
 - [Solid line] = TCE
 - [Dashed line] = EXISTING R/W
 - [Solid line with dashes] = SUE
 - [Circle with dot] = IRON PIN FOUND

LINE TABLE		
LINE	LENGTH	BEARING
L1	2.94	N36°58'56"E
L2	11.50	N36°58'56"E
L3	90.57	S52°42'08"E
L4	102.60	S52°42'21"E
L5	19.40	S65°20'37"E
L6	12.59	N80°15'17"E
L7	60.13	N33°20'04"E
L8	31.69	N33°50'32"E
L9	12.16	S54°18'48"E
L10	11.64	N49°00'18"E
L11	11.91	N25°24'59"E
L12	58.71	N37°08'54"E
L13	1.96	S54°18'48"E

CURVE TABLE				
CURVE	LENGTH	RADIUS	CHORD BRG	CHORD DIST
C1	1.89	253.50	N52°54'59"W	1.89
C2	3.97	18.00	S59°01'23"E	3.96
C3	22.85	766.50	N36°47'55"E	22.85
C4	31.52	20.00	N82°17'57"E	28.36
C5	17.42	20.00	S77°39'06"E	16.87
C6	4.12	20.00	N71°39'23"E	4.11
C7	9.99	20.00	N51°27'25"E	9.88
C8	18.36	812.00	N36°20'19"E	18.36

100004583v02_PARCEL 28

CHARLOTTE
ENGINEERING DEPARTMENT

REVISIONS

1- OWNERSHIP CORRECTION (05-06-2010)

SCALE 1" = 40'

REVOLUTION PARK NIP

PROPERTY ACQUISITION OWNER: TOMMY LEE HEMPHILL AND WIFE RUTH ANN H. HEMPHILL CHARLOTTE, MECKLENBURG CO., NC

DATE: 03-29-2010 CHECKED BY: CJD SURVEY SUPVR.: CJD

JOB NO. 512-07-035
FILE NO. PARCEL 28
SHEET 1 OF 1

PBS Plans Prepared By:
 5200 77 CENTER DRIVE, SUITE 500
 CHARLOTTE, NORTH CAROLINA 28217
 (704) 522-7275 NCCOA: F-0326