

I, KENNETH M. GREEN, CERTIFY THAT THIS PLAT WAS PREPARED UNDER MY SUPERVISION AND THAT THE PLAT WAS PREPARED FOR THE PURPOSE OF EASEMENT ACQUISITION ONLY, AND IS NOT INTENDED TO BE A BOUNDARY SURVEY OF THE PROPERTY SHOWN HEREON.

KENNETH M. GREEN, PLS  
5-11-10

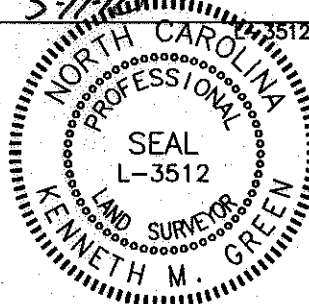

- LEGEND:**
- - IRON FOUND
  - △ - MONUMENT FOUND
  - - PROPERTY LINE
  - R/W- - R/W LINE
  - e- - TEMPORARY CONSTRUCTION EASEMENT (TCE)
  - [Dotted Box] - TCE HATCH
  - SDE- - STORM DRAIN EASEMENT (SDE)
  - [Hatched Box] - STORM DRAIN EASEMENT HATCH
  - - - - ADJOINER
  - PDE- - EXISTING PERMANENT DRAINAGE EASEMENT (PDE)
  - [Cross-hatched Box] - EXISTING PDE HATCH

14,436 SF TOTAL AREA BY PLAT  
 993 SF IN STORM DRAIN EASEMENT (SDE)  
 401 SF IN TEMP CONST ESMT (TCE)  
 1,825 SF IN EXISTING PERMANENT DRAINAGE EASEMENT (PDE)  
 14,436 SF REMAINING

PREPARED BY: FIRM #P-0197

**R. Joe Harris & Associates, P.L.L.C.**  
 Engineering & Land Surveying  
 1698 W. HWY 160, SUITE 130, FORT MILL, SC, 29708  
 Phone: (803) 802-1799

NGCS MONUMENT  
 'COVER'  
 NC GRID COORDS  
 (NAD '83)  
 N=525,634.068  
 E=1,436,565.938

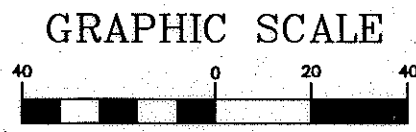

( IN FEET )  
 1 inch = 40 ft.

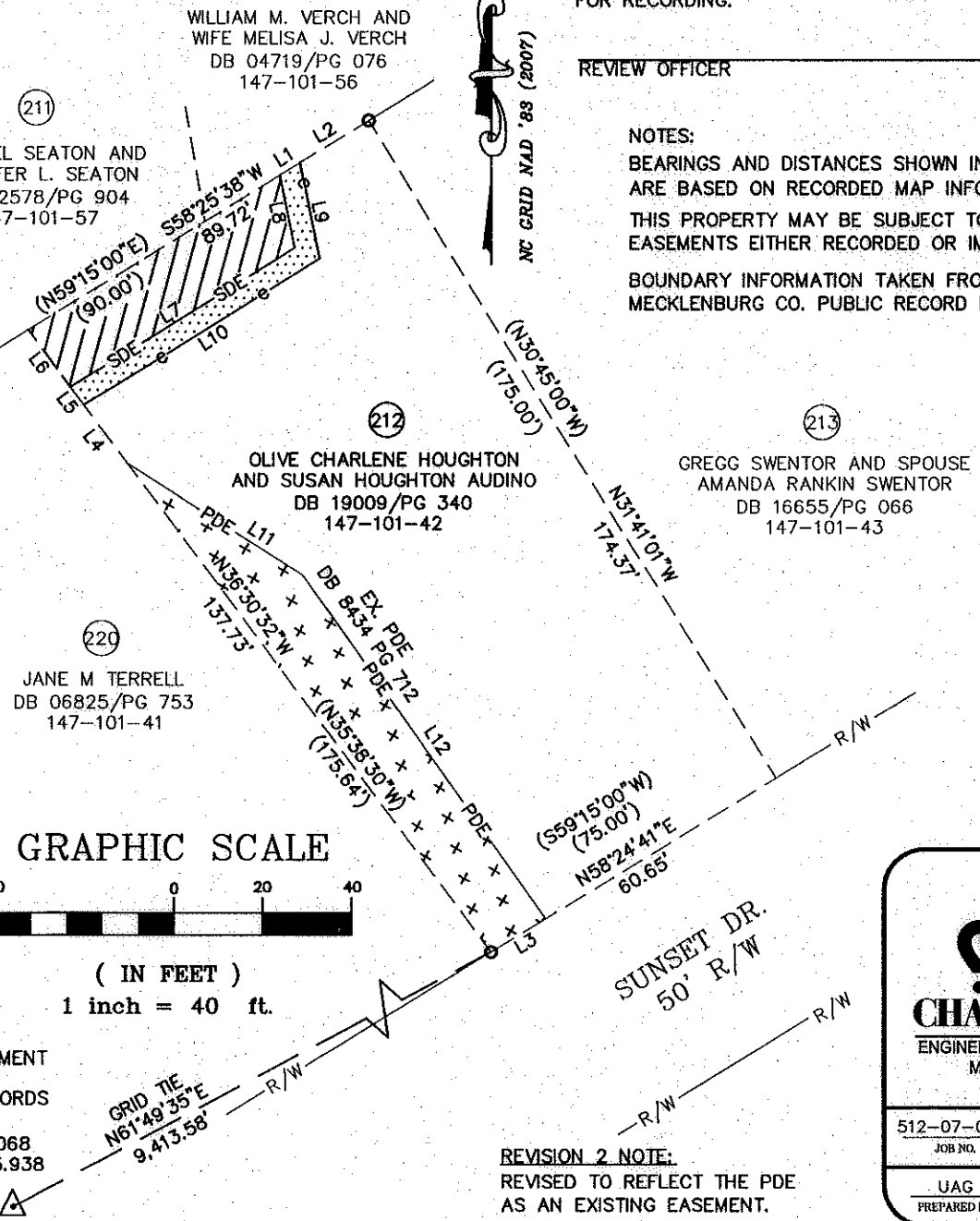

I, \_\_\_\_\_ REVIEW OFFICER OF MECKLENBURG COUNTY CERTIFY THAT THE MAP OR PLAT TO WHICH THIS CERTIFICATION IS AFFIXED MEETS ALL STATUTORY REQUIREMENTS FOR RECORDING.

REVIEW OFFICER \_\_\_\_\_ DATE \_\_\_\_\_

NOTES:  
 BEARINGS AND DISTANCES SHOWN IN PARENTHESIS ARE BASED ON RECORDED MAP INFORMATION.  
 THIS PROPERTY MAY BE SUBJECT TO OTHER EASEMENTS EITHER RECORDED OR IMPLIED.  
 BOUNDARY INFORMATION TAKEN FROM COMPILED MECKLENBURG CO. PUBLIC RECORD INFORMATION.

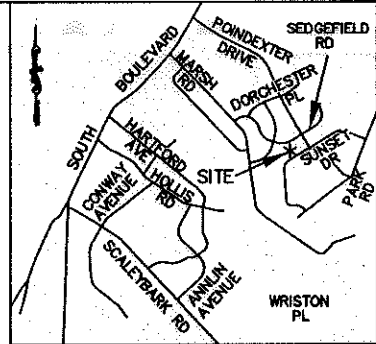

LINE TABLE		
LINE	LENGTH	BEARING
L1	5.31	N58°25'38"E
L2	18.06	N58°25'38"E
L3	14.35	N58°24'41"E
L4	16.32	N36°30'32"W
L5	5.02	N36°30'32"W
L6	15.97	N36°30'32"W
L7	59.33	S58°12'48"W
L8	16.68	S11°47'34"E
L9	21.98	S11°47'34"E
L10	62.42	S58°12'48"W
L11	47.04	S57°12'04"E
L12	94.98	S35°06'29"E

REV. 2 05-10-10  
 REV. 1 04-23-10 RJH PROJ. #1341.05

 <b>CHARLOTTE</b> ENGINEERING & PROPERTY MANAGEMENT		<b>EASEMENT ACQUISITION</b> <b>COLONIAL VILLAGE -</b> <b>SEDGEFIELD NEIGHBORHOOD</b> <b>IMPROVEMENTS</b>	
512-07-032 JOB NO.	1" = 40' SCALE	PARCEL 212 REV 2.DWG CAD FILE NAME	SHEET <b>1</b>
UAG PREPARED BY	07-08-09 DATE		OF <b>1</b>

REVISION 2 NOTE:  
 REVISED TO REFLECT THE PDE AS AN EXISTING EASEMENT.

ACQUISITION BY DB 25948 PG 546-550