

LEGEND

- IRON PIN FOUND
- TEMPORARY CONSTRUCTION EASEMENT
- EXISTING PROPERTY LINE
- EXISTING RIGHT OF WAY
- TEMPORARY CONSTRUCTION EASEMENT LINE
- EXISTING CURB OF PAVEMENT
- LOT NUMBER
- PERMANENT SIDEWALK EASEMENT LINE
- PERMANENT SIDEWALK & UTILITY EASEMENT
- RIGHT OF WAY MONUMENT



State of North Carolina
County of Mecklenburg

I, County, certify that the map or plat to which this certification is affixed meets all statutory requirements for recording.

Review Officer _____ Date _____

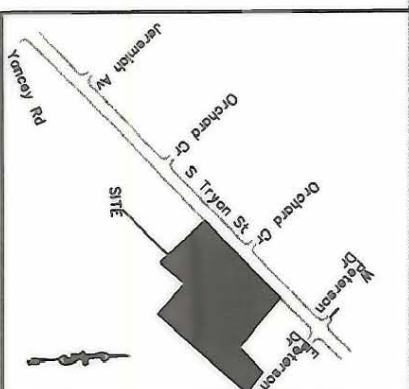
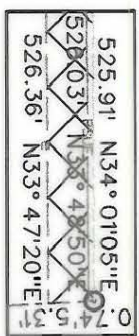

TP* 149-032-20
PIEDMONT NATURAL GAS CO
DB 8079 PG 237
S TRYON ST

TP* 149-032-11
EXECUTIVE BUILDING CO
DB 5388 PG 170
335 E PETERSON DR

TP* 149-032-17
CLARKSON JONES JR
& MARY C J COON
DB 4500 PG 494
4215 S TRYON

TP* 149-032-14
WILLIAM F COOKE &
WF NANCY C
DB 9066 PG 802
351 E PETERSON DR

NOTE:

- 1) TOTAL AREA 201,822.24 SQ FT (4.633 ACRE)
- 2) TEMPORARY CONSTRUCTION EASEMENT 2851.00 SQ FT (0.066 ACRE)
- 3) PERMANENT SIDEWALK & UTILITY EASEMENT 885.05 FT (0.020 ACRE)

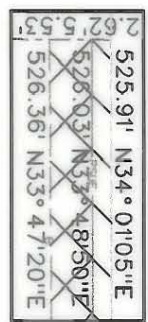

TP* 149-032-01
K & W INDUSTRIES, INC
DB 2488 PG 161
4210 YANCEY RD

TP* 149-032-02
WILLIAM A ALLEN
& WF HAZEL S
DB 5931 PG 792
4150 YANCEY RD

TP* 149-032-10
PEACH E BLACKMAN
DB 4187 PG 403
331 W PETERSON DR

TP* 149-032-13
CHARLOTTE EVANS LANEY
DB 8871 PG 119
342 E PETERSON DR

TP* 149-032-12
ANNIE BELL TAYLOR
& LAURA A
DB 3214 PG 222
343 E PETERSON DR

ACQUISITION BY CITY
RECORDED IN DEED BOOK
12644-977
DATE 9/10/2001

PREPARED BY:
NOVA DIGITAL SYSTEMS, INC.
ENGINEERING DEPARTMENT
600 TOWNE CENTRE BLVD, SUITE 405
CHARLOTTE, NC 28134
704-889-5816

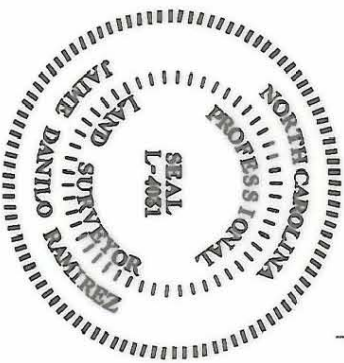

I, J. DANILLO RAMIREZ, CERTIFY THAT THIS PLAT WAS PREPARED UNDER MY SUPERVISION AND THAT THE PLAT WAS PREPARED FOR THE PURPOSE OF ACQUISITION AND EASEMENTS ONLY, AND IS NOT INTENDED TO BE A BOUNDARY SURVEY OF PROPERTY SHOWN.

SIGNED: *J. Danilo Ramirez*
J. DANILLO RAMIREZ
PLS L-4031
DATE: 03/01/01

REVISIONS		JOB NO. 2102	
0	SCALE 1" = 125'	PROPERTY OF	EXECUTIVE BUILDING CO
1	DATE	335 E PETERSON DR	LOT 12
2	DATE	S TRYON STREET	IMPROVEMENT PROJECT
3	DATE	PROJ NUM. 512-97-122	
DRAWN BY		SHEET 1 OF 1	
DATE		SURVEY SUPVA.	

149-032-11