

I, DAVID H. SNIDER, CERTIFY THAT THIS PLAT WAS PREPARED UNDER MY SUPERVISION AND THAT THE PLAT WAS PREPARED FOR THE PURPOSE OF ACQUISITION AND EASEMENTS ONLY, AND IS NOT INTENDED TO BE A BOUNDARY SURVEY OF PROPERTY SHOWN.

DAVID H. SNIDER, NC P.L.S. L-2942 DATE 4/26/01

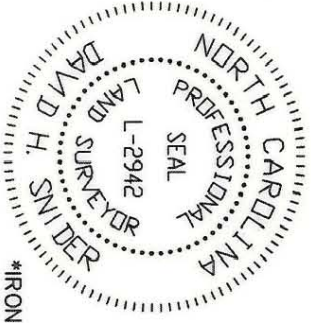

SHEILA SHIREEN ZONOUN
PATRICIA JAMES GLASSGOW
TAX CODE: 157-132-07
DB 6211 PG 850
MAP BOOK 3 PG 634
4330 WALKER RD.

DENNIS A. ROSE
TAX CODE: 157-132-17
DB 9067 PG 529
MAP BOOK 3 PG 634
4338 WALKER RD.

GEORGE LEE BANKS
TAX CODE: 157-132-06
DB 8966 PG 289
MAP BOOK 3 PG 634
WALKER RD.



JESSE G. HELMS JR.
TAX CODE: 157-132-16
DB 2165 PG 144
MAP BOOK 3 PG 634

PREPARED BY:
CITY OF CHARLOTTE
ENGINEERING DEPARTMENT
600 EAST FOURTH STREET
CHARLOTTE, NC 28202
704-336-2291

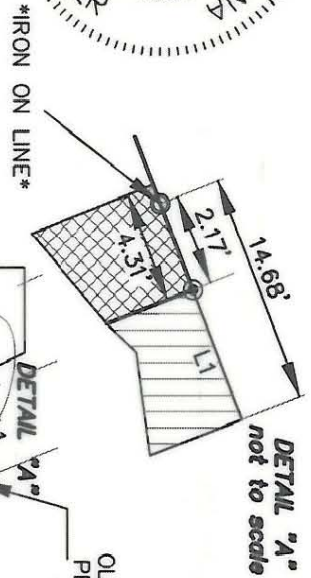

WALKER ROAD
RIGHT-OF-WAY VARIES
ACQUISITION BY CITY
RECORDED IN DEED BOOK
206-1351-40
DATE 03-29-01

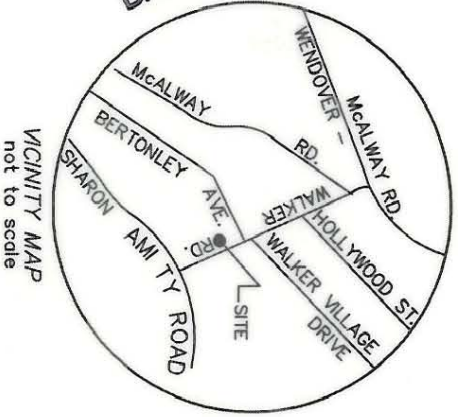

- 1) BEARINGS AND DISTANCES SHOWN IN PARENTHESES ARE BASED ON RECORDED MAP INFORMATION.
- 2) TOTAL AREA 10,008 SQ.FT.
- 3) TEMP. CONSTRUCTION EASEMENT 435 SQ.FT.
- 4) AREA ACQUIRED 620 SQ.FT.
- 5) AREA REMAINING 9,388 SQ.FT.

- LEGEND
- IRON PIN FOUND
 - IRON PIN SET
 - TEMPORARY CONSTRUCTION EASEMENT
 - AREA ACQUIRED
 - LINES SURVEYED
 - LINES NOT SURVEYED

County of Mecklenburg

I, Review Officer of Mecklenburg County, certify that the map or plat to which this certification is affixed meets all statutory requirements for recording.

Review Officer _____ Date _____

LINE	LENGTH	BEARING
L1	12.50	N 68°49'34" E
L2	12.31	N 68°49'34" E
L3	13.56	N 20°22'55" W
L4	10.14	N 88°21'19" W
L5	8.13	N 69°24'26" E
L6	5.61	N 21°14'13" W



CHARLOTTE
ENGINEERING DEPARTMENT

PROPERTY OF
DENNIS A. ROSE

SIDEWALK IMPROVEMENT
WALKER ROAD

PROJECT NO. 512-00-045
CHARLOTTE, MECKLENBURG CO., NC

JOB NO. 512-00-045	FILE NO.
LAN.#200045	
PLAT-19.dwg	
SHEET 1	OF 1

157-132-17