

CURVE TABLE

CURVE	RADIUS	LENGTH	CHORD	BEARING	DELTA
C1	3152.91'	54.30'	54.30'	N 41°04'00" E	00°59'12"

LINE TABLE

LINE	DIRECTION	DISTANCE
L1	S 37°47'57" W	6.66'
L2	N 47°50'34" W	19.52'
L3	S 47°28'53" E	16.72'
L4	N 47°50'34" W	35.30'
L5	N 42°55'51" E	54.50'
L6	S 47°28'53" E	33.53'

42

James A. Blount Jr.
 TAX CODE- 159-051-~~10~~
 DEED- 4701-783
 DEED-
 TOTAL AREA- 6730 sf = 0.155 ac.
 AREA TAKEN- 988 sf = 0.023 ac.
 AREA REMAINING- 5744 sf = 0.132 ac.
 TEMP. CONST. ESM'T.- 1868 sf = 0.043 ac.

MARGIE C. CLONTZ
 D.B. 2359-224

MARGIE C. CLONTZ
 D.B. 1768-085

A PORTION OF
 LOTS 31-33,
 MAYVIEW HILLS
 SUBDIVISION

TEMPORARY
 CONSTRUCTION
 EASEMENT

PROPOSED R/W

EXISTING R/W

EUGENIA E. MILLS
 D.B. 2195-316

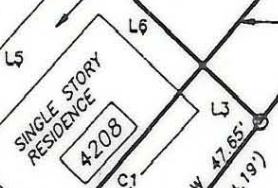

EASTWAY DRIVE
 80' R/W

STATE PLANE GRID NORTH



NOTES:

- 1) Property corners shown as solid circles were located by actual survey.
- 2) Bearings and distances shown in parentheses are based on deed information.
- 3) This map was prepared for the purpose of property acquisition only, and is not intended to be a boundary survey of the total property shown.
- 4) Acquisition and Easement areas shown were calculated using a combination of field survey data, information provided in the legal descriptions, and plats called for in the legal descriptions.
- 5) State Plane Coordinate System is NAD 83.
- 6) All distances shown on this map are horizontal ground distances unless otherwise noted.
- 7) Grid Coordinates for GPS Monument "M-065" - N=529247.48 E=1459413.91

LEGEND:

EXISTING PROPERTY CORNER - ●
 CALCULATED POINT - ○

THIS PLAT WAS PREPARED
 UNDER MY SUPERVISION

C.A. HOLLAND JR.
 NCRLS L-3049

PREPARED BY
C.A. HOLLAND SURVEYORS, INC.

COMPUTER FILENAME: 05110.DWG

BACKUP DISC: ACD-104

PREPARED FOR CHARLOTTE ENGINEERING DEPARTMENT		
REVISIONS	MONROE - EASTWAY - WENDOVER INTERSECTION IMPROVEMENTS	JOB NO. PROJECT PARCEL NO. 42
DRAWN BY: RHM CHECKED BY: CAH	PROPERTY OF JAMES A. BLOUNT, JR. & wife, KAREN D. BLOUNT	SHEET 42
CAH SURVEY SUPVR.	DATE:	OF

159-051-~~10~~ 05