

(N81°-30'-08" W 75.0')

68

ILIOMA & ELIDA GUERRIER
TAX CODE 165-021-40
DEED 4365-310

TOTAL AREA (BY DEED) 11,250 SF
UTILITY EASEMENT 113 SF
AREA REMAINING 11,250 SF

DEED 4763-764

N.C. GRID

67

DOROTHY BARRON
TAX CODE 165-021-39
DEED 2881-400

(N8°-29'-52"E 150.0' TOTAL)

(N8°-29'-52"E 150.0' TOTAL)

69

DOUGLAS & JULIE HICKS
TAX CODE 165-021-41

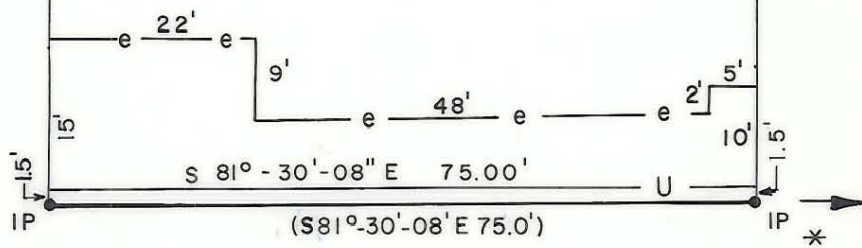

IDLEWILD RD.
60' R/W

* IP 155' Measured Easterly from the East Margin of Flintridge Dr R/W extended along the Southerly Margin of the 60' Idlewild Rd R/W

This map was prepared for the purpose of fee simple, right of way or easement acquisition only, and is not intended to be a boundary survey of the property shown.

NOTE: Bearings and distances shown in parenthesis are based on deed information.

This plat was prepared under my supervision

NC Reg. Surveyor No. L-3015

I. CONSTR. EASEMENT



CHARLOTTE
ENGINEERING DEPARTMENT

REVISIONS	IDLEWILD ROAD WIDENING	JOB NO. 512-85-127
1. 5/16/89		FILE NO.
DRAWN BY FDW	PROPERTY OF ILIOMA & ELIDA GUERRIER	SHEET 68
CHECKED BY JAT		OF
DATE FEB. 1989		SCALE 1"=20'

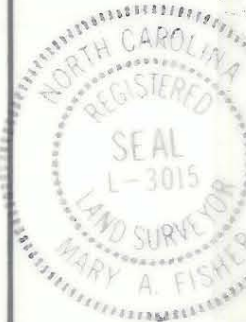

11.5-021-40