

SPRINGBROOK

ROAD

N 81° - 15' - 00" E
266.0' Total

SEE DETAIL

CHASTAIN

S 8° - 45' - 00" E
385.0' Total

AVENUE

SMITH & STEVENSON, PROPS.
DEED REF. 3114-333

Total Area 102,410 Sq. Ft.
Area Taken 39 Sq. Ft.
Area Remaining 102,371 Sq. Ft.

385.0'
N 8° - 45' - 00" W

266.0'
S 81° - 15' - 00" W

NOTE: Property corners shown circled were located by actual survey. Bearings are based on MAP BOOK 3, PAGES 49 & 208

This plat was prepared under my supervision
N.C. Reg. Engineer No. 4343

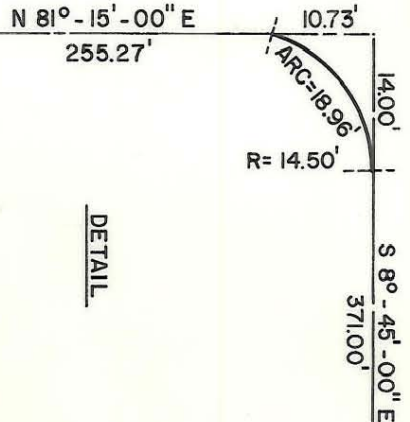

CITY OF CHARLOTTE NORTH CAROLINA DEPARTMENT OF PUBLIC WORKS ENGINEERING DIVISION		JOB NO.
REVISIONS	PROPOSED R/W	FILE NO.
DRAWN BY S.B.C.	SPRINGBROOK ROAD and CHASTAIN AVENUE	810-67
CHECKED BY J.S.S.	PROPERTY OF	SHEET
CITY ENGINEER	SMITH & STEVENSON, PROPS	1 OF 1
DATE NOV. 14, 1973	SCALE 1" = 60'	

169-011-06/07