

NOTES:

1. AREA DETERMINED BY COORDINATE COMPUTATION
2. TRAVERSE ADJUSTED BY THE LEAST SQUARE METHOD OF ADJUSTMENT.
3. THE PROPERTY SHOWN HEREON IS SUBJECT TO ANY RIGHT OF WAY OR EASEMENT OF RECORDED PRIOR TO THE DATE OF THIS SURVEY.
4. DECLARATION IS MADE TO THE ORIGINAL PURCHASER OF THIS SURVEY. IT IS NOT TRANSFERABLE TO ADDITIONAL INSTITUTIONS OR SUBSEQUENT OWNERS.
5. THIS PROPERTY HAS NOT BEEN ABSTRACTED BY THE SURVEYOR. THE EXISTENCE OR NON-EXISTENCE OF RIGHTS OF WAY, EASEMENTS, MINIMUM BUILDING SETBACK LINES, ETC. ARE TO BE VERIFIED BY THE OWNER OR OWNERS AGENT PRIOR TO CONVEYANCE, DESIGN OR CONSTRUCTION.

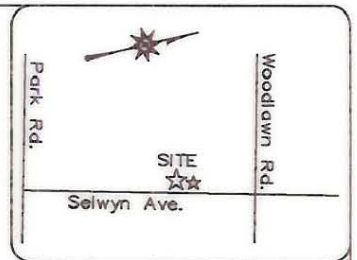
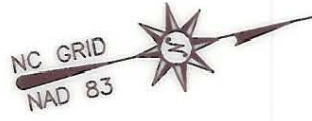

VICINITY MAP not to scale

Parcel ID# 175-096-13

David T. Grady

& wife Kimberly D. Gray

DB 9168 Pg 374

3126 Selwyn Ave.

0.344 Acres

②



ACQUISITION BY CITY
 RECORDED IN DEED BOOK
 15489-650 Judgment
 DATE 06-10-03

TEMPORARY CONSTRUCTION EASEMENT		
LINE	BEARING	DISTANCE
L1	N 14°37'00" E	45.55'
L2	N 01°21'20" W	29.20'
L3	S 80°12'35" E	15.40'
L4	S 09°48'30" W	74.73'
L5	N 77°19'29" W	13.58'
TOTAL AREA OF TCE		893.74 SQ. FT. 0.021 ACRES

PERMANENT SIDEWALK EASEMENT		
LINE	BEARING	DISTANCE
L4	N 09°48'30" E	74.73'
L7	S 80°12'35" E	5.50'
L8	S 09°48'30" W	36.20'
L9	S 12°40'31" W	38.75'
L10	N 77°19'29" W	3.57'
TOTAL AREA OF PSWE		374.15 SQ. FT. 0.009 ACRES

Parcel ID# 175-096-12

Parcel ID# 175-096-14

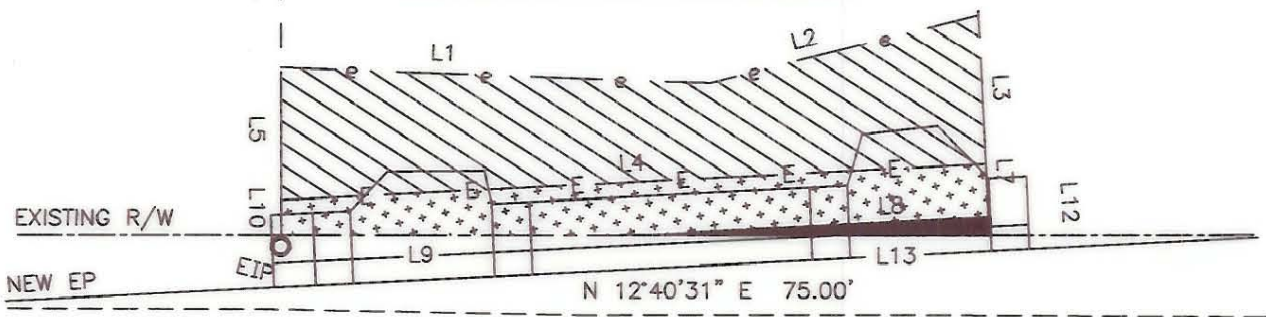

Selwyn Avenue 50' R/W

PROPOSED RIGHT OF WAY		
LINE	BEARING	DISTANCE
L8	N 09°48'30" E	36.20'
L12	S 80°12'35" E	1.81'
L13	S 12°40'31" W	36.25'
TOTAL AREA OF PRW		32.82 SQ. FT. 0.001 ACRES

- PROPOSED RIGHT OF WAY
- PERM. SIDEWALK & UTILITY EASEMENT
- TEMP. CONSTRUCTION EASEMENT
- PROPOSED RIGHT OF WAY
- EXISTING RIGHT OF WAY
- SURVEYED R/W & PROPERTY LINE
- PROPERTY LINE BY DEED
- EXISTING CURB, SIDEWALK, & EP
- EXISTING PROPERTY CORNER

I, Gary Eaton, CERTIFY THAT THIS MAP WAS DRAWN FROM AN ACTUAL SURVEY MADE UNDER MY SUPERVISION; THAT THE RATIO OF PRECISION AS CALCULATED BY LATITUDES AND DEPARTURES EXCEEDS 1:20,000; THE BOUNDARIES NOT SURVEYED ARE SHOWN AS BROKEN LINES PLOTTED FROM INFORMATION FOUND IN ADJOINING DEEDS.

WITNESS MY HAND AND OFFICIAL SEAL
Gary Eaton
 PROFESSIONAL LAND SURVEYOR LICENSE NO. L-3192

I, _____ REVIEW OFFICER OF MECKLENBURG COUNTY CERTIFY THAT THE MAP OR PLAT TO WHICH THIS CERTIFICATION IS AFFIXED MEETS ALL STATUTORY REQUIREMENTS FOR RECORDING.

REVIEW OFFICER _____ DATE _____

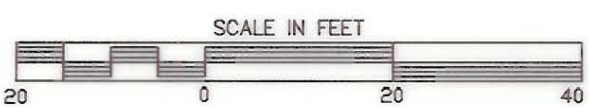

Aero-Dynamics, Corp.
 4801 E. Independence Blvd. Charlotte, NC 28212
 SIDEWALK EASEMENT SURVEY
 PROPERTY OWNER: DAVID T. GRADY & KIMBERLY D. GRAY
CHARLOTTE TWP., MECKLENBURG CO., NC
 ADDRESS 3126 SELWYN AVE.
 TAX ID 175-096-13
 LEGAL REF: DB 9168 - PG 374
 SURVEY FOR: CITY OF CHARLOTTE (PROJ# 512-97-144)
 SCALE 1" = 20' DATE: 11-8-2001
 PROJECT: Y:\02601\Plats\Tract2

175-096-13