

I, DAVID H. SNIDER, CERTIFY THAT THIS PLAT WAS PREPARED UNDER MY SUPERVISION AND THAT THE PLAT WAS PREPARED FOR THE PURPOSE OF EASEMENTS ONLY, AND IS NOT INTENDED TO BE A BOUNDARY SURVEY OF PROPERTY SHOWN.

David H. Snider 8/17/2010
 DAVID H. SNIDER, NC P.L.S. L-2942 DATE

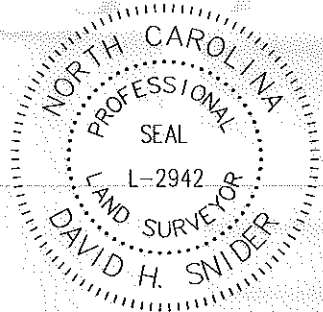

③
 175-134-11
 JACOB A. FRYE
 CATHERINE B. FRYE
 DB 25504-829
 3212 PINEHURST PL.

N81°17'34"W 200.54' TOTAL
 (N81°13'00"W 200.00' TOTAL)

②
 175-134-12
 DAVID E. PRICE
 ALLISON W. PRICE
 DB 15848-396
 3218 PINEHURST PL.

COMBINED GRID FACTOR=0.999843302
 N 521461.67
 E 1448992.02

S81°16'16"E 201.01' TOTAL
 (S81°13'00"E 200.00' TOTAL)

①

1) BEARINGS AND DISTANCES SHOWN IN PARENTHESES ARE BASED ON RECORDED MAP INFORMATION.

- 2) TOTAL AREA 15,051 SQ. FT.
- 3) TEMP CONSTRUCTION EASEMENT 780 SQ. FT.
- 4) SIDEWALK UTILITY EASEMENT 310 SQ. FT.
- 5) AREA REMAINING 15,051 SQ. FT.

LINE	LENGTH	BEARING
L1	5.28	N02°30'55"W
L2	16.88	N08°22'28"E
L3	6.71	N04°32'49"W

LEGEND

IRON PIN FOUND ○

CALCULATED POINT ●

LINES SURVEYED ———

LINES NOT SURVEYED - - - - -

TEMP. CONSTRUCTION EASEMENT [Pattern]

SIDEWALK UTILITY EASEMENT [Pattern]

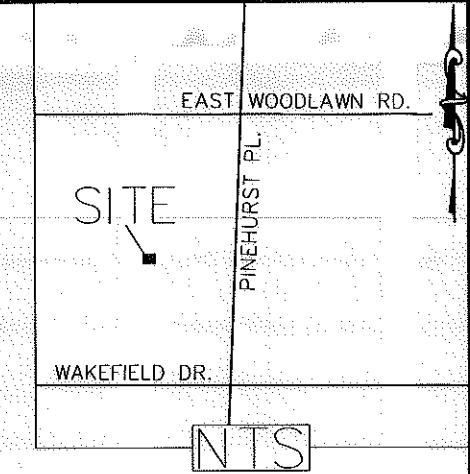

STATE OF NORTH CAROLINA
 COUNTY OF MECKLENBURG

I, _____, REVIEW OFFICER OF MECKLENBURG COUNTY, CERTIFY THAT THE MAP OR PLAT TO WHICH THIS CERTIFICATION IS AFFIXED MEETS ALL STATUTORY REQUIREMENTS FOR RECORDING.

REVIEW OFFICER _____ DATE _____

PREPARED BY:
 CITY OF CHARLOTTE
 ENGINEERING DEPARTMENT
 600 EAST FOURTH STREET
 CHARLOTTE, NC 28202
 704-336-2291



REVISIONS		JOB NO.
		512-10-048
PINEHURST PLACE SIDEWALK		210048
PROPERTY OF DAVID E. PRICE ALLISON W. PRICE		SHEET 1
CHARLOTTE, MECKLENBURG CO., NC		OF 1
DRAWN BY P.S.	CHECKED BY DS	
K:\AutoCad\En_su-LD4\210048 PINEHURST PLACE SW\dwg\PLATS\147-092-04 #2		

