

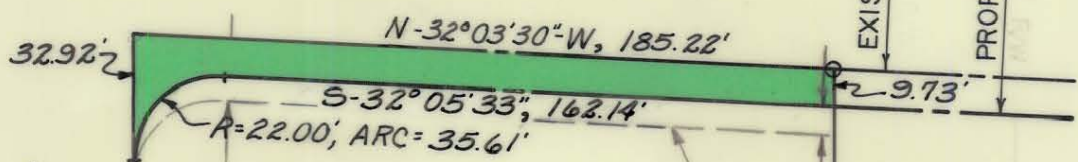

RANDOLPH ROAD



CODDINGTON PLACE

181-032-15
DEED: 3356-257

TOTAL AREA :	42,645.61	SQ. FT. =
	0.979	ACRES
AREA TAKEN :	1,926.49	SQ. FT. =
	0.044	ACRES
AREA REMAINING	40,719.12	SQ. FT. =
	0.935	ACRES



This Plat was prepared under my supervision

Frank H. Giesen
N. C. Reg. Engineer No. 4617

NOTE: Property corners shown circled were located by actual survey. Bearings are based on DEED: 3356 - 257

CITY OF CHARLOTTE NORTH CAROLINA DEPARTMENT OF PUBLIC WORKS ENGINEERING DIVISION		
REVISIONS	PROPOSED R/W RANDOLPH ROAD	JOB NO. 73194
12-13-74	PROJECT NO. 513 - 72 - 213	FILE NO. RW-84
	PARCEL 72	SHEET 72
DRAWN BY C.T.A.		OF
CHECKED BY JSS		119
CITY ENGINEER	DATE 2-5-74	SCALE 1"=50'

181-032-15