

THIS PLAT WAS PREPARED
 UNDER MY SUPERVISION

Paul F. Akers 11/11/00
 PAUL F. AKERS, DATE
 PLS No. L-4144

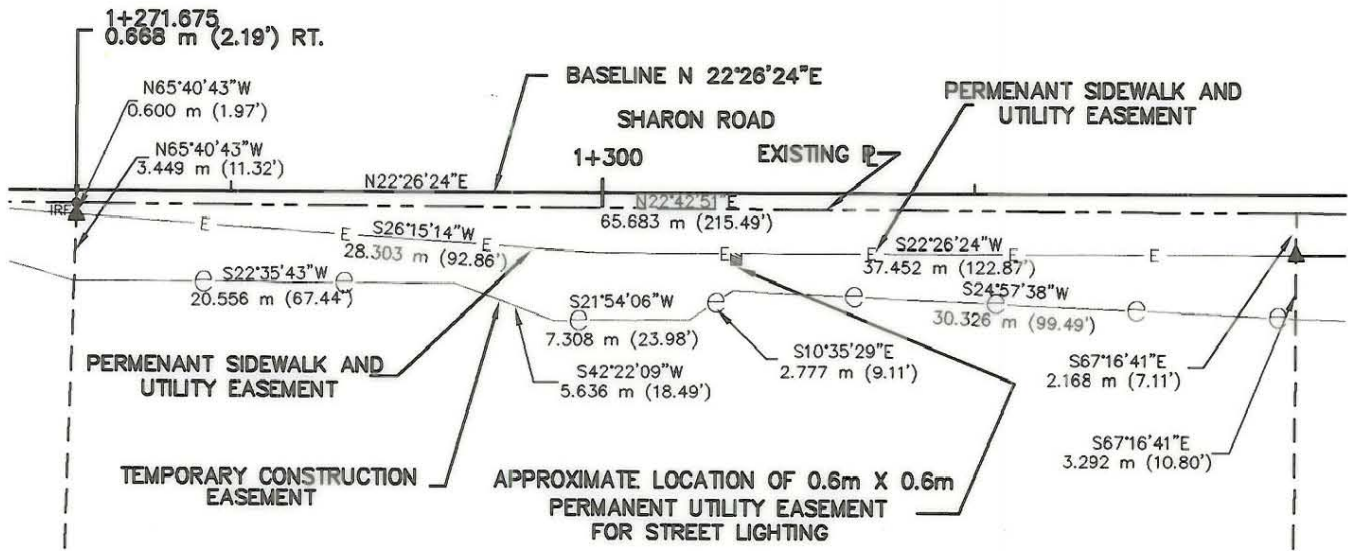

⑤
RBB INVESTMENTS I LTD.
 DB 9374 PG 358
 PARCEL ID# 183-133-20

ACQUISITION BY CITY
RECORDED IN DEED BOOK

LEGEND:

- ▲ CAPPED IRON ROD SET
- ▣ R/W MONUMENT FOUND
- ⊙ PK FOUND
- ⊙ PROPERTY CORNER FOUND
- IRF IRON ROD FOUND

- E—E—E— PERMANENT DRAINAGE EASEMENT
- e—e—e— TEMPORARY CONSTRUCTION EASEMENT

NOTES:

1. THIS MAP WAS PREPARED FOR THE PURPOSE OF ACQUIRING RIGHT-OF-WAY AND/OR AN EASEMENT ONLY; IT IS NOT INTENDED TO BE A BOUNDARY SURVEY OF THE PROPERTY SHOWN.
2. PROPERTY CORNERS SHOWN AS OPEN CIRCLES WERE BY ACTUAL SURVEY. BEARINGS AND DISTANCES IN [BRACKETS] ARE BASED ON DEED INFORMATION.

TOTAL AREA	38,550.60 S.F.	3,581.47 S.M.	0.885 AC.
AREA ACQUIRED	0.00 S.F.	0.00 S.M.	0.000 AC.
AREA REMAINING	38,550.60 S.F.	3,581.47 S.M.	0.885 AC.
AREA OF TEMPORARY CONSTRUCTION EASEMENT	1986.07 S.F.	184.51 S.M.	0.046 AC.
AREA OF PERMANENT SIDEWALK AND UTILITY EASEMENTS	1358.03 S.F.	126.165 S.M.	0.031 AC.

State of North Carolina
 County of Mecklenburg

I, _____ Review Officer of Mecklenburg County, certify that the map or plat to which this certification is affixed meets all statutory requirements for recording.

Review Officer _____ Date _____

CITY PROJECT NO. 512-99-083

		CHARLOTTE ENGINEERING DEPARTMENT	
REVISIONS		SHARON/FAIRVIEW ROAD IMPROVEMENTS	JOB NO. 1225-0003
1. ADDED ENTRY FOR LIGHTING 11/11/00			FILE NO. 1225-0003
DRAWN BY PFA		PROPERTY OF RBB INVESTMENTS I LTD.	SHEET 2
CHECKED BY PFA			OF 2
SURVEY SUPVR. PFA			DATE 03-06-00 SCALE 1:400

183-133-04