

2

185-III-01
HOBART R. WOOD
& WF. JO ANN H.
DEED: 3423-367

Area Taken: 661 Sq. Ft.

BLOCK 2

MAP BOOK 12 PAGE 299

NOTE: Property corners shown circled were located by actual survey. Bearings are based on

MAP BOOK 12 PAGE 299

This map was prepared for the purpose of right of way or easement acquisition only, and is not intended to be a boundary survey of the property shown.

This plat was prepared under my supervision Stephen A. Gilbert
N. C. Reg. Surveyor No. L-1785

SEE DETAIL

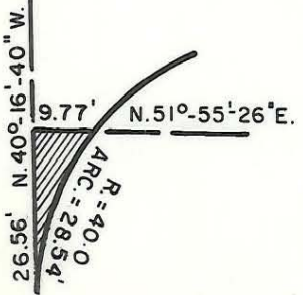

DETAIL

Scale: 1" = 30'
RIGHT-OF-WAY TO REVERT TO PROPERTY OWNER
82. Sq. Ft.



CITY OF CHARLOTTE NORTH CAROLINA DEPARTMENT OF PUBLIC WORKS ENGINEERING DIVISION		
REVISIONS	RIGHT-OF-WAY TO BE ACQUIRED	JOB NO.
	CRESTBROOK DRIVE	FILE NO. RW-142
	PROPERTY OF	SHEET
	HOBART R. WOOD AND WIFE JO ANN H.	2
DRAWN BY M.S.	DATE 7/11/77	SCALE 1" = 40'
CHECKED BY <i>[Signature]</i>		OF
CITY ENGINEER		2