

191-011-08

This map was prepared for the purpose of right of way or easement acquisition only, and is not intended to be a boundary survey of the property shown.

NOTE: Property corners shown circled were located by actual survey. Bearings and distances shown in parenthesis are based on deed information.

191-011-02
J.M. WALLACE LAND CO.
Deed 4548-559

U.S. 74 INDEPENDENCE BLVD.

PRIVATE DRIVE 50' R/W

(N. 34° 24' 00" W.)

EXIST. R/W

O.I.

(LEASE) (LINE) (N.55°-36'-00" E.) 492.64

551.15'

N. 81° 14' 04" E. (LEASE LINE)

191-011-09

236.07'

33.67'

O.I.

N.I.

CONFERENCE DRIVE

DRIVE

EXIST. R/W

CHORD: S. 06° 25' 09" E. 1,004.78'

(R=1,071.76') A=723.71' TOTAL A=1,045.78'

C.A. 871.1' S.F. = 128 AC.

M. 0° 32' 00" W. 355.91'

S. 21° 32' 00" W. 212.84'

A=202.57'

22.17'

O.I.

N.I.

EXIST. R/W

O.I.

N. 21° 45' 36" E. 60.82'

EXIST. R/W

O.I.

N.I.

O.I. 500.00'

S. 33° 25' 44" E. 180.11'

N.I.

A=119.20'

O.I.

6.62'

S. 34° 22' 21" E. 449.78'

11895'

O.I.

449.78'

TOTAL 568.73'

N.I.

PROPR. R/W

N.I.

EXIST. R/W

O.I.

N. 40° 29' 56" E. 4.49'

EXIST. R/W

O.I.

N.I.

N. 21° 33' 00" E. 33.67'

EXIST. R/W

O.I.

N.I.

EXIST. R/W

O.I.

N.I.

EXIST. R/W

O.I.

N.I.

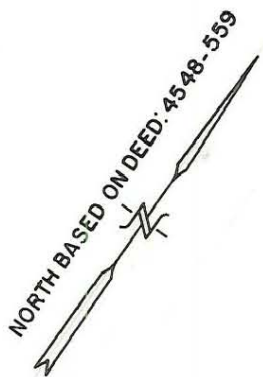

DETAIL NOT TO SCALE

This plat was prepared under my supervision. *R. Dennis Smith*
N.C. Reg. Surveyor No. L-1482.



		CHARLOTTE ENGINEERING DEPARTMENT	
REVISIONS		PORTION OF R/W TO BE ABANDONED CONFERENCE DRIVE	
DRAWN BY <i>M.S.</i>		BY THE CITY OF CHARLOTTE	
CHECKED BY <i>RLB</i>		DATE SEPT. 4, 1987 SCALE 1" = 100'	
<i>R. Dennis Smith</i> Survey Supvr.		JOB NO. 512-37 FILE NO. 124 SHEET 1 OF 1	

191-011-09/02