

53

REA INVESTMENT PARTNERS
DEED: 5434-990
PROP. PERM.
DRAIN, ESMT.

102+59.75
P.T.

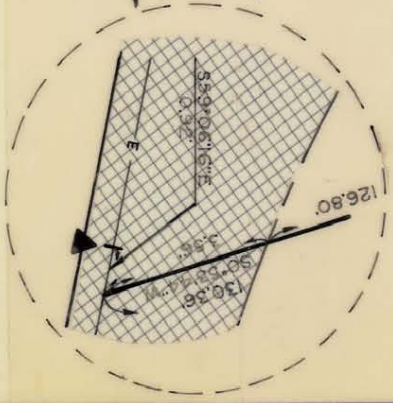

NOTE: Property corners shown circled were located by actual survey. Bearings and distances shown in parenthesis are based on deed information. Bearings are based on

N.C. COORDINATE SYSTEM

PARCEL ID. # 205-121-6, 13, 14, & 15

This map was prepared for the purpose of fee simple right-of-way or easement acquisition only, and is not intended to be a boundary survey of the property shown.

This plat was prepared under my supervision
Kellum B. Bernard
N.C. Reg. Surveyor No. L - 3083

REVISIONS		JOB NO	
DRAWN BY L.I.S.		FILE NO	
CHECKED BY K.B.B.		SHEET 53B/8	
DATE FEB. 1, 1988		OF	
SCALE 1" = 50'		PROPERTY OF REA INVESTMENT PARTNERS	
WESTINGHOUSE BLVD.		ENGINEERING DEPARTMENT	
CHARLOTTE		NORTH CAROLINA	

205-112-25/24AND 205-121-15