

58

WILSON GRIFFIN  
DEED: 1427-405

53

REA INVESTMENT PARTNERS  
DEED: 5434-990

PROP. FERM. DRAIN. ESMT.

8+00

4+00

PROPOSED CRUMP ROAD -Y7-

EXIST R/W

S 58° 53'55" E  
390.01' TOTAL

328.34'

S 23° 45' 03" W  
50.16'

S 26° 36' 15" W  
50.20'

S 26° 02' 07" W  
50.16'

S 24° 53' 42" W  
50.09'

N 21° 25' 31" E  
619.17'

385.25'

S 29° 25' 52" W  
50.49'

S 18° 01' 40" W  
50.09'

S 24° 19' 26" W  
50.06'

S 34° 12' 24" W  
51.25'

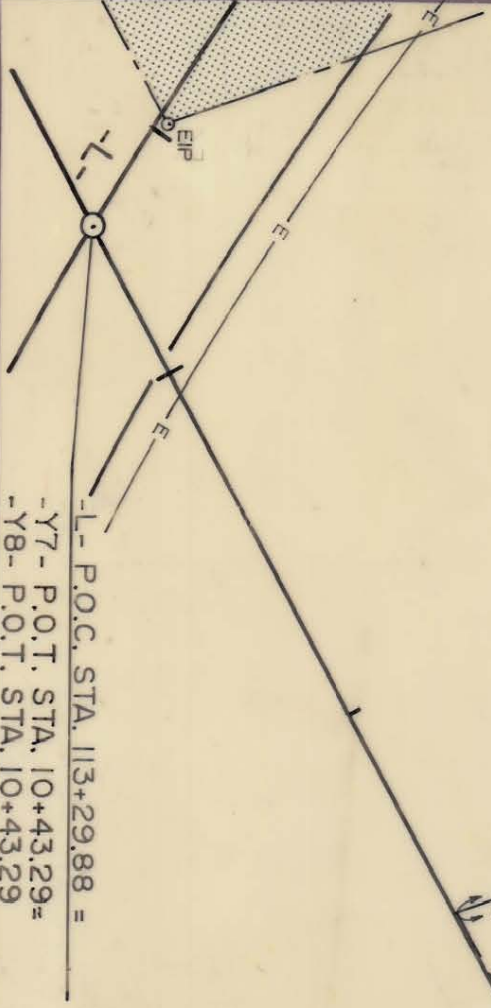

NOTE: Property corners shown circled were located by actual survey. Bearings and distances shown in parenthesis are based on deed information. Bearings are based on

N.C. COORDINATE SYSTEM

This map was prepared for the purpose of fee simple, right-of-way or easement acquisition only, and is not intended to be a boundary survey of the property shown.

This plat was prepared under my supervision  
*Kellum B. Bernhard*  
N.C. Reg. Surveyor No. L-3083

PARCEL ID # 205-121-6, 13, 14, 8, 15

<p>CHARLOTTE ENGINEERING DEPARTMENT</p>		<p>REVISIONS</p>	
<p>WESTINGHOUSE BLVD.</p>		<p>PROPERTY OF REA INVESTMENT PARTNERS</p>	
<p>DRAWN BY L.I.S. CHECKED BY K.B.B. SURVEY SUPERV.</p>	<p>DATE FEB. 1, 1988</p>	<p>JOB NO.</p>	<p>FILE NO.</p>
<p>SCALE 1" = 50'</p>	<p>SHEET 536/18</p>	<p>OF</p>	

205-121-06