

C1	N 30° 37' 36" E	40.16'	ARC	2331.83'
C2	N 32° 31' 57" E	114.96'	RAD	83.3'
C3	N 33° 38' 13" E	2.05'		2331.83'
C4	N 34° 07' 35" E	10.65'		2331.83'

HARRY GRIMMER & COMPANY, INC.
 DB 4792 PG 183
 TM 209-291-01

S 83° 05' 16" E 550.36' TOTAL
 459.42'

S 34° 00' 01" W 0.43'

TEMP. CONST. EASEMENT (TRACT 3)

SARAH BELLE WALLACE
 DB 1114 PG 70
 MB 04 PG 655
 TM 209-291-03

N 30° 44' 42" E 20.74'

PROPOSED PROPERTY LINE

TEMP. CONST. EASEMENT (TRACT 2)

DOWN GUY EASEMENT (TRACT 2)

PERM. DRAIN EASEMENT

AREA TO BE ACQUIRED FEE SIMPLE
 INSIDE EXIST. MAINT. R/W 10489.10 S.F. 0.2408 AC.
 AREA TO BE ACQUIRED FEE SIMPLE
 OUTSIDE EXIST. MAINT. R/W 5965.79 S.F. 0.1370 AC.
 AREA PERM. DRAIN EASEMENT 536.42 S.F. 0.0123 AC.
 AREA TEMP. CONST. EASEMENT 6048.31 S.F. 0.1388 AC.
 AREA DOWN GUY EASEMENT 81.05 S.F. 0.0018 AC.
 RESIDUAL AREA 11787.62 S.F. 2.7040 Ac. (BY DEED)

MARVIN GARNETT KISER, SR. et ux
 DB 4025 PG 435
 TM 209-29106

WILLIAM T. FOGARTY et ux
 DB 5589 PG 671
 TM 209-291-05

N 83° 14' 23" W 434.30' TOTAL
 375.07'

N 30° 08' 00" E 25.00'

L1	N 83° 14' 23" W	5.92'
L2	N 83° 14' 23" W	9.47'
L3	N 83° 14' 23" W	10.89'
L4	N 30° 08' 00" E	124.69'
L5	N 59° 52' 00" W	15.00'
L6	N 59° 52' 00" W	5.00'
L7	N 30° 08' 00" E	2.00'
L8	N 30° 08' 00" E	20.00'
L9	N 59° 52' 00" W	20.00'
L10	N 59° 52' 00" W	40.98'
L11	N 59° 52' 00" W	20.00'
L12	N 37° 58' 12" E	2.05'
L13	N 36° 05' 18" E	20.00'
L14	N 30° 08' 00" E	2.00'
L15	N 30° 08' 00" E	9.12'
L16	N 59° 52' 39" W	30.42'
L17	N 89° 10' 10" W	29.15'
L18	N 37° 12' 22" W	27.05'
L19	N 86° 04' 42" E	33.75'

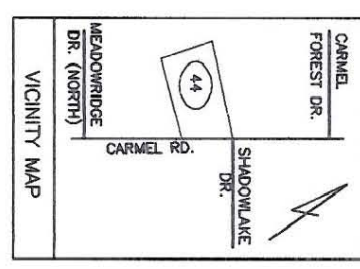

PREPARED BY:
 TGS Engineers
 1215 Jones Franklin Road
 Suite 203, North Building
 Raleigh, North Carolina 27606
 Phone (919)851-7144

(1) This plat was prepared under my supervision.
Leonard G. Fletcher
 Date: *5-8-95*

N.C. Registered Survey No. *L-2974*

(2) This map was prepared for the purpose of acquiring fee simple right-of-way and/or an easement only and is not intended to be a boundary survey of property shown.

		CHARLOTTE ENGINEERING DEPARTMENT	
REVISIONS DEC 10, 1993 MARCH 2, 1994 MAY 12, 1994		CARMEL ROAD WIDENING PROJECT	
DRAWN BY ELW CHECKED BY WEW		PROPERTY OF SARAH BELLE WALLACE	
DATE JULY 2, 1993		JOB NO. 512-88-123 FILE NO.	
SCALE 1"=80'		SHEET 44 OF 137	

209-291-03