

ROBERT N. GRIER et ux
TM 211-372-01

JAMES P. DeMARE et ux
TM 211-163-17
DB 6445 PG 740
LOT 16, BLOCK 16, MONTIBELLO
MB 22 PG 619
TOTAL AREA 5261.99 S.F. 0.5454 Ac. (BY DEED)
AREA FEE SIMPLE 23757.39 S.F. 0.1208 Ac.
AREA TEMP. CONST. EASEMENT 2880.79 S.F. 0.0661 Ac.
AREA DOWN GUY EASEMENT 40.28 S.F. 0.0009 Ac.
RESIDUAL AREA 18495.40 S.F. 0.4246 Ac.

ROBERT W. HYER et ux
TM 211-163-16
DB 6491 PG 190

PREPARED BY:
TGS Engineers
Suite 205, North Building
Raleigh, North Carolina 27606
Phone (919)851-7144



(1) This plat was prepared under my supervision.
L.H. Parnell
Date: 5-8-95
N.C. Registered Land Surveyor No. 6-29274

CHD	BEAR	CHD	ARC	RAD
C1	N 68° 55' 16" E	36.69'	41.20'	25.00'
C2	N 69° 45' 37" E	58.00'	64.89'	40.00'
L1	S 72° 36' 05" E	10.21'		
L2	S 72° 36' 05" E	10.03'		
L3	N 17° 23' 55" E	2.00'		
L4	N 72° 36' 05" W	9.87'		
L5	N 72° 36' 05" W	10.17'		

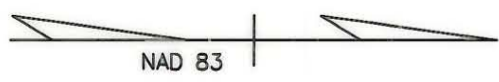
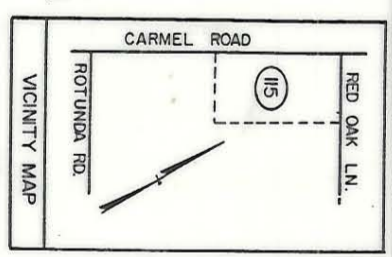

<p>CHARLOTTE ENGINEERING DEPARTMENT</p>		<p>JOB NO. 512-88-</p>
<p>CARMEL ROAD WIDENING PROJECT</p>		<p>FILE NO. 123</p>
<p>PROPERTY OF JAMES P. DEMARE, et ux</p>		<p>SHEET 115 OF 137</p>
<p>REVISIONS</p> <p>NOV 4, 1993 JUL 15, 1994</p>	<p>DRAWN BY: EFW CHECKED BY: WFW</p>	<p>DATE: MAY 20, 1993 SCALE: 1" = 40'</p>

(2) This map was prepared for the purpose of acquiring fee simple, right-of-way and/or an easement only and is not intended to be a boundary survey of property shown.

211-163-17