

H. RAY BURLESON et ux
 DB 3404 PG 509
 TM 211-173-01
 49710.93 S.F. 1.1412 Ac. (BY DEED)
 AREA FEE SIMPLE 2747.00 S.F. 0.0631 Ac.
 AREA TEMP. CONST. EASEMENT 3792.93 S.F. 0.0871 Ac.
 RESIDUAL AREA 46963.93 S.F. 1.0781 Ac. (BY DEED)

EDWARD J. DUFFY et ux
 DB 5311 PG 683
 TM 211-173-14

GEORGE YUNDT III et ux
 TM 211-173-06

PAUL THOMPSON et ux
 TM 211-173-04

C1	N 51° 34' 08" E	20.00'
C2	S 83° 26' 23" E	10.35'
C3	S 67° 45' 01" E	14.71'
C4	S 65° 32' 39" E	14.16'

CHORD DIST.	20.94'	20.00'
	10.47'	20.00'
	14.71'	374.94'
	14.16'	374.94'

(1) This plot was prepared under my supervision.
Donald S. Yelton Date: 5-8-95

(2) This map was prepared for the purpose of acquiring fee simple, right-of-way and/or an easement only and is not intended to be a boundary survey of property shown.

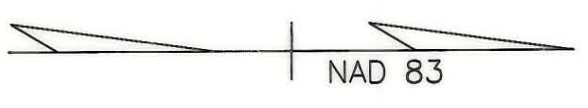
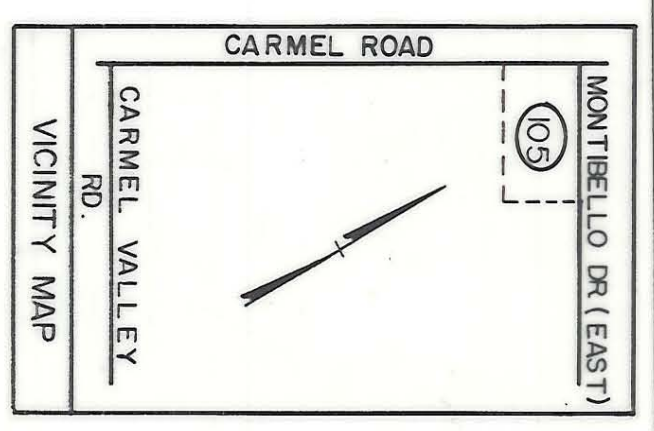

CHARLOTTE ENGINEERING DEPARTMENT	
CARMEL ROAD WIDENING PROJECT	
PROPERTY OF H. RAY BURLESON et ux.	
REVISIONS	JOB NO. 512-88-
DRAWN BY ELW	FILE NO. 123
CHECKED BY WFW	SHEET 105
DATE MARCH 19, 1993	OF 137

211-173-01