

COLIN M. WESTMORELAND et ux  
 DB 5203 PG 138  
 TM 211-173-16

GARY H. WATTS et ux  
 DB 6511 PG 388/390  
 TM 211-173-15  
 45868.72 S.F. 1.0530 Ac. (BY DEED)  
 AREA FEE SIMPLE  
 AREA TEMP. CONST. EASEMENT 2664.65 S.F. 0.0612 Ac.  
 RESIDUAL AREA 43204.07 S.F. 0.9918 Ac. (BY DEED)

ROBERT C. BELL et ux  
 DB 3894 PG 134  
 TM 211-173-17

DENNIS HARRIS  
 TM 211-173-09

ERNEST WESTBROOK  
 TM 211-173-10

PREPARED BY:  
 TGS ENGINEERS  
 1000 South Tryon Street  
 Raleigh, North Carolina 27606  
 Phone (919)851-7144



(1) This plat was prepared under my supervision.  
 Leonard G. Fletcher Date: 5-8-95  
 L-2974

N.C. Registered Land Surveyor No. L-2974  
 (2) This map was prepared for the purpose of acquiring fee simple, right-of-way and/or an easement only and is not intended to be a boundary survey of property shown.

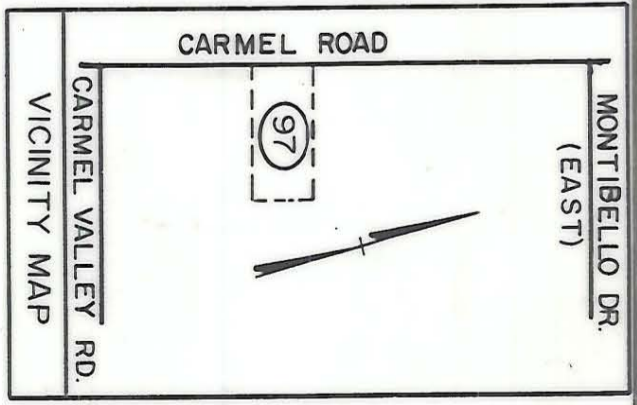

<p>CHARLOTTE ENGINEERING DEPARTMENT</p>		JOB NO. 512-88-123
<p>CARMEL ROAD WIDENING PROJECT</p>		FILE NO.
<p>PROPERTY OF GARY H. WATTS, et. ux.</p>		SHEET OF 97 OF 137
<p>REVISIONS</p>	<p>DRAWN BY ELW                  CHECKED BY MEW</p>	DATE MARCH 17, 1993
<p>CITY ENGINEER</p>		SCALE 1" = 50'

211-173-15