

RICHARD E. GRAHAM et ux  
DB 2897 PG 157  
TM 211-183-07

DONALD L. GREASON et ux  
DB 2725 PG 425  
TM 211-183-06  
LOT 22, CARMEL VISTA  
MB 7 PG 23

WILLIAM R. LEDFORD et ux  
DB 2175 PG 196  
TM 211-183-05

TOTAL AREA 36478.80 S.F. 0.8374 Ac. (BY DEED)  
AREA PERMANENT DRAINAGE EASEMENT 463.37 S.F. 0.0106 Ac.

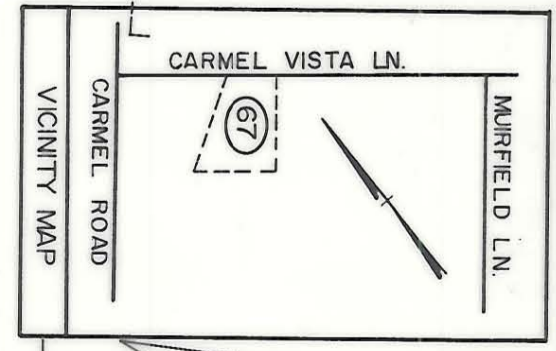
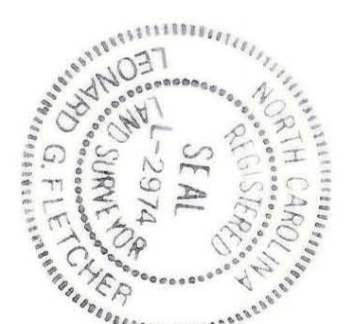

NAD 83

(1) This plat was prepared under my supervision.  
*Leonard G. Fletcher* Date: 5-8-95

N.C. Registered Land Surveyor No. 6-2972X

(2) This map was prepared for the purpose of acquiring fee simple, right-of-way and/or an easement only and is not intended to be a boundary survey of property shown.

PREPARED BY:  
TGS Engineering  
Suite 203  
Raleigh, North Carolina 27606  
Phone (919)851-7144

		REVISIONS	JOB NO.
		DRAWN BY ELW CHECKED BY MFW	512-88-123
PROPERTY OF DONALD L. GREASON et ux		DATE MAY 27, 1993	SCALE 1" = 50'
SHEET 67 OF 137		FILE NO.	

211-183-06