

L1	N 39° 16' 37" E	62.11'
L2	N 38° 16' 10" E	99.06'
L3	N 32° 21' 58" E	99.89'
L4	N 28° 55' 32" E	19.91'

(48)
 CORPORATION OF THE PRESIDING BISHOP OF THE CHURCH
 OF JESUS CHRIST OF LATTER DAY SAINTS
 DB 3735 PG 366
 TM 211-338-02

PREPARED BY:
 TGS Engineers
 Suite 203, North Building
 Raleigh, North Carolina 27606
 Phone (919)851-7144

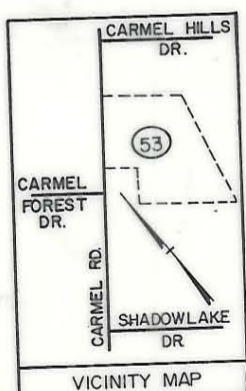

(1) This plat was prepared under my supervision.
Leonard G. Fletcher, Date: *5-8-93*
 N.C. Registered Land Surveyor No. *6-2974*

(2) This map was prepared for the purpose of acquiring fee simple, right-of-way and/or an easement only and is not intended to be a boundary survey of property shown.

		CHARLOTTE ENGINEERING DEPARTMENT
REVISIONS SEPT 22, 1993 NOV 9, 1993	CARMEL ROAD WIDENING PROJECT	JOB NO. 512-98-123 FILE NO.
DRAWN BY <i>ELW</i> CHECKED BY <i>WEW</i> CITY ENGINEER	PROPERTY OF A.J. BLANCHARD, JR. and wife MELVENE S. BLANCHARD	SHEET 53A/2 OF 137
DATE JULY 28, 1993 SCALE 1"=100'		