

225  
 MCINTOSH, ROBERT HENRY  
 & MARGARET R. MOORE  
 DEED: 2240-109

226  
 JACKSON, ELBERT HERMAN  
 & WIFE BETTY  
 DEED: 1913-22

REGINALD INC.  
 DEED: 4754-903

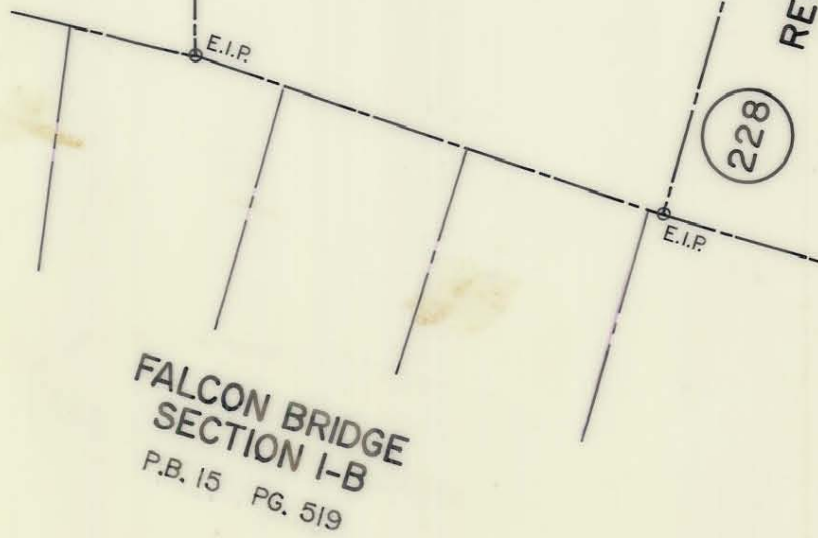

NOTE: Property corners shown circled were located by actual survey. Bearings and distances shown in parenthesis are based on deed information. Bearings are based on

N.C. COORDINATE SYSTEM

PARCEL AREA = 91,919.671 SQ. FT. 2.11 AC.

This map was prepared for the purpose of right-of-way or easement acquisition only, and is not intended to be a boundary survey of the property shown.

This plat was prepared under my supervision Allen E. Beck  
 6-02-87  
 N.C. Reg. Surveyor No. L-3028

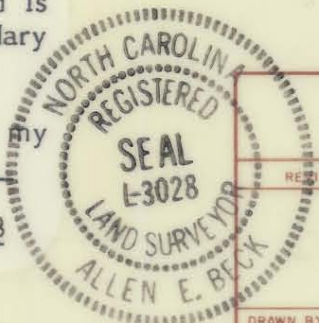

PARCEL ID. # 221-221-71

		<b>CHARLOTTE</b> ENGINEERING DEPARTMENT	
REVISIONS	PROPOSED R/W	JOB NO.	
	<b>NC-51 PHASE II</b>	FILE NO.	
	PROPERTY OF	SHEET	
	<b>ELBERT HERMAN JACKSON &amp; WIFE BETTY</b>	226A/2	
DRAWN BY M.D.M.		OF	
CHECKED BY A.B.		75	
<i>R. Dennis Smith</i> SURVEY SUPVR.	DATE 3/5/87	SCALE 1" = 100'	