

This map was prepared for the purpose of right of way or easement acquisition only, and is not intended to be a boundary survey of the property shown.

26

30

(N. 62° 40' - 10" W.)
(TOTAL 30.00')

12.81' (S. 06° 49' 54" E. 12.03')
17.19'

NOTE: Property corners shown circled were located by actual survey. Bearings and distances shown in parenthesis are based on deed information.

NORTH PER M.B. 19 PG. 212

27

29

Tax Code
221-361-28

P.A. JORDAN
DEED: 4754-778
M.B. 19 PG. 212
LOT 42

PERM. DRAINAGE ESM'T.
1,943 S.F. = 0.045 AC.

(S. 55° 29' - 00" W.)
(161.48')

(N. 16° - 36' - 40" E.)
169.90'

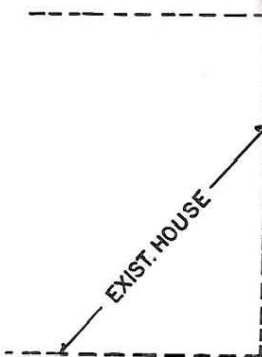

TOTAL AREA 13,316 S.F. = 0.306 AC. (BY DEED)
LESS ESM'T. 1,943 S.F. = 0.045 AC.
REMAINING AREA 11,373 S.F. = 0.261 AC.

(A. = 1700')
(R. = 200.23')

111.69'
(S. 53° 00' - 00" E. TOTAL 122.92')

11.23'

PIN OAK CT.

ACQUIRED MAY 15, 1987

DEED REF. 5505-642

ACQUIRED 5/20/87

D.P. 5505-642

This plat was prepared under my supervision R. Dennis Smith
N. C. Reg. Surveyor No. L-1482



 CHARLOTTE ENGINEERING DEPARTMENT		JOB NO.
PERM. DRAINAGE ESM'T. TO BE ACQUIRED BY THE CITY OF CHARLOTTE		FILE NO.
PROPERTY OF PATRICK ALLEN JORDAN		SHEET 4
REVISIONS	DRAWN BY M.S. CHECKED BY <u>TEM</u> <u>R. Dennis Smith</u> Survey Supvr.	OF 5
DATE NOV. 18, 1986		SCALE 1" = 20'