

LEGEND

TCE = TEMPORARY CONSTRUCTION EASEMENT
 SUE = SIDEWALK AND UTILITY EASEMENT
 MIE = MONOLITHIC ISLAND EASEMENT

- = TCE
- = MIE
- = SUE
- = IRON PIN FOUND
- = TCE
- = EXISTING R/W
- = SUE
- = IRON PIN FOUND

TAX #22360C99
 TAX #22360399
 THE VILLAGE OF TROON
 HOMEOWNERS ASSOCIATION, INC.
 DB 8485 / PG 767
 DB 8485 / PG 776
 DB 8807 / PG 591
 DB 21544 / PG 238
 DB 8874 / PG 233
 DB 8932 / PG 139
 DB 9150 / PG 485
 DB 9048 / PG 269
 DB 9257 / PG 428
 DB 9320 / PG 58
 DB 25537 / PG 736
 UNIT OWNERSHIP FILE NO. 414

TAX # 22360321
 DDR SOUTHEAST CAMFIELD, LLC
 FKA: INLAND SOUTHEAST CAMFIELD, LLC
 DB 15869 / PG 628
 MB 36 / PG 375
 11400 ELM LANE

TAX # 22360298
 DDR SOUTHEAST CAMFIELD, LLC
 FKA: INLAND SOUTHEAST CAMFIELD, LLC
 D.B. 15869 / PG 628
 MB. 26, PG. 13
 MB. 36, PG. 375
 8634 CAMFIELD STREET

I, CHARLES J. DUNBAR, CERTIFY THAT THIS PLAT WAS PREPARED UNDER MY SUPERVISION AND THAT THIS PLAT WAS PREPARED FOR THE PURPOSE OF EASEMENTS ONLY, AND IS NOT INTENDED TO BE A BOUNDARY SURVEY OF PROPERTY SHOWN.

CHARLES J. DUNBAR NC PLS L-4159
 DUNBAR GEOMATICS GROUP, PLLC
 P.O. BOX 3035
 HUNTERVILLE, NC 28070-3035
 NC LIC. NO. P-0865

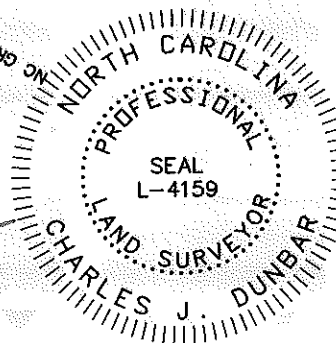

REVIEW OFFICER OF MECKLENBURG COUNTY, CERTIFY THAT THE MAP OR PLAT TO WHICH THIS CERTIFICATION IS AFFIXED MEETS ALL STATUTORY REQUIREMENTS OF NORTH CAROLINA GENERAL STATUTES FOR RECORDING.

REVIEW OFFICER
 (S 25°32'35" E 214.95")
 (S 24°09'24" E 214.95" TOTAL)
 158.56'

DATE
 (TIE)
 (S 23°53'26" E 25.54')
 (S 44°58'62" E 40.27' RT.)

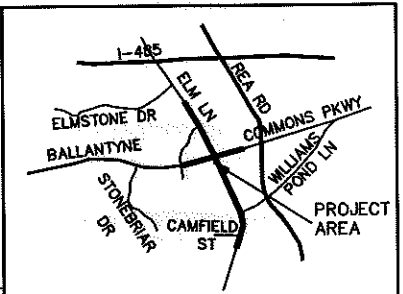

VICINITY MAP NOT TO SCALE

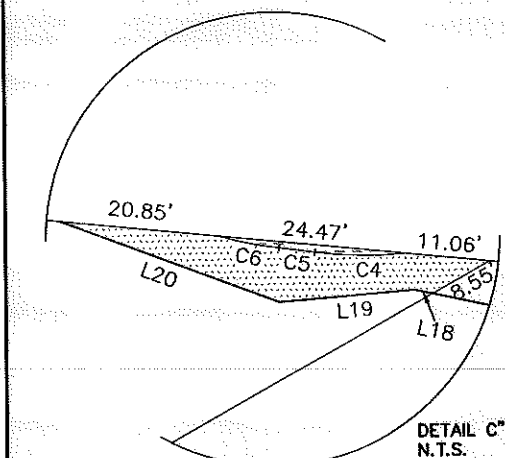

- NOTE:
- 1) BEARINGS AND DISTANCES SHOWN IN PARENTHESES ARE BASED ON RECORDED MAP OR DEED INFORMATION.
 - 2) TOTAL AREA: 67,463 S.F., 1.549 AC.
 - 3) AREA IN TCE: 4,951 S.F., 0.114 AC.
 - 4) AREA IN SUE: 334 S.F., .008 AC.
 - 5) AREA IN MIE: 636 S.F., 0.015 AC.
 - 6) FEE AREA REMAINING: 67,463 S.F., 1.549 AC.

ATKINS
 Plans Prepared By:
 5200 77 CENTER DRIVE, SUITE 500
 CHARLOTTE, NORTH CAROLINA 28217
 (704) 522-7275 NCCOA: F-0326

ELM LANE (SR 3626)
 PUBLIC R/W VARIABLE WIDTH

(N 64°25'47" E 307.19')
 (S 65°44'54" W 307.19' TOTAL)

(S 59°05'17" E 535.67' TOTAL)
 (N 60°28'59" W 254.71')

TAX # 22328431
 DDR SOUTHEAST CAMFIELD, LLC
 FKA: INLAND SOUTHEAST CAMFIELD, LLC
 DB 15869 / PG 628
 MB 26, PG 13
 8610 CAMFIELD STREET
 8624 CAMFIELD STREET

DETAIL "B"
 1" = 30'

DETAIL "A"
 1" = 30'

CURVE	RADIUS	ARC	CHORD BRG	CHORD
C1	52.00'	6.60'	N 20°39'44" W	6.60'
C2	32.00'	2.86'	S 43°31'47" E	2.86'
C3	42.00'	15.97'	N 35°11'33" W	15.88'
C4	52.00'	11.94'	N 28°45'43" W	11.91'
C5	468.00'	4.59'	S 22°27'56" E	4.59'
C6	52.00'	8.06'	N 18°18'18" W	8.05'

LINE	BEARING	DISTANCE
L1	S 65°42'06" W	19.95'
L2	S 24°17'54" E	32.00'
L3	N 65°42'06" E	19.79'
L4	S 45°08'44" W	51.26'
L5	S 24°17'54" E	56.00'
L6	N 78°02'41" W	18.60'
L7	S 31°41'04" E	54.45'
L8	S 34°25'23" E	28.44'
L9	N 65°42'06" E	7.37'
L10	N 65°44'54" E	15.61'
L11	N 65°44'54" E	4.41'
L12	S 65°42'06" W	5.01'
L13	N 24°17'54" W	27.57'
L14	S 65°42'06" W	4.13'
L15	S 24°17'54" E	20.43'
L16	N 17°01'33" W	2.85'
L17	N 16°10'06" W	1.23'
L18	S 17°41'27" E	2.39'
L19	S 34°37'16" E	17.71'
L20	S 09°18'54" E	30.62'
L21	N 69°10'11" E	33.06'

10003.08v03_PARCEL 12

CHARLOTTE ENGINEERING DEPARTMENT

REVISIONS 11/25/11: CHANGED FEE TO MIE 3/8/12: UPDATED EASE.	BALLANTYNE COMMONS PKWY / ELM LANE INTERSECTION IMPROVEMENTS	JOB NO. 512-08-011
SCALE 1" = 60'	PROPERTY ACQUISITION OWNER: DDR SOUTHEAST CAMFIELD, LLC FKA: INLAND SOUTHEAST CAMFIELD, LLC CHARLOTTE, MECKLENBURG CO., NC	FILE NO. PARCEL 12
DRAWN BY: SLB	CHECKED BY: CJD	SHEET 1 OF 1
DATE: 7/28/11	SURVEY SUPVR.: RGG	

ACQUISITION BY DB 29049 PG 333