

NOTE: Property corners shown circled were located by actual survey. Bearings and distances shown in parenthesis are based on deed information. Bearings are based on

N.C. COORDINATE SYSTEM

This map was prepared for the purpose of right-of-way easement acquisition only, and is not intended to be a boundary survey of the property shown.

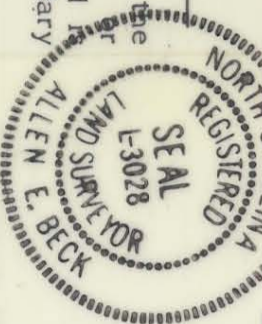

This plat was prepared under my supervision Allen E. Beck  
 5-04-87  
 N.C. Reg. Surveyor No. L-3028

RIGHT-OF-WAY ACQUIRED 4/6/88  
 DB 5734-847

SEE SHEET 1 OF 5 FOR ESMT. TAKE AREAS

PERM. DRAIN. ESMT. = 321,585 SQ. FT. 0007 AC.  
 TEMP. CONT. ESMT. = 215,450 SQ. FT. 0495 AC.  
 PERM. DOWN GUY ESMT. = 80,001 SQ. FT. 0002 AC.  
 PROP. PERM. UTIL. & S/W ESMT. = 4,432,525 SQ. FT. 0102 AC. (INCL. SHT. 2 OF 5)

<p><b>CHARLOTTE</b> ENGINEERING DEPARTMENT</p>	
<p>PROPOSED R/W <b>NC 51/NC 16</b> INTERSECTION</p>	<p>PROPERTY OF <b>CROW CHARLOTTE RETAIL 2</b> LTD % TRAMMEL CROW CO.</p>
<p>DATE 05-04-87 SCALE 1" = 100'</p>	<p>SHEET 3 OF 5</p>
<p>DRAWN BY A.A.SADAT CHECKED BY AL BECK SURVEY SUPVR. <i>R. Dennis</i></p>	<p>JOB NO. FILE NO.</p>