



\* 0 0 B R E A K 0 0 \*



**ADVANCED  
IMAGING  
SYSTEMS**

www.aisimc.com

An Information  
Management Company

# City of Charlotte – Planning Dept. Scanning Rezoning Files

Petition # \_\_\_\_\_

## Document type:

- Applications
- Correspondence
- Department Comments
- Land Use Consistency
  - Mail Info
  - Mapping
  - Other
- Site Plans



\* 0 0 B R E A K 0 0 \*

DOCKET ITEM NO. \_\_\_\_\_

3/4 RULE INVOKED: YES \_\_\_\_\_ NO \_\_\_\_\_



**CHARLOTTE-MECKLENBURG PLANNING COMMISSION**  
**CITY HALL ANNEX**  
600 EAST TRADE STREET  
CHARLOTTE, NORTH CAROLINA

WILLIAM E. McINTYRE  
Planning Director

PETITIONER George Barrett and PETITION NO. 68-27

Fred Hoaner, et. al. HEARING DATE 3/18/68

ZONING CLASSIFICATION, PRESENT R-9 & R-9MF REQUESTED R-12

LOCATION East of Sharon Amity, north of Central Avenue

ZONING MAP NO. 21

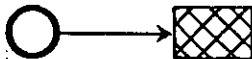

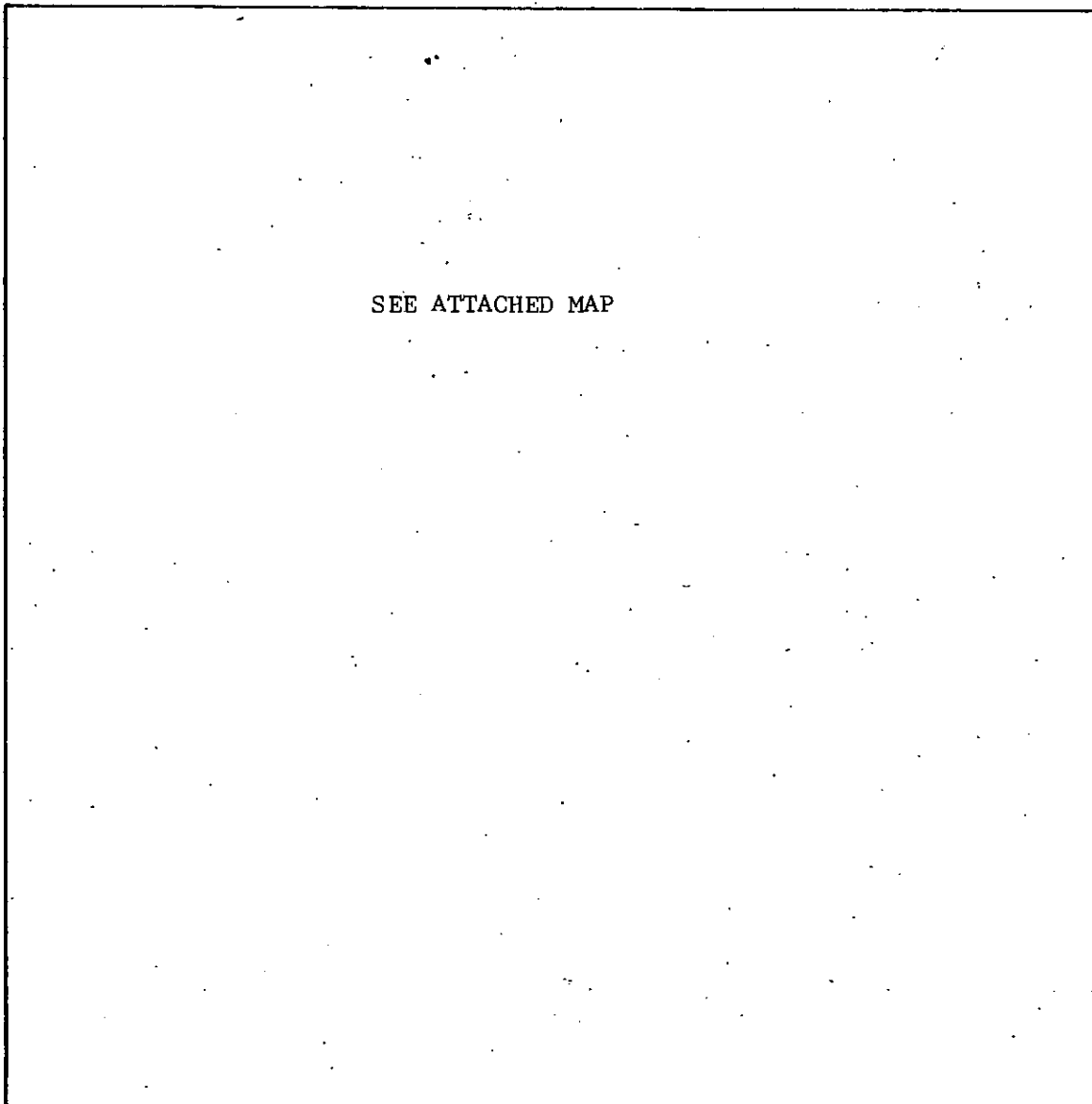

INDICATES PROPERTY PROPOSED FOR CHANGE SCALE 1" = 800'



SEE ATTACHED MAP

RECOMMENDATION ON PETITION NO. 68-27

-  Recommend approval for R-12
-  Recommend remain R-9NF

Map Book  
184, pgs  
205

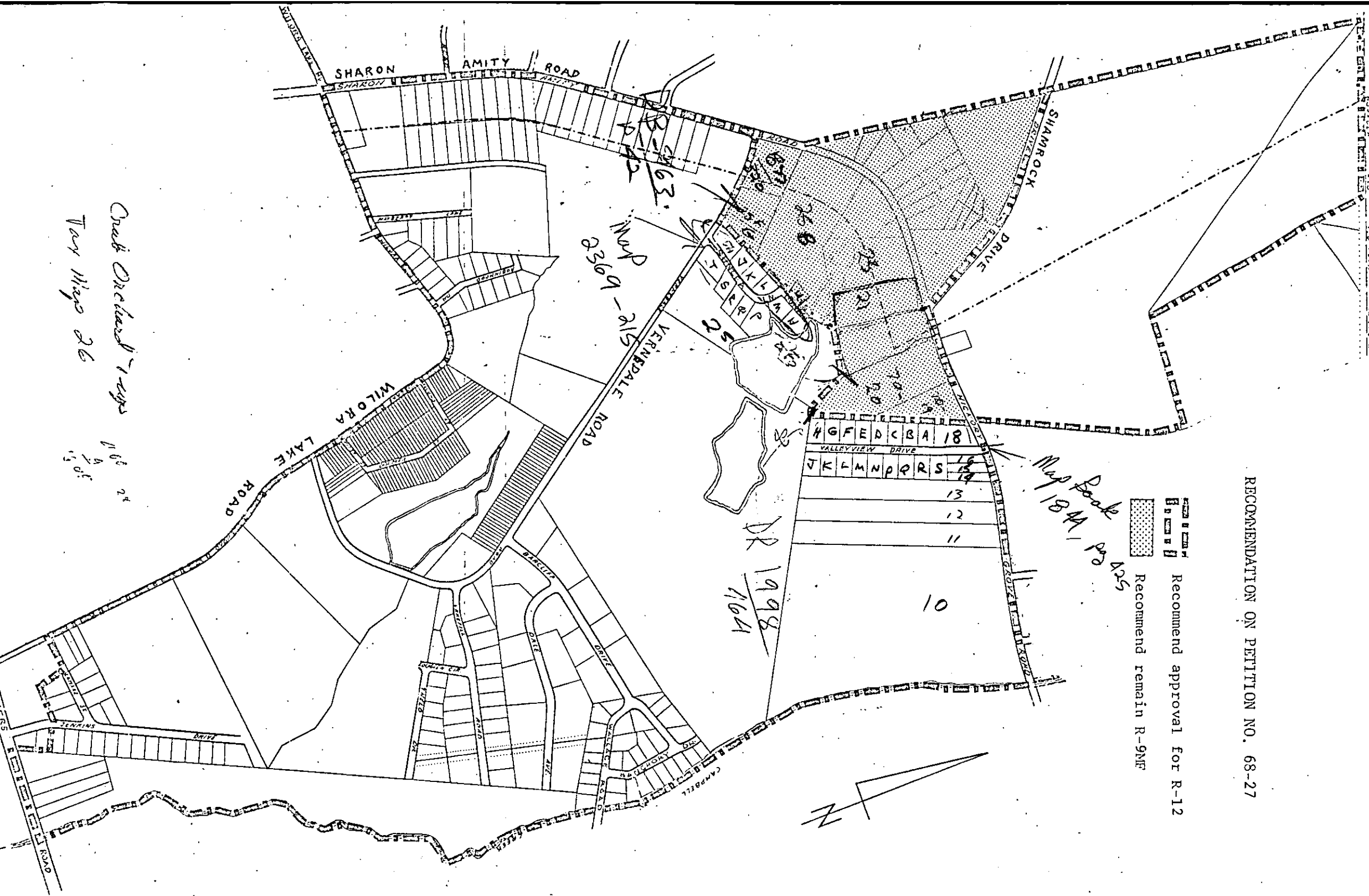
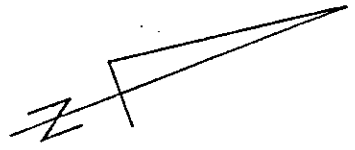

Crab Orchard 1-ways  
Town Map 26

168  
A  
150'