

SITE PLAN 1"=40'-0"
9.024 ACRES

SET NO.	BIDS DUE
WHEATLEY WHISNANT ASSOCIATES ARCHITECTS <small>CHARLOTTE, N.C. 28202</small>	
PROPOSED SHOPPING CENTER INTERSECTION OF PROVIDENCE ROAD & OLD PROVIDENCE ROAD NORTH CAROLINA CHARLOTTE	
11/9/71	11/11
REVISIONS	CHECKED BY
DATE	11/11
SHEET NO.	DRAWN BY
2	11/11
JOB NO.	

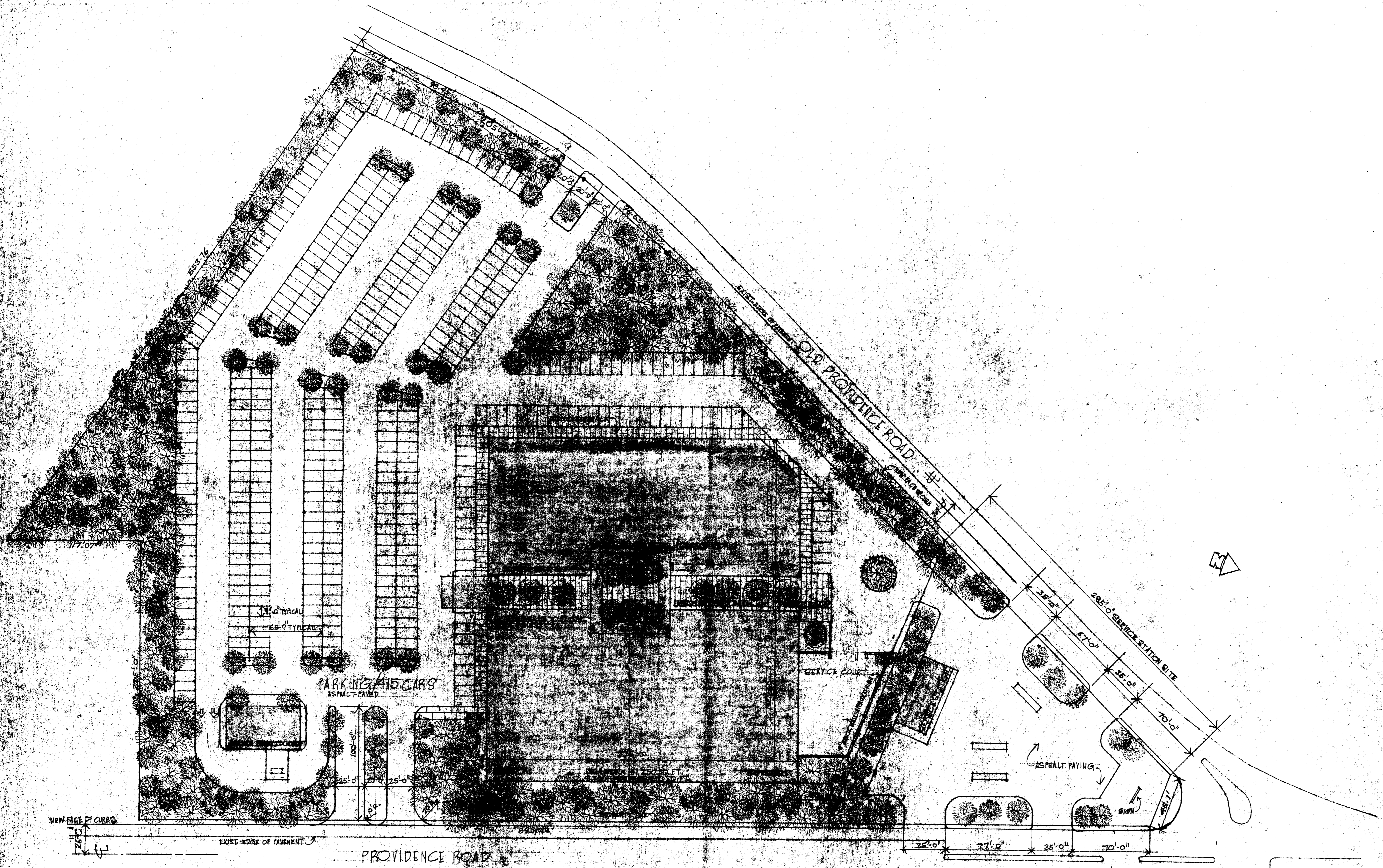

SITE PLAN 1"=40'-0"
9.024 ACRES

SET NO.	BIDS DUE
WHEATLEY WHISNANT ASSOCIATES ARCHITECTS CHARLOTTE, N.C.	
PROPOSED SHOPPING CENTER IN INTERSECTION OF PROVIDENCE ROAD & OLD PROVIDENCE ROAD CHARLOTTE, NORTH CAROLINA	
11/9/71	REVISIONS
DATE	DRAWN BY
	CHECKED BY
SHEET NO.	JOB NO.
2	