

REVISIONS:  
DATE: 5-5-76  
DRAWN BY: L.M.R.  
CHECKED BY: C.E.H.

FRANK B. HICKS ASSOCIATES, INC.  
ENGINEERS... SURVEYORS... PLANNERS  
4560 OLD PINEVILLE RD. CHARLOTTE, N. C. 28210

SCHEMATIC  
PLAN

CHILD ACRE DAY CARE CENTER  
PROPERTY OF ALBERT S. ROACH  
CHARLOTTE, NORTH CAROLINA

PRESENT ZONING - R9  
PROPOSED POPULATION  
CHILDREN 200  
ATTENDANTS 20

PARKING REQUIRED - 30 SPACES  
PLAY AREA  
REQUIRED - 20,000 SQ. FT.

NOTE: BOUNDARY AS INDICATED  
TAKEN FROM DEED REFERENCES 2504-415,  
2937-298 AND SURVEY BY FRANK B.  
HICKS, ASSOC. DATED 12-3-75.

Recommended for approval by Pl. Comm. 7/14/76  
AS APPROVED 7-26-76  
7/25

This plan has been prepared by me  
by [Signature] [Date]

- EXISTING BUILDING
- PROPOSED BUILDING
- OTHER PROPOSED
- ACCESS/PARKING
- SCREEN

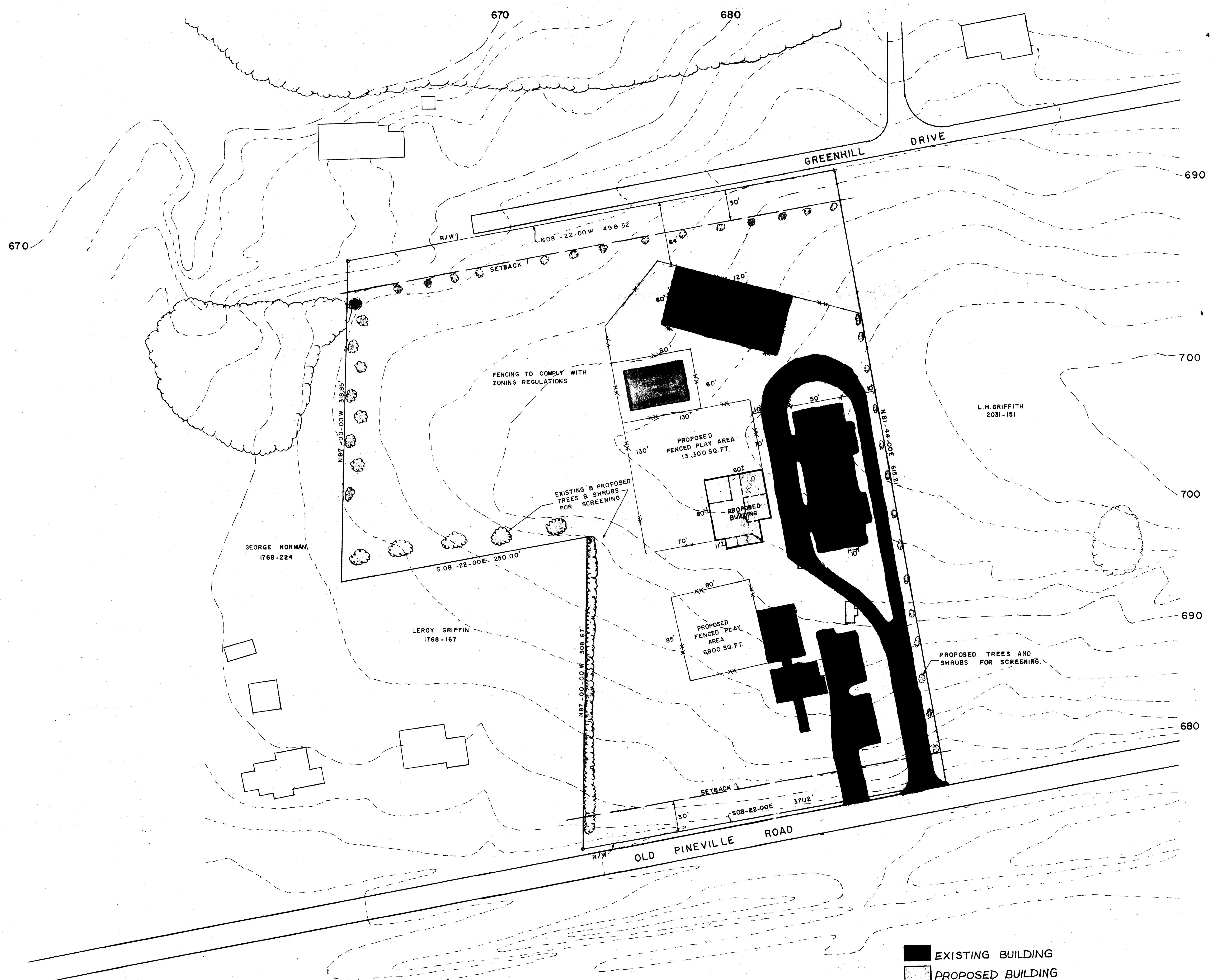
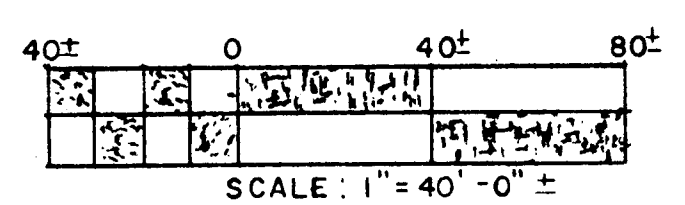
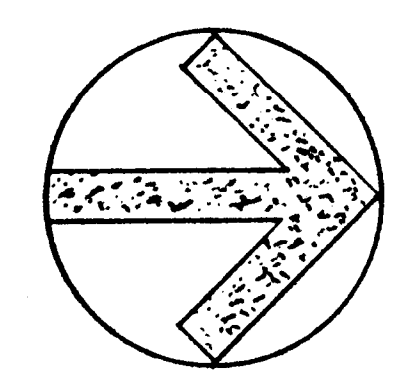

REVISIONS:  
DATE: 5-5-76  
DRAWN BY: L.M.R.  
CHECKED BY: C.E.H.

FRANK B. HICKS ASSOCIATES, INC.  
ENGINEERS ... SURVEYORS ... PLANNERS  
4860 OLD PINEVILLE RD. CHARLOTTE, N. C. 28210

SCHEMATIC  
PLAN

CHILD ACRE DAY CARE CENTER  
PROPERTY OF ALBERT S. ROACH  
CHARLOTTE, NORTH CAROLINA

76-55

PRESENT ZONING - R9  
PROPOSED POPULATION  
CHILDREN 200  
ATTENDANTS 20  
PARKING REQUIRED - 30 SPACES  
PLAY AREA  
REQUIRED - 20,000 SQ. FT.

- EXISTING BUILDING
- PROPOSED BUILDING
- OTHER PROPOSED
- ACCESS/PARKING
- SCREEN

NOTE: BOUNDARY AS INDICATED  
TAKEN FROM DEED REFERENCES 2504-415,  
2937-298 AND SURVEY BY FRANK B.  
HICKS, ASSOC. DATED 12-3-75.

Recommended for approval by Pl. Comm. 7/4/76  
AS APPROVED 7-26-76  
F.B.S.

*(This plan has been replaced by one drawn  
by Brenton Shapiro with revisions 11/1/77)*