

EXISTING ZONING B-2
PROPOSED ZONING I-2 (CD)

LOT OWNED BY:
CHARINOCA CORP.
P.O. BOX 3482
CHARLOTTE, NC. 28203

LOT OWNED BY:
MAURICE & CHARLES KING
RT. 6 BOX 724
CHARLOTTE NC. 28208

PROPERTY OWNED BY:
BOBBY L. BASS
P.O. BOX 654
PAW CREEK, N.C.
28130

PROPERTY OWNED BY:
BILL M. ROBERTS
RT. 6 BOX 70-D
CHARLOTTE NC.
28208

CRESTON CIRCLE
#1673

LOT OWNED BY:
LOWELL MASON CO.
P.O. BOX 6085
CHARLOTTE, NC 28207

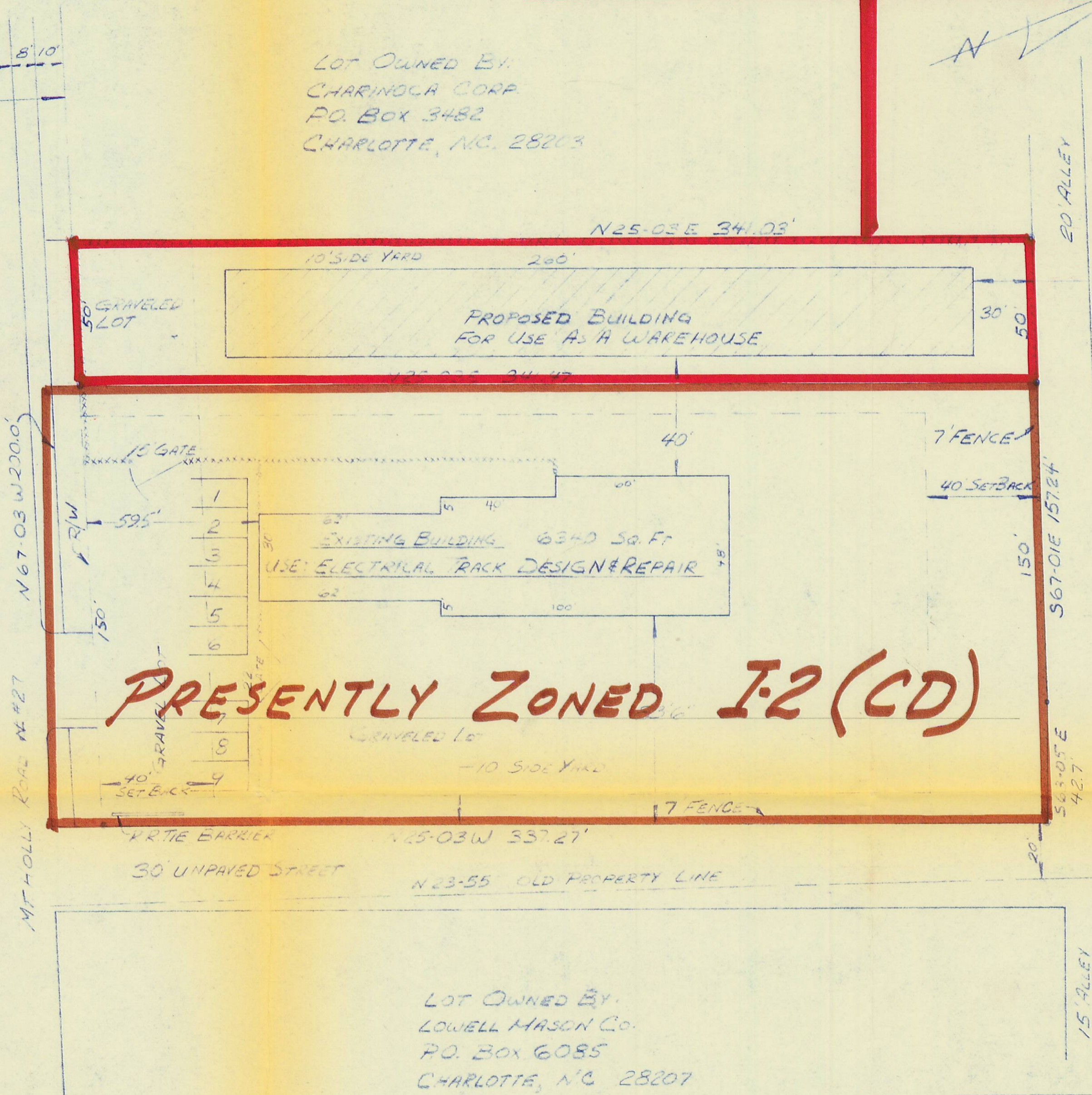

PROPERTY OF: TEXTILE CLEANER & TRUCK SERVICE, INC.	DATE: 10-30-78
CHARLOTTE-MECKLINBURG PLANNING COMMISSION PETITION #	SCALE: 1" = 30'
	DRAWN BY: JC

**EXISTING ZONING B-2
PROPOSED ZONING I-2 (CD)**

LOT OWNED BY
CHARNESE W. W. P.
P.O. BOX 124
CHARLOTTE, N.C. 28208

LOT OWNED BY
MAURICE & CHARLES KING
RT. 6 Box 124
CHARLOTTE N.C. 28208

PROPERTY OWNED BY
E. L. BASS
P.O. BOX 654
SALF CREEK, N.C.
28137

PROPERTY OWNED BY
SALLY ROSE
P.O. BOX 710
CHARLOTTE N.C.
28208

CREDIT CIRCLE
#1675

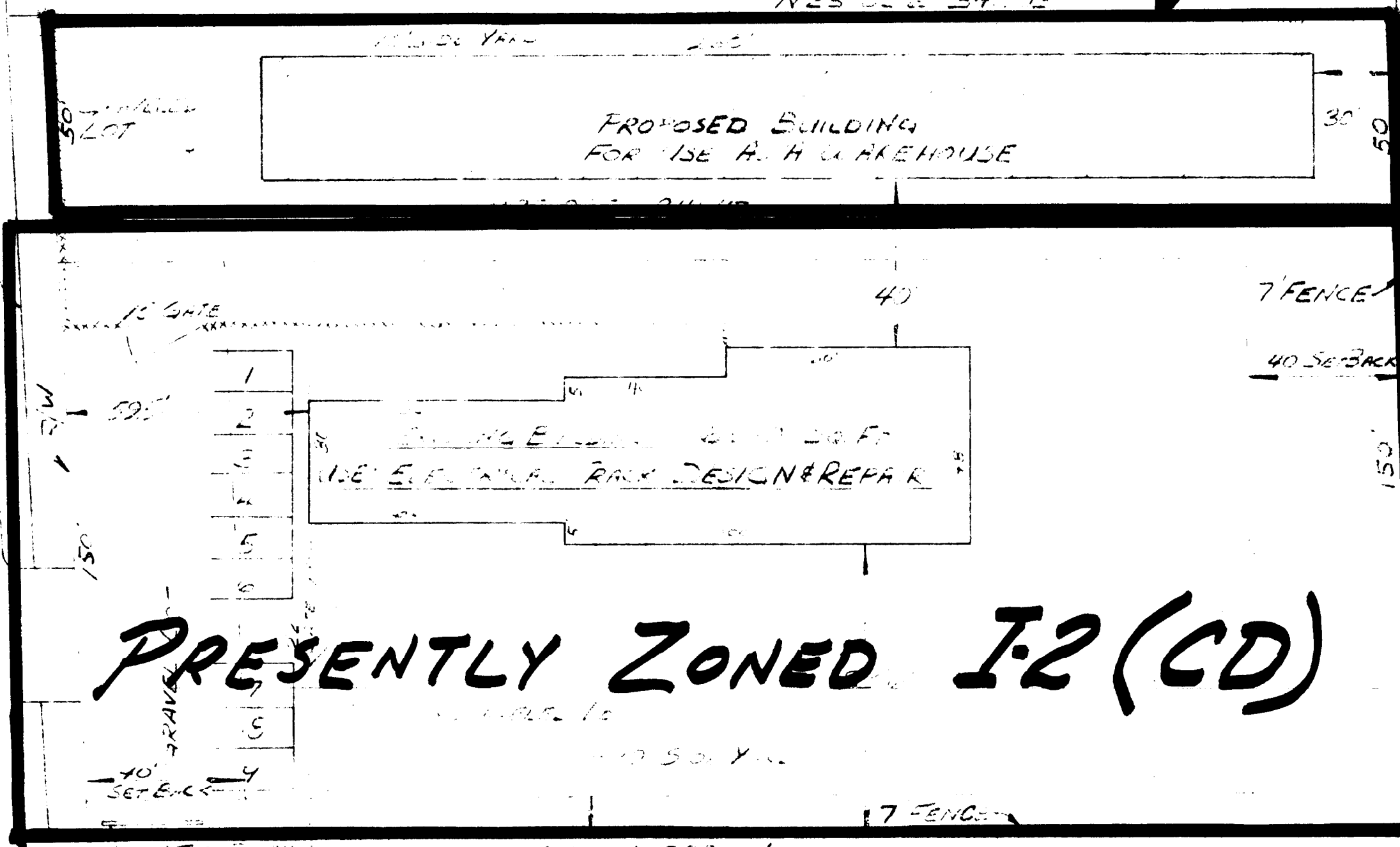

PRESENTLY ZONED I-2 (CD)

LOT OWNED BY
LOWELL HASKIN CO.
P.O. BOX 6785
CHARLOTTE N.C. 28207

PROPERTY OF: TEXTILE CLEANER & TRUCK SERVICE, INC.	DATE: 10-30-78
CHARLOTTE-MECKLENBURG PLANNING COMMISSION PETITION #	SCALE: 1" = 30' DRAWN BY: *