

BK 209 PG 011 LOT 12
 B. 15.31 AC QUAIL HOLLOW ROAD
 CHARLOTTE, MECALEMBURG BOARD OF EDUCATION
 P.O. BOX 17437
 CHARLOTTE, N.C. 28211

BK 209 PG 191 LOT 34A
 B. 48.09 AC GLENLEAGLES ROAD
 MR. & MRS. JAMES J. HARRIS
 P.O. BOX 17437
 CHARLOTTE, N.C. 28211

BK 179 PG 091 LOT 11
 B. 12.8 AC 5708 SHARON ROAD
 C. H. DAVIS
 5/6 HOME REALTY & MGT. CO.
 221 S. CHURCH ST., SUITE 107
 CHARLOTTE, N.C. 28202
 THIS PARCEL ZONED R-15MF

SCALE 1" = 40'

GROSS AREA 14,278 SQUARE FEET
 NET AREA 10,360 SQUARE FEET
 ZONING R-15

LEGEND

FIRST PHASE 19000 SQ. FT.
 FUTURE PHASE 40000 SQ. FT. TOTAL

PARKING

FIRST PHASE REQUIRED - 98 SPACES
 FIRST PHASE PROVIDED - 126 SPACES
 FUTURE PHASES REQUIRED - 116 SPACES
 FUTURE PHASES SPACE PROVIDED FOR - 303 SPACES

* PARKING REQUIREMENTS BASED ON 1 SPACE PER 40 S.F. OF FLOOR AREA AVAILABLE FOR SEATING IN GYMNASIUM
 PHASE 1 : 3,100 S.F. ÷ 40 = 98 SPACES

* 98 SPACES BK 179 PG 091 LOT 15
 D.L. 10 B IS MID-1971 5706 SHARON RD.
 MR. W. F. TAYLOR
 5706 SHARON ROAD
 CHARLOTTE, N.C. 28210

BK 179 PG 091 LOT 17
 D.L. 17 B IS MID-1971 5708 SHARON RD.
 MR. WILLIAM E. HARRIS
 5708 SHARON ROAD
 CHARLOTTE, N.C. 28210

BK 209 PG 193 LOT 15 A,B,C,D
 B 2 5746 M 967-269 SHARON RD.

15A MR. GEORGE H. EMERY
 478 TEQUESTA DR., APT 103
 TEQUESTA, FLORIDA 33408

15B MARTHA JEAN EMERY SCHNORM
 1232 MARLBOROUGH TERRACE
 CHARLOTTE, N.C. 28209

15C EMERY ETHEL BILES
 1820 PARK LANEPORT #301
 NEWPORT BEACH, CALIFORNIA 92660

15D JOHN LOCH EMERY
 2254 TULSA AVE.
 CLAREMONT, CALIFORNIA 91711

BK 209 PG 193 LOT 26
 B 2 2.04 AC PTB - M-167-269 SHARON HILLS
 HENDRICKS KENNEDY ASSOCIATES, INC.
 821 BAXTER ST., SUITE 310
 CHARLOTTE, N.C. 28202

Project Architect	
Project Engineer	
Job Captain	
Drawn by	
Date	JULIE 5, 1978
Revised	11/21/78

J. N. Pease Associates
 Post Office Box 12725 2925 East Independence Boulevard
 Charlotte, North Carolina 28206

Architecture
 Engineering
 Planning

PROPOSED LAND USE

South Branch YMCA
 Sharon Road
 Charlotte, North Carolina

ZONING

Sheet Number

Z-1

Total

2822-02

Attach to map of J. N. Pease Associates

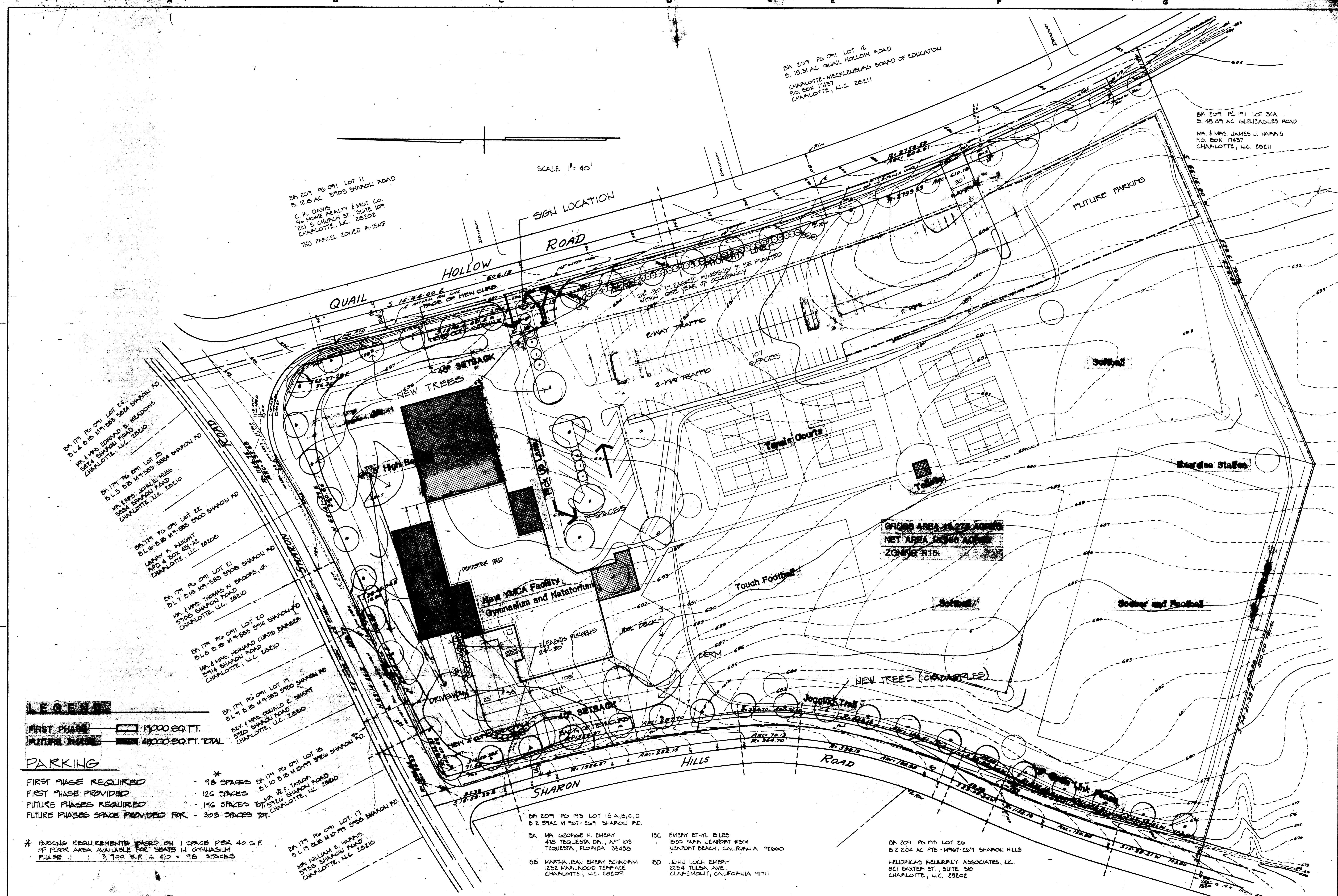

Project Architect Project Engineer J.N. Pease Associates Drawn by Date 11/21/78	<p>J. N. Pease Associates Post Office Box 12725 2925 East Independence Boulevard Charlotte, North Carolina 28226</p> <p>Architecture Engineering Planning Charlotte, North Carolina 28206</p>	<p>PROPOSED LAND USE South Branch YMCA Special Use Permit Charlotte, North Carolina</p>	<p>ZONING Special Number Z-1</p>
--	---	---	--

METROPOLITAN OFFICES
400 EAST MOREHEAD STREET • CHARLOTTE, NORTH CAROLINA 28202 • PHONE 704-333-7773
April 1, 1980

Mr. Fred E. Bryant
Charlotte-Mecklenburg Planning Commission
Cameron Brown Building
Charlotte, North Carolina, 28204

Dear Mr. Bryant:

Thanks very much for discussing with us yesterday some questions which have arisen concerning site development of the James J. Harris Branch YMCA property at 5200 Quail Hollow Road.

Enclosed for your review is the site plan drawn by our architect, Larry Taylor, of J. N. Pease Associates, according to your instructions.

We request that consideration be given to administrative approval of the change as shown on the drawing, which involves a service driveway from Sharon Hills Road to the rear of the building for delivery and dumpster use only.

We regret our misunderstanding about required procedure on this matter, and assure you that we will appreciate any consideration that is possible within the framework of Planning Commission responsibility.

Sincerely,
George J. Creswell
George J. Creswell

GJC:gc

METROPOLITAN OFFICES
400 EAST MOREHEAD STREET • CHARLOTTE, NORTH CAROLINA 28202 • PHONE 704-333-7773
April 30, 1980

Mr. Fred E. Bryant
Charlotte-Mecklenburg Planning Commission
Cameron Brown Building
Charlotte, North Carolina 28204

Dear Mr. Bryant:

Under separate cover I am submitting landscaping revisions to the site plan of our James J. Harris Branch YMCA, according to recent discussions between you and Mr. Norman Pease, Jr.

We will complete the driveway area landscaping prior to building occupancy, and will complete the parking area landscaping within one year after occupancy.

Again, we apologize for the misunderstanding, and appreciate your patience and consideration in this matter.

Please notify me or J. N. Pease, Associates of your final decision.

Sincerely,
George J. Creswell
George J. Creswell

GJC/f

INTER-OFFICE COMMUNICATION

DATE: May 5, 1980
FROM: Fred E. Bryant, Assistant Planning Director
TO: Mr. Dale Long, City Zoning Administrator

SUBJECT: Revised Site Plan, YMCA at Quail Hollow Road and Sharon Hills Road (Special Use Permit - Petition No. 78-47)

Attached is a revised site plan for the above mentioned project which I am administratively approving. One change consists of the addition of a service driveway off Sharon Hills Road with accompanying screening.

The other change is the replacement of a berm with additional planting between the parking lot and Quail Hollow Road which is to be planted within one year of occupancy.

FEB/DE/mh
cc: Mr. George J. Creswell, YMCA
Attachments

Attach to memo of J. N. Pease Associates

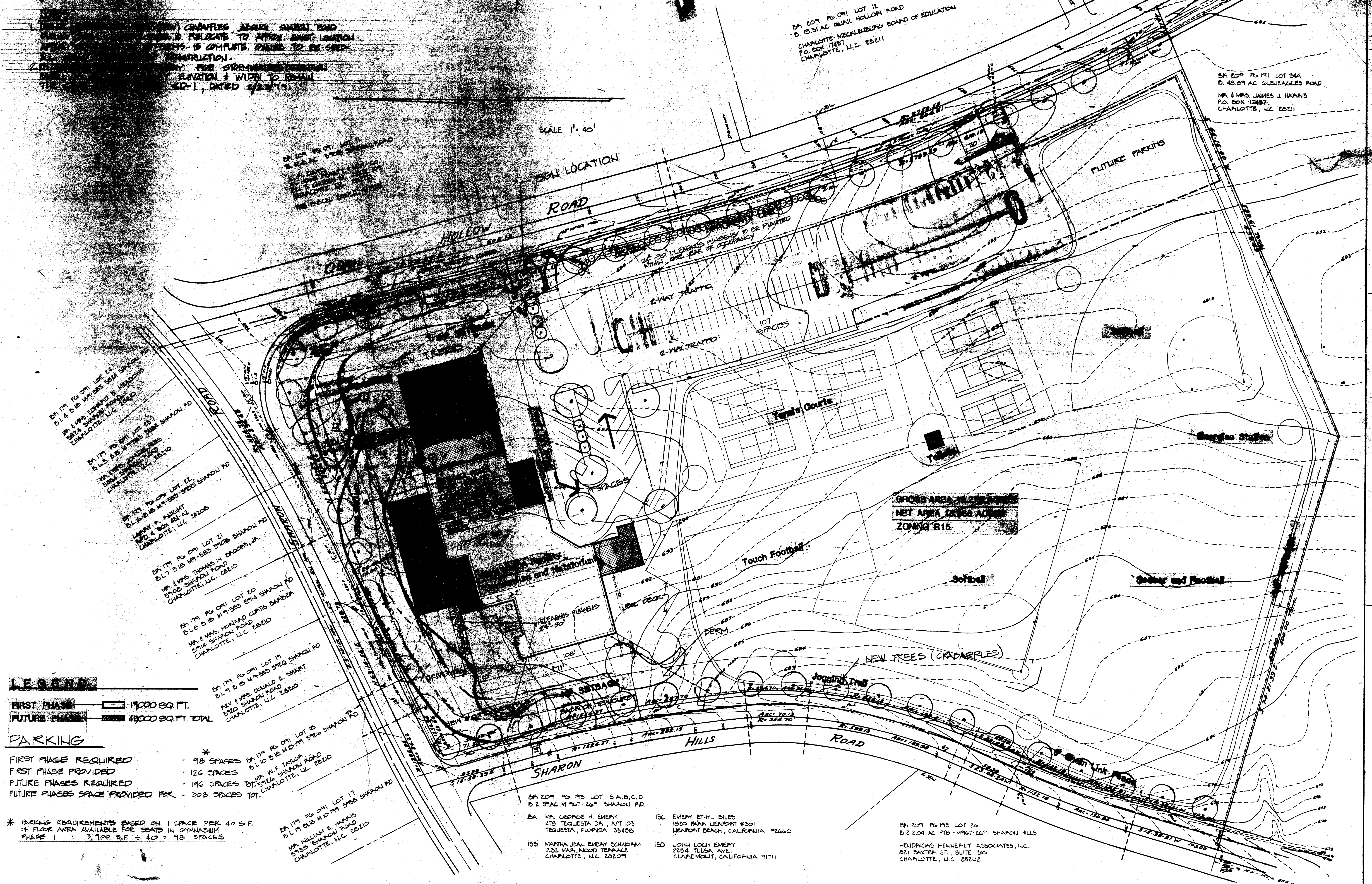

Project Architect Project Engineer Job Coach Drawn by Date 11/24/80	<p>J. N. Pease Associates Post Office Box 12725 2925 East Independence Boulevard Charlotte, North Carolina 28206</p>	<p>Architecture Engineering Planning</p>	<p>PROPOSED LAND-USE</p> <p>South Branch YMCA Sharon Road Charlotte, North Carolina</p>	<p>Sheet Number</p> <p>Z-1</p>
--	---	--	--	---------------------------------------

James J. Harris Branch Family YMCA
Young Men's Christian Association of Charlotte and Mecklenburg
5900 Quail Hollow Road
Charlotte, N.C. 28210
Phone 704/558-7800

James J. Harris Branch Family YMCA
Young Men's Christian Association of Charlotte and Mecklenburg
5900 Quail Hollow Road
Charlotte, N.C. 28210
Phone 704/558-7800

CHARLOTTE-MECKLENBURG PLANNING COMMISSION
INTER-OFFICE COMMUNICATION

March 3, 1981

City of Charlotte Planning Commission
3015 McDowell St.
Suite 100
Charlotte, N.C. 28204

Attention: Robert G. Young, Sr. Policy Planner

Dear Bob,

I wish to make a request on behalf of the Harris YMCA for your consideration of our need to modify the existing landscaping on the Sharon Road side of our facility.

Gary Morgan of J.N. Pease will provide to your department a drawing (2-1) dated March 3, 1981 that describes this modification. We are essentially requesting to add more berm along Sharon Road and increase the height of the existing berm. This work will require removing the trees along Sharon Road, temporarily, until the dirt has been moved in and shaped. The trees will then be replanted and the disturbed area seeded with grass.

I appreciate your consideration of this request. We feel sure that this action will be a welcome improvement for our YMCA.

Sincerely,
Andy Calhoun
Andy Calhoun
Branch Director

cc: Miles Boyer
Benner Crigler
George Craswell
Gary Morgan

March 3, 1981

City of Charlotte Planning Commission
3015 McDowell St.
Suite 100
Charlotte, N.C. 28204

Attention: Robert G. Young, Sr. Policy Planner

Dear Bob,

I wish to make a request on behalf of the Harris YMCA for your consideration of our need to modify the existing landscaping on the Sharon Road side of our facility.

Gary Morgan of J.N. Pease will provide to your department a drawing (2-1) dated March 3, 1981 that describes this modification. We are essentially requesting to add more berm along Sharon Road and increase the height of the existing berm. This work will require removing the trees along Sharon Road, temporarily, until the dirt has been moved in and shaped. The trees will then be replanted and the disturbed area seeded with grass.

I appreciate your consideration of this request. We feel sure that this action will be a welcome improvement for our YMCA.

Sincerely,
Andy Calhoun
Andy Calhoun
Branch Director

cc: Miles Boyer
Benner Crigler
George Craswell
Gary Morgan

DATE: March 3, 1981

TO: Mr. Dale Long,
City Zoning Administrator

FROM: *Fred E. Bryant*
Fred E. Bryant,
Assistant Planning Director

SUBJECT: - Revised Site Plan, YMCA at Quail Hollow Road and Sharon Road. (Special Use Permit - Petition No. 78-47)

Attached is a revised site plan for the above mentioned project which I am administratively approving. The change involves adding more berm along Sharon Road and increasing the height of existing berm to 6 - 8 feet high.

cc: Mr. Andy Calhoun
Branch Director
James J. Harris Branch YMCA
5900 Quail Hollow Road
Charlotte, N.C. 28210

cc: Mr. Gary Morgan
J. N. Pease Associates
P. O. Box 12725
2925 East Independence Boulevard
Charlotte, N.C. 28206