

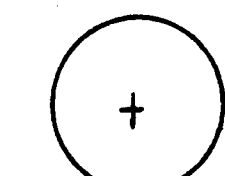
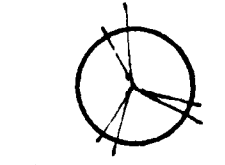

LEGEND OF PROPOSED PLANTING

-  LARGE SHADE TREE
(SUGAR MAPLE, RED MAPLE, OR WILLOW OAK)
-  SMALL FLOWERING TREE
(CREPE MYRTLE, BRADFORD PEAR, WASHINGTON HAWTHORNE, ETC.)
-  LARGE EVERGREEN SHRUB
(BURFORD HOLLY, PHOTINIA, OSMANTHUS, ETC.)
-  SMALL EVERGREEN SHRUB
(COMPACTA HOLLY OR CORNUTA HOLLY)

SITE INFORMATION

OWNER - GOOD SHEPHERD LUTHERAN CHURCH, INC.
 LOCATION - 5301 ALBEMARLE ROAD
 SITE AREA - 2.196 ACRES
 PRESENT ZONING - R-9 MF
 PROPOSED ZONING - O-15 (CA)

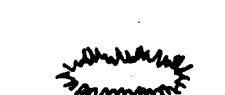
LAND USE SCHEDULE

PROPOSED USE: GENERAL OFFICE BUILDING

	PHASE ONE	PHASE TWO	TOTAL
GROSS BUILDING AREA - SF	17,400	17,400	34,800
NET LEASABLE AREA - SF	14,400	14,400	28,800
NUMBER OF FLOORS (MAX)	3	3	3
GROSS AREA / FLOOR - SF	5,800	5,800	11,600
NET AREA / FLOOR - SF	4,800	4,800	9,600
PARKING SPACES REQUIRED	58	58	116
PARKING SPACES PROVIDED	58	60	118

NOTES:

1. SCREEN PLANTING AS SHOWN & SHALL MEET/EXCEED ORDINANCE REQ.
2. SITE LIGHTING SHALL BE SHIELDED TO RETAIN PATTERN ON PREP.
3. SITE DRAINAGE SYSTEM SHALL MEET/EXCEED ORD. REQ. FOR STORM WATER RETENTION.
4. EXIST. BUILDING TO BE REMOVED UNDER PHASE TWO CONST.
5. BUILDING SHAPES MAY VARY FROM THAT SHOWN, BUT SHALL NOT EXCEED TOTAL AREA OF EACH BUILDING INDICATED IN ABOVE SCHEDULE.
6. DRIVEWAY ENTRANCES & EXITS SHALL BE SUBJECT TO DESIGN APPROVAL BY APPLICABLE GOVERNMENT AGENCIES.
7. DETACHED SIGNS MAY BE PROVIDED & LOCATED PER THE ZONING ORDINANCE.
8. A COMMON DESIGN CONCEPT WILL BE UTILIZED FOR THE TWO BUILDINGS. ADDITIONALLY, SIMILAR EXTERIOR MATERIAL WILL BE USED TO CREATE A HARMONIOUS STRUCTURAL RELATIONSHIP.
9. NOT MORE THAN 2 DETACHED SIGNS WILL BE PERMITTED, LOCATED IN ACCORDANCE WITH ORDINANCE REQUIREMENTS. A LOW, PEDESTAL TYPE SIGN WILL BE USED TO BLEND WITH THE DESIGN FEATURES OF THE DEVELOPMENT.

CPI EXECUTIVE EQUITY PROGRAM
 2700 CUMBERLAND PARKWAY N.W.
 ATLANTA, GEORGIA 30339

EVERGREEN SHRUBS (± 6' O.C.)
 TO SUPPLEMENT EXISTING WHITE PINES
 SCREEN ON ADJACENT PROPERTY

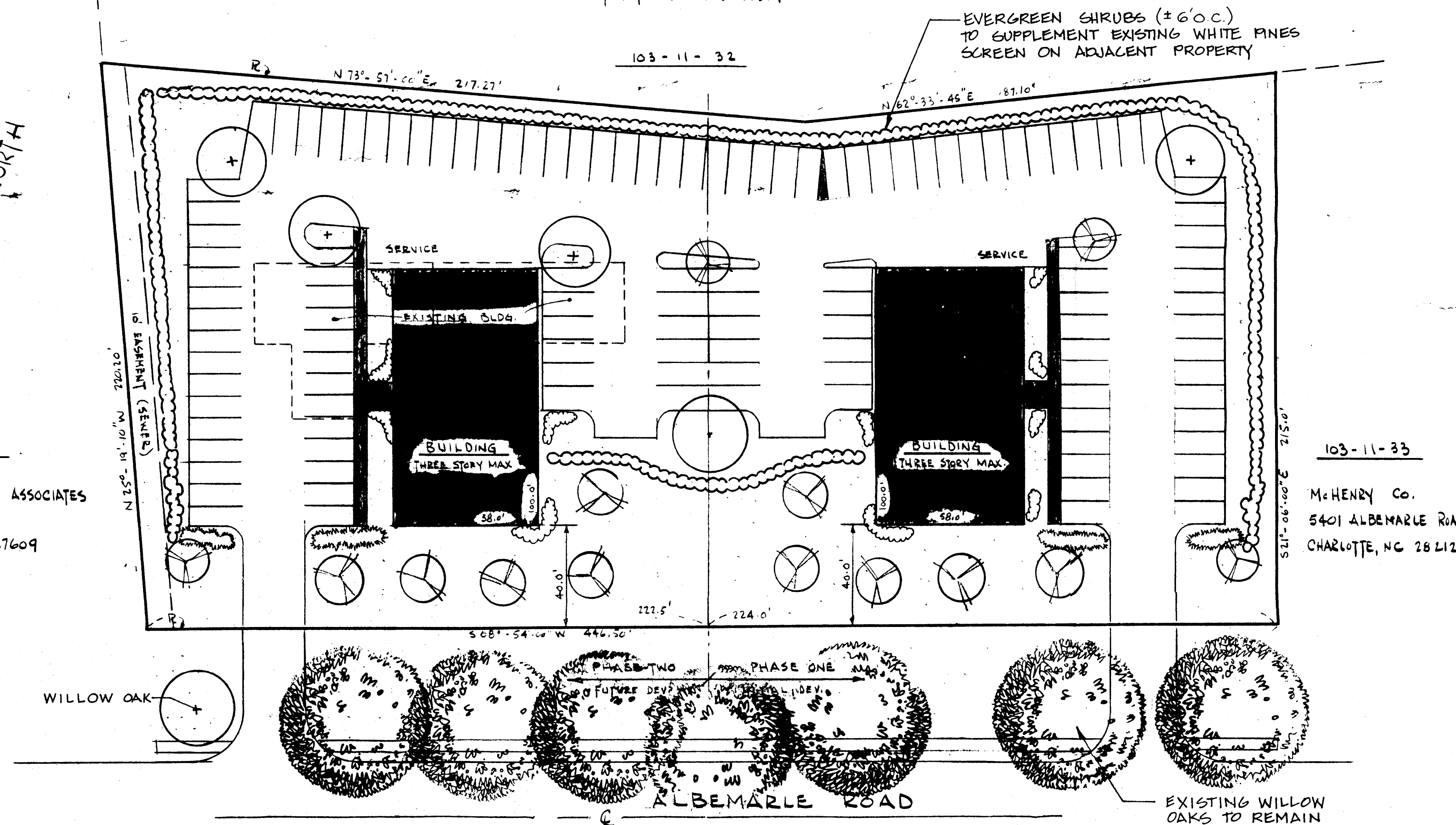

SITE PLAN (OCT. 11, 1982)

SCALE: 1" = 30'

Approved
 1/18/83

ALBEMARLE ROAD ASSOCIATES
 P.O. Box 17044
 RALEIGH, N.C. 27609

133-41-13
 THOMAS A. BAUCOM
 5232 ALBEMARLE ROAD
 CHARLOTTE, NC 28212

133-41-12
 FIRST CHURCH OF GOD
 5300 ALBEMARLE ROAD
 CHARLOTTE, N.C. 28212

133-41-11
 JAMES FRANKLIN BAILEY
 5500 STARKWOOD DR.
 CHARLOTTE, NC 28212
 Proj. # 82-59
 Good Shepherd Lutheran Church, Inc.

R H KENT ASSOCIATES
 CONSULTING ENGINEERS
 COLUMBIA SOUTH CAROLINA

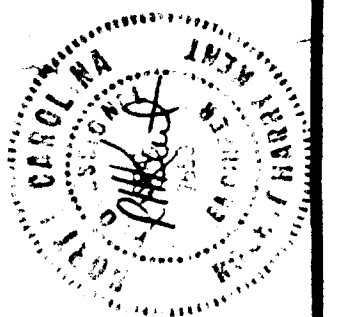

STUDY PLAN
 5301 ALBEMARLE ROAD SITE
 CHARLOTTE, N.C.

JOB NO. 020482
 DRAWN BY EHK
 DATE 10-11-82

DRAWING NO.
 SP-1