

- GENERAL NOTES
1. THIS MOBILE HOME DEVELOPMENT SHALL COMPLY WITH SECTION 3213 OF THE MECKLENBURG COUNTY, N.C. ZONING ORDINANCE.
  2. ALL STRUCTURES SHALL CONFORM WITH STANDARD DESIGNS AND SPECIFICATIONS OF THE MECKLENBURG COUNTY, N.C. ENGINEERING DEPARTMENT.
  3. TOTAL PERIMETER OF THIS PLAN IS 14.57 ACRES, TOTAL NUMBER OF M.H. SPACES = 71
  4. THIS PLAN IS DESIGNED FOR MOBILE HOME RENTAL SPACES.
  5. STORM DRAINAGE BASED ON TALBOT METHOD "C", 6" WITH 5" RAINFALL FOR 25 YEAR FLOOD. MECKLENBURG COUNTY ENGINEERING DEPARTMENT STANDARD 70.03, REFERENCE CHART NUMBER 18.

**APPROVED**  
 CHARLOTTE-MECKLENBURG BUILDING STANDARDS  
 J. Hunter  
 PLAN REVIEWER, SORTING DATE

A PRELIMINARY PLAN OF: SECTION 4 HUNTLYNN ACRES MOBIL HOME PARK			
OWNER: HUNTLYNN ASSOCIATES 2222 SAM WILSON RD., CHARLOTTE, N.C. 28214			
LOCATION BERRYHILL TWSR., MECKLENBURG COUNTY, N.C.			
AGENT: JERRY J. HUNTER 399-5327			
SCALE: 1"=50'	DATE DEC. 13, 1985	FILE NO B-35-7	SHEET OF 5
JOHN D. CAMPBELL N.C. REGISTERED LAND SURVEYOR P.O. BOX 602, FAW CREEK, N.C. 28213 374-1760			

REVISED: MARCH 3, 1986  
 AUGUST 11, 1986  
 MARCH 5, 1987

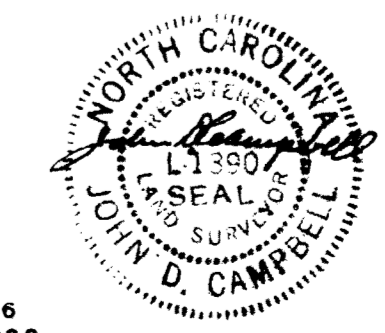

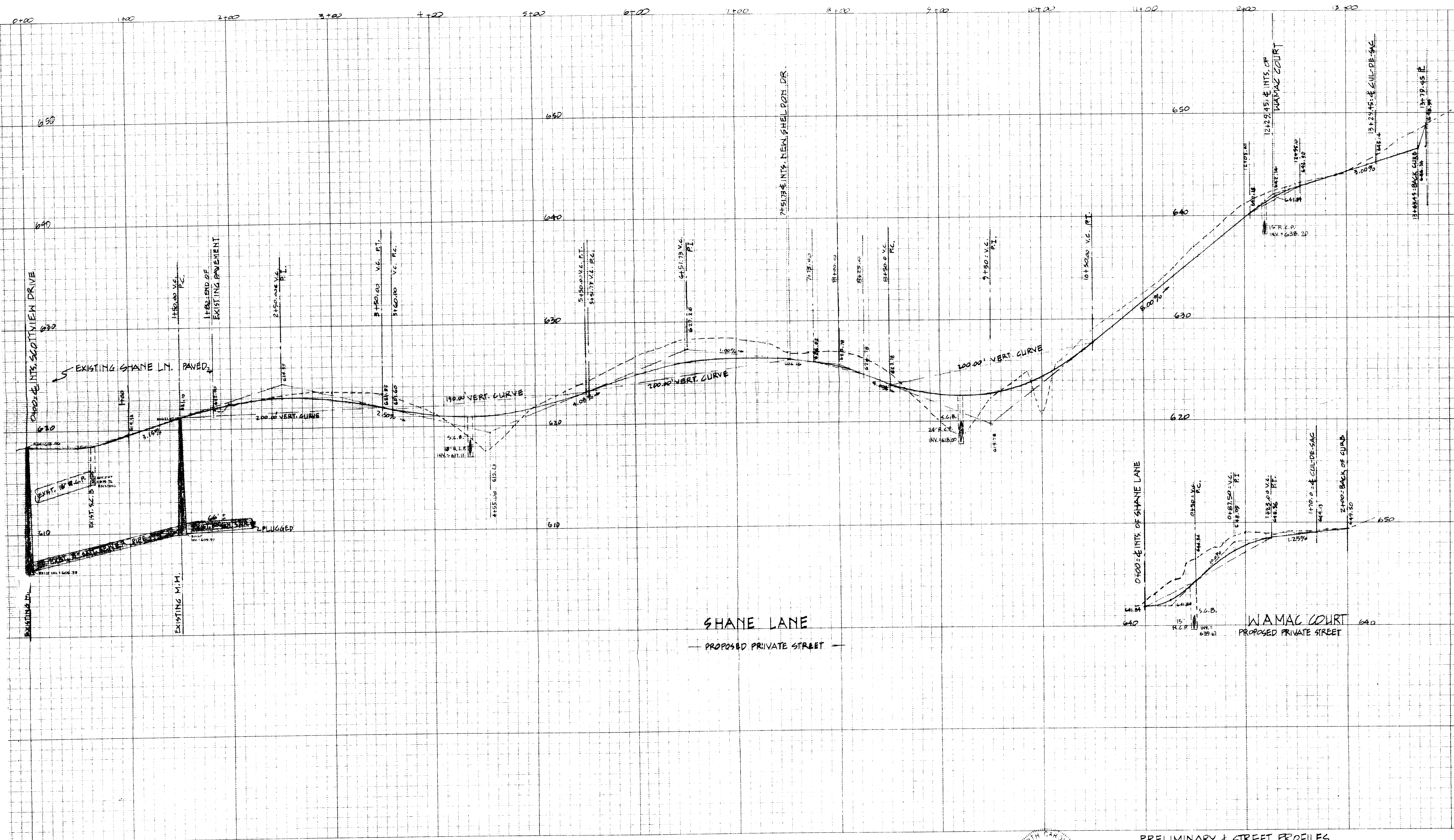

SHANE LANE  
 PROPOSED PRIVATE STREET

WAMAC COURT  
 PROPOSED PRIVATE STREET

NO. 1259 - PROFILES PLATE A  
 CLEARPRINT PAPER CO.  
 MADE IN U.S.A.

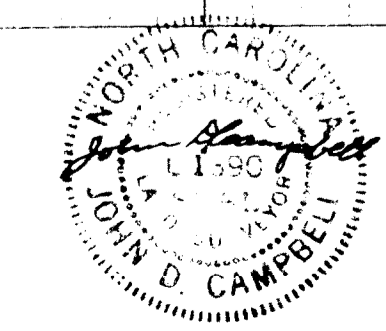

PRELIMINARY & STREET PROFILES  
 HUNTLYNN ACRES MOBILE HOME PARK, SECT. 4  
 BERRYHILL TOWNSHIP, MECKLENBURG CO., N.C.  
 SCALE: 1" = 40' HORIZ. & 1" = 4.0' VERT. DEC. 13, 1985  
 JOHN D. CAMPBELL, N.C. R. L. S. L-1390

0+00 1+00 2+00 3+00 4+00 5+00 6+00 7+00 8+00 9+00 10+00 11+00 12+00 13+00

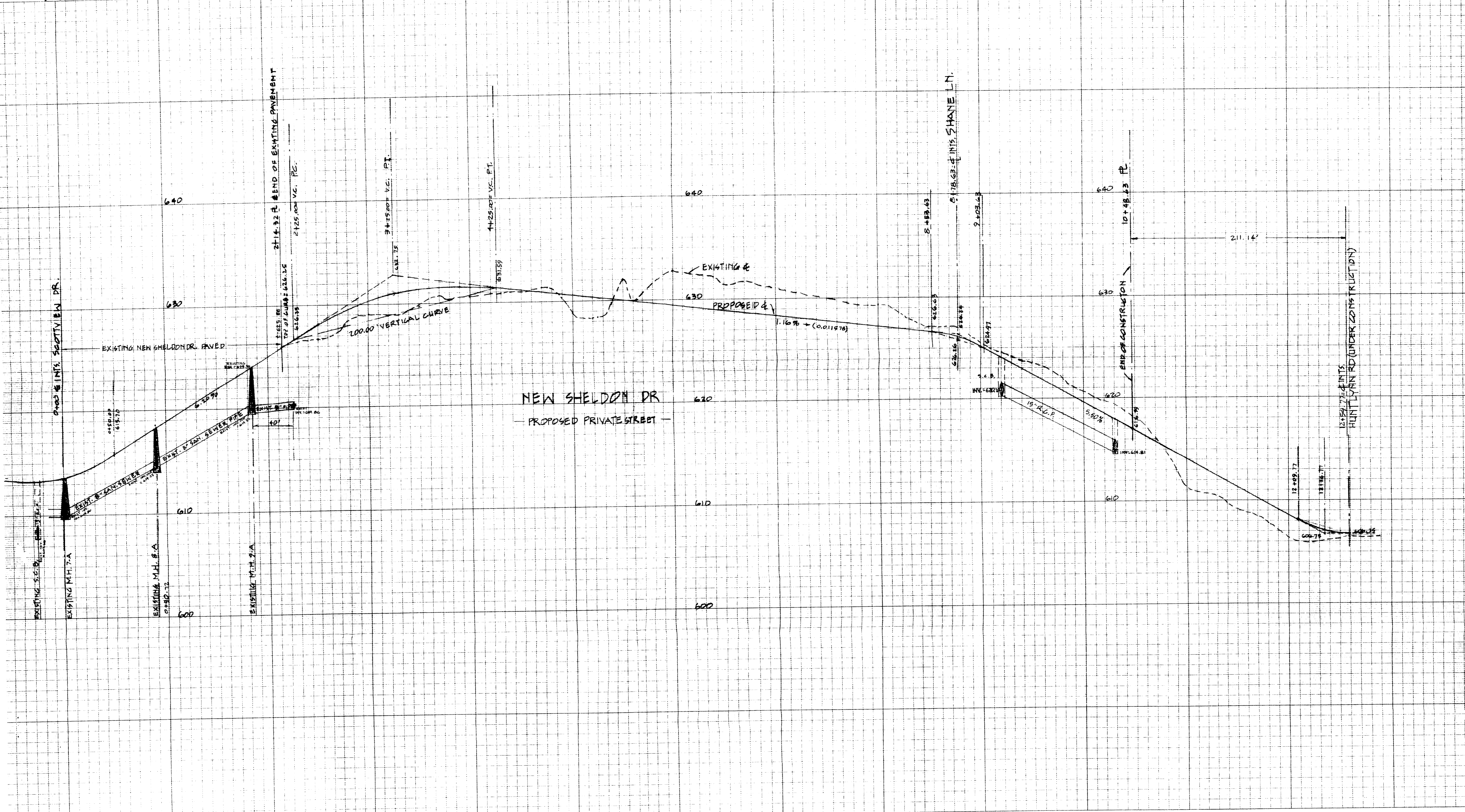

PRELIMINARY & STREET PROFILES  
HUNTLINN ACRES MOBILE HOME PARK, SECT. 4  
BERRYHILL TWP, MECKLENBURG CO., N.C.  
SCALE: 1"=40' HORZ. & 1"=4.0' VERT. DEC. 13, 1985  
John D. Campbell, N.C. R.L.S. L-1390

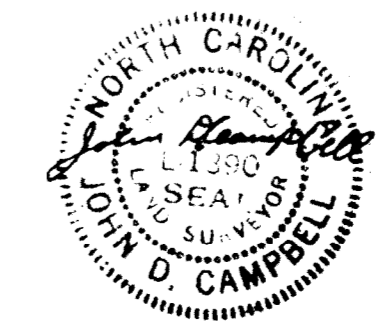



055-392-04  
L.C. DEECE  
DEED 905-45

055-392-04  
L.C. DEECE  
DEED 1099-120

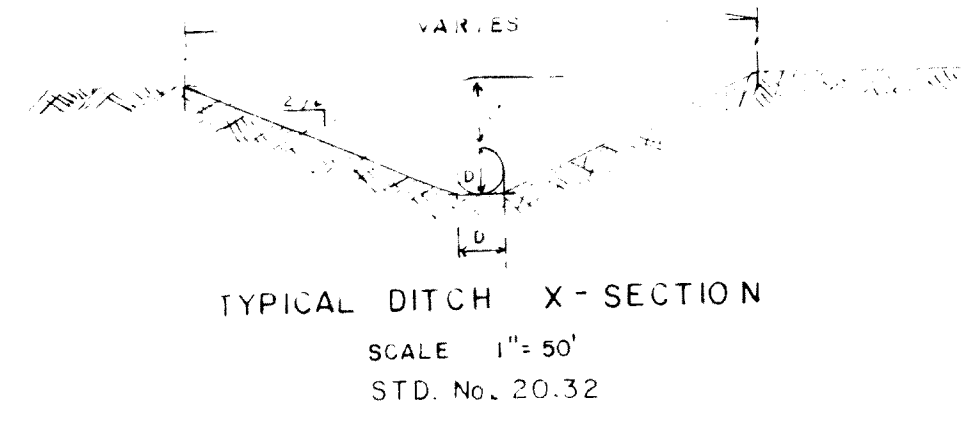
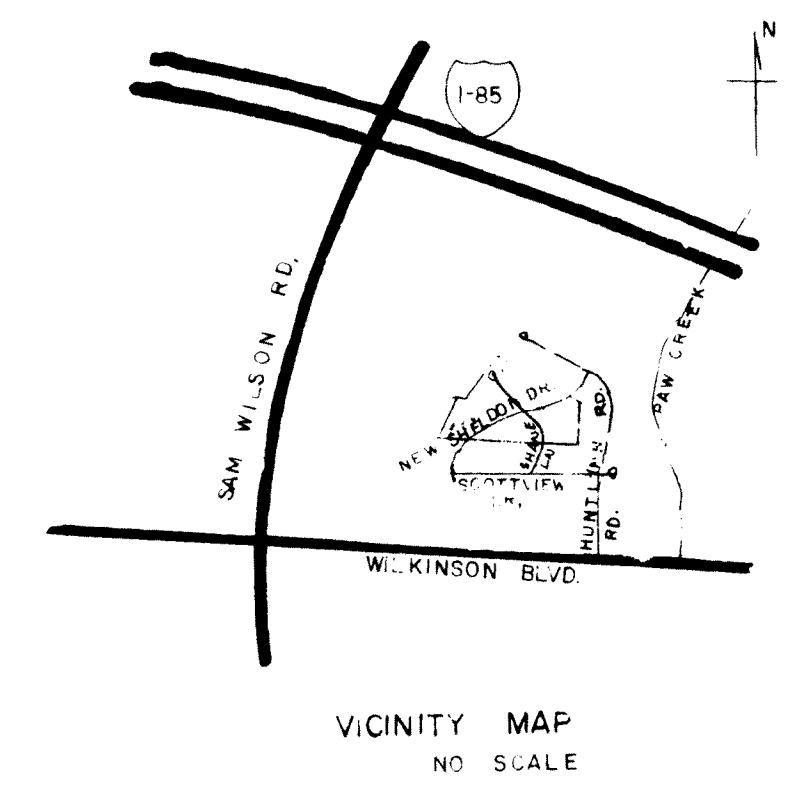

NOTE: ALL MEASUREMENTS OF VEGETATION SHALL CONFORM TO THE MECKLENBURG COUNTY, N.C. GUIDELINES AND SPECIFICATIONS FOR SOIL EROSION AND SEDIMENT CONTROL AND ADDITIONAL EROSION CONTROL MEASURES MAY BE REQUIRED, DEPENDING ON FIELD CONDITIONS.

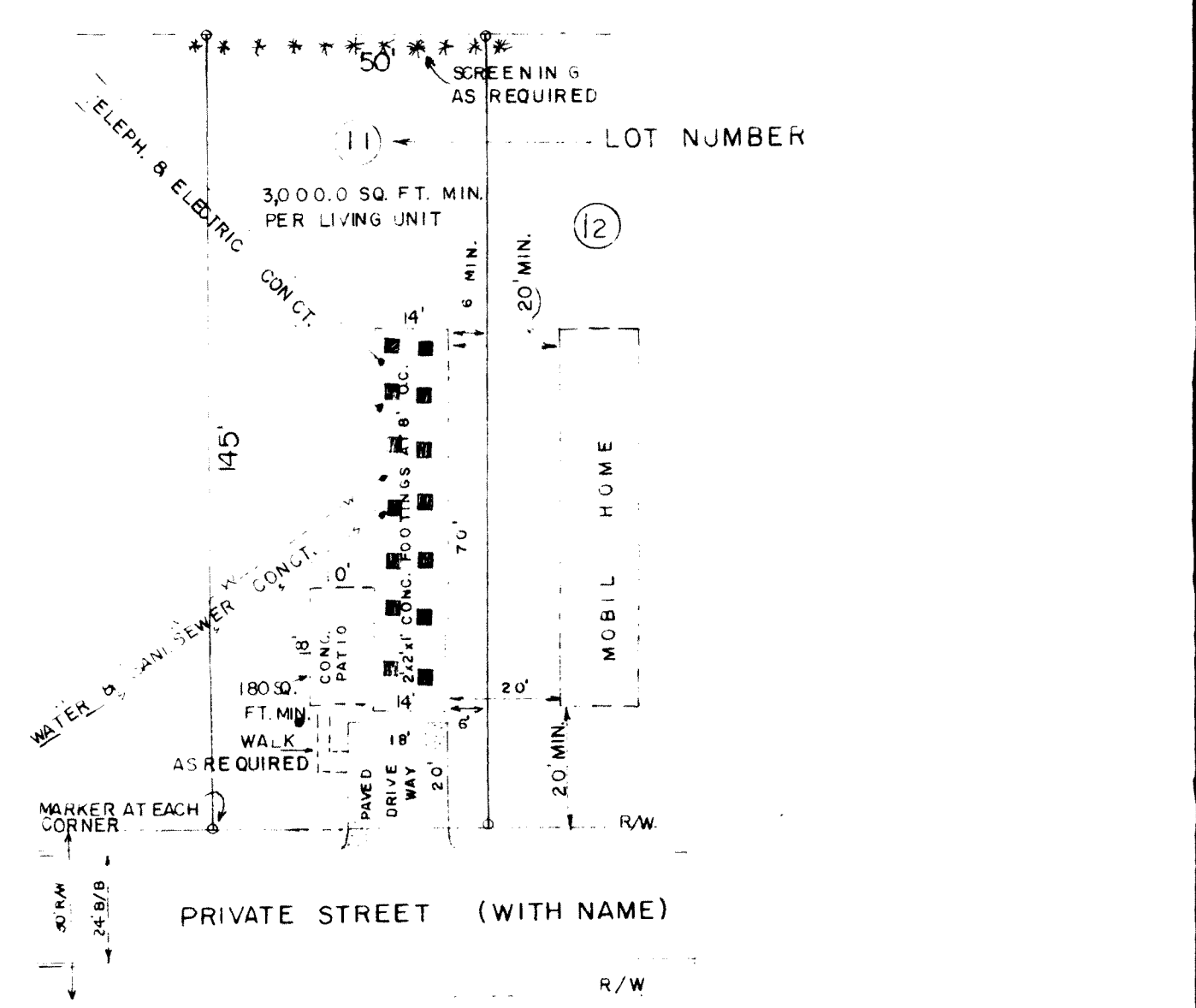
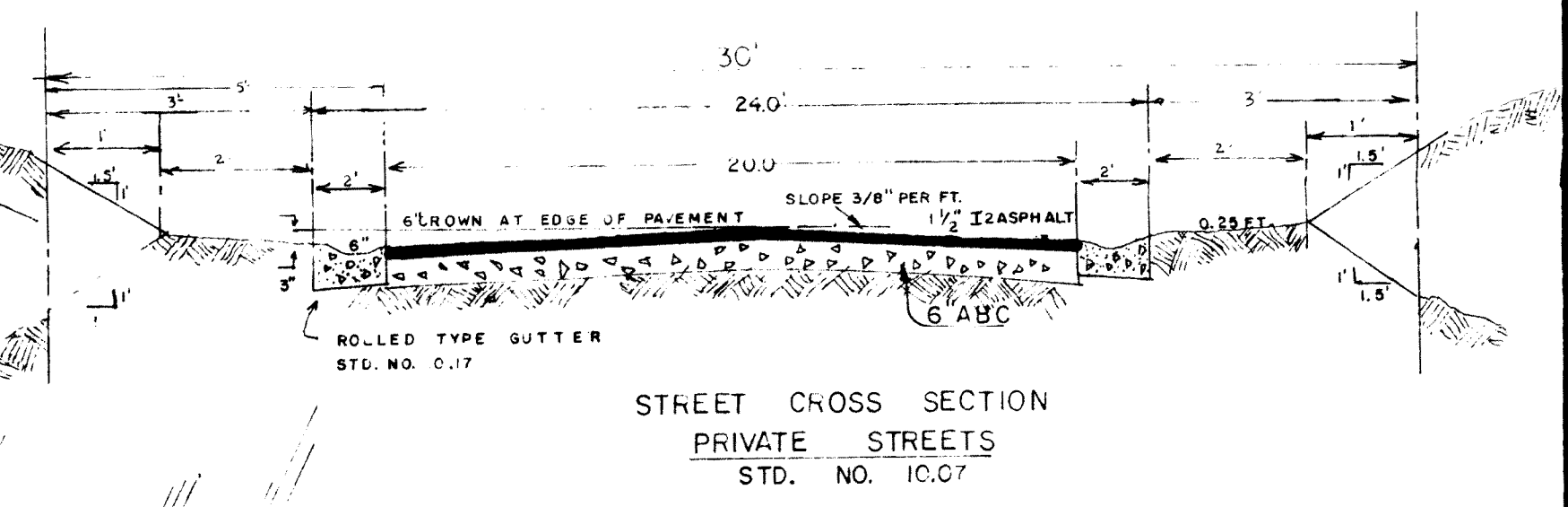

GENERAL NOTES

1. THIS MOBILE HOME DEVELOPMENT SHALL COMPLY WITH SECTION 32.3 OF THE MECKLENBURG COUNTY, N.C. ZONING ORDINANCE.
2. ALL STRUCTURES SHALL CONFORM WITH STANDARD DESIGNS AND SPECIFICATIONS OF THE MECKLENBURG COUNTY, N.C. ENGINEERING DEPARTMENT.
3. TOTAL PERIMETER OF THIS PLAN IS 1457 ACRES, TOTAL NUMBER OF M.H. SPACES IS 71.
4. THIS PLAN IS DESIGNED FOR MOBILE HOME RENTAL SPACES.
5. STORM DRAINAGE BASED ON TALBOT METHOD "C", G WITH 6" RAINFALL FOR 25 YEAR FLOOD, MECKLENBURG COUNTY ENGINEERING DEPARTMENT STANDARD 70.03, REFERENCE CHART NUMBER 18.

CONSTRUCTION SEQUENCE

1. OBTAIN PERMIT AFTER POSTING BOND
2. GRADE AND INSTALL GRINEL AT ENTRANCE
3. INSPECTION BY MECKLENBURG COUNTY ENGINEERING DEPT.
4. CLEAR AND GRADE SITE
5. INSTALL CURB AND GUTTER AND BACK-FILL SAME WITH EARTH AND COVER WITH PLANTING AS SHOWN ON SHEET 4.
6. COMPLETE CONSTRUCTION AND PAVING, THEN STABILIZE AND COVER ALL REMAINING DEWEED AREAS
7. INSPECTION BY MECKLENBURG COUNTY ENGINEERING DEPT.

EROSION AND SEDIMENT CONTROL PLAN  
(SEE SHEETS FOR SEEDING AND DETAILS)

A PRELIMINARY PLAN OF: SECTION 4  
HUNTLYNN ACRES MOBIL HOME PARK

OWNER: HUNTLYNN ASSOCIATES  
2222 SAM WILSON RD., CHARLOTTE, N.C. 28214

LOCATION: BERRYHILL TOWNSHIP, MECKLENBURG COUNTY, N.C.

AGENT: JERRY J. HUNTER 399-5327

SCALE: 1"=50'	DATE: DEC. 13, 1985	FILE NO: B-35-7	SHEET: 4 OF 5
---------------	---------------------	-----------------	---------------

JOHN D. CAMPBELL N.C. REGISTERED LAND SURVEYOR  
P.O. BOX 602, PAW CREEK, N.C. 28213 374-1760

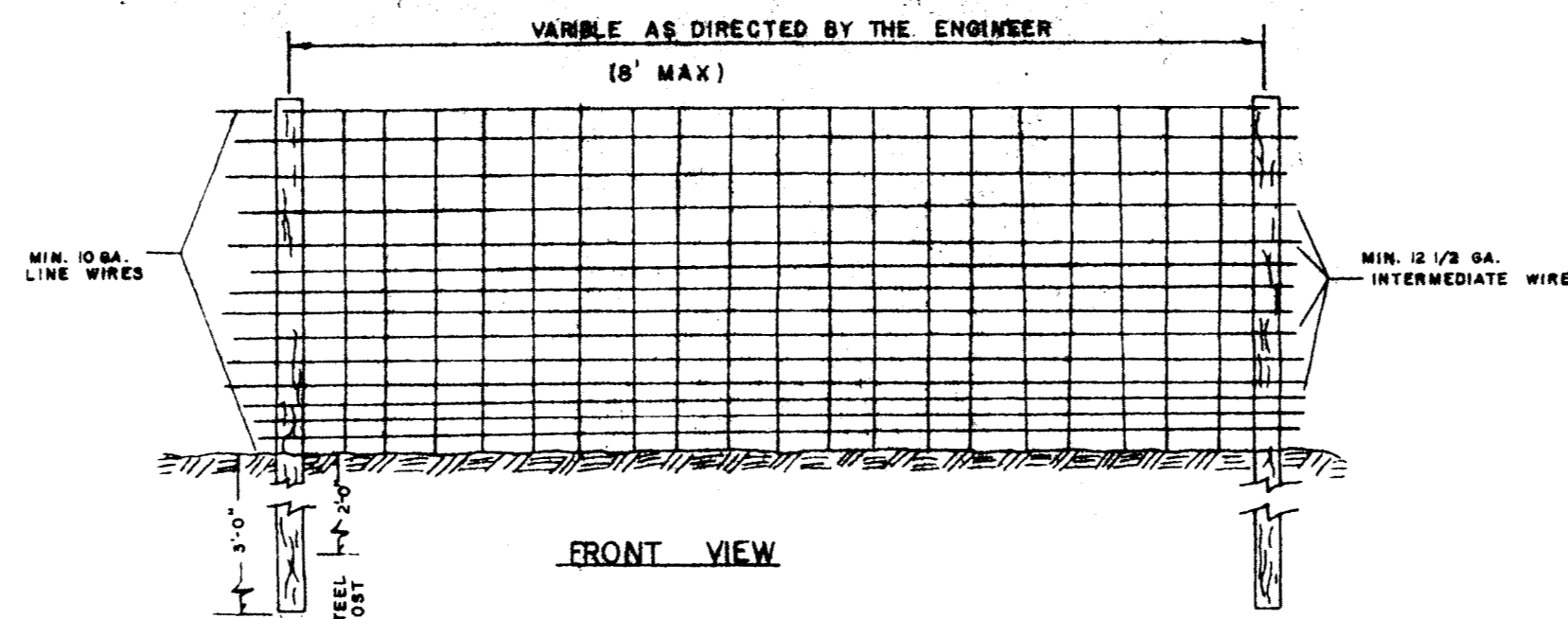

**GENERAL NOTES**  
 FENCE FABRIC SHALL BE A MINIMUM OF 32" IN WIDTH AND SHALL HAVE A MINIMUM OF 6 LINE WIRES WITH 12" STAY SPACING. BURLAP SHALL BE 7/2 OZ. WEIGHT AND A MINIMUM OF 32" IN WIDTH. BURLAP SHALL BE FASTENED ADEQUATELY TO THE FABRIC AS DIRECTED BY THE ENGINEER. MIRAFL 140 FABRIC OR EQUIVALENT MAY ALSO BE USED.  
 STEEL POSTS SHALL BE 5' 0" IN HEIGHT AND BE OF THE SELF-FASTNER ANGLE STEEL TYPE.  
 WOOD POST SHALL BE 6 TO 7 FEET IN HEIGHT AND 3 TO 4 INCHES IN DIAMETER. WIRE FABRIC SHALL BE FASTENED TO WOODEN POST WITH NOT LESS THAN 9 WIRE STAPLES 1 1/2" LONG.

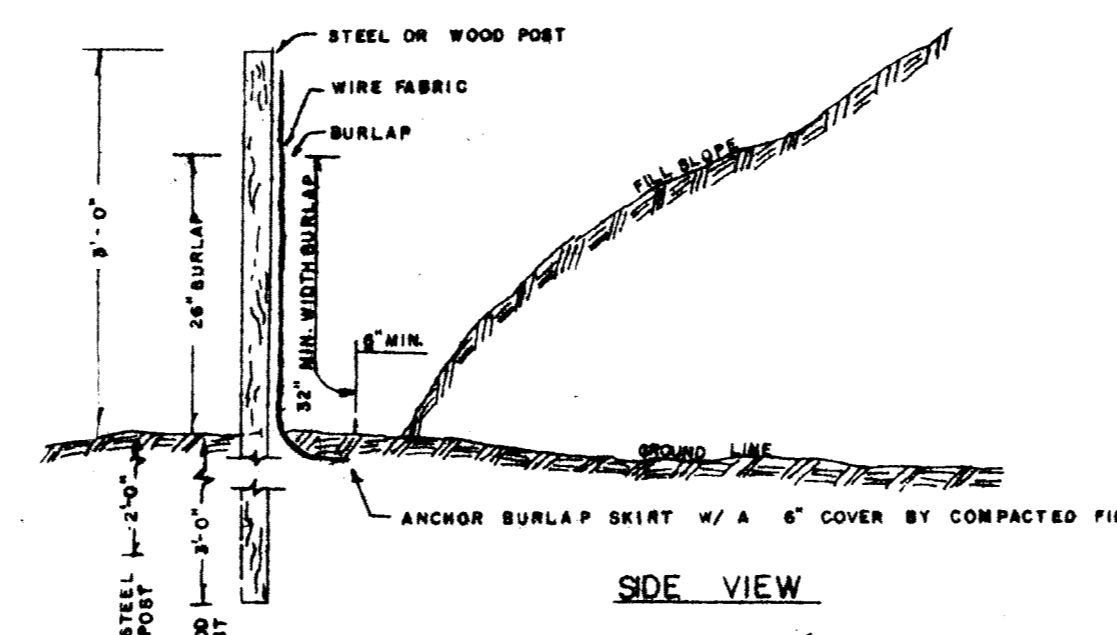

**SILT FENCE**  
 STD. NO. 30.06 80.01

**GRADED SLOPES AND FILLS** - THE ANGLE FOR GRADED SLOPES AND FILLS SHALL BE NO GREATER THAN THE ANGLE WHICH CAN BE RETAINED BY VEGETATIVE COVER OR OTHER ADEQUATE EROSION CONTROL DEVICES OR STRUCTURES. IN ANY EVENT, SLOPES LEFT EXPOSED SHALL, WITHIN 30 WORKING DAYS OF COMPLETION OF ANY PHASE OF GRADING, BE PLANTED OR OTHERWISE PROVIDED WITH GROUND COVER, DEVICES, OR STRUCTURES SUFFICIENT TO RESTRAIN EROSION.

**GROUND COVER** - WHENEVER LAND-DISTURBING ACTIVITY IS UNDERTAKEN ON A TRACT COMPRISING MORE THAN ONE ACRE, IF COVER SUFFICIENT TO RESTRAIN EROSION MUST BE PLANTED OR OTHERWISE PROVIDED WITHIN 30 WORKING DAYS ON THAT PORTION OF THE TRACT UPON WHICH FURTHER ACTIVE CONSTRUCTION IS NOT BEING UNDERTAKEN, PROVIDED THAT THIS SUBSECTION SHALL NOT APPLY TO CLEARED LAND FORMING THE BASIN OF A RESERVOIR LATER TO BE INUNDATED.

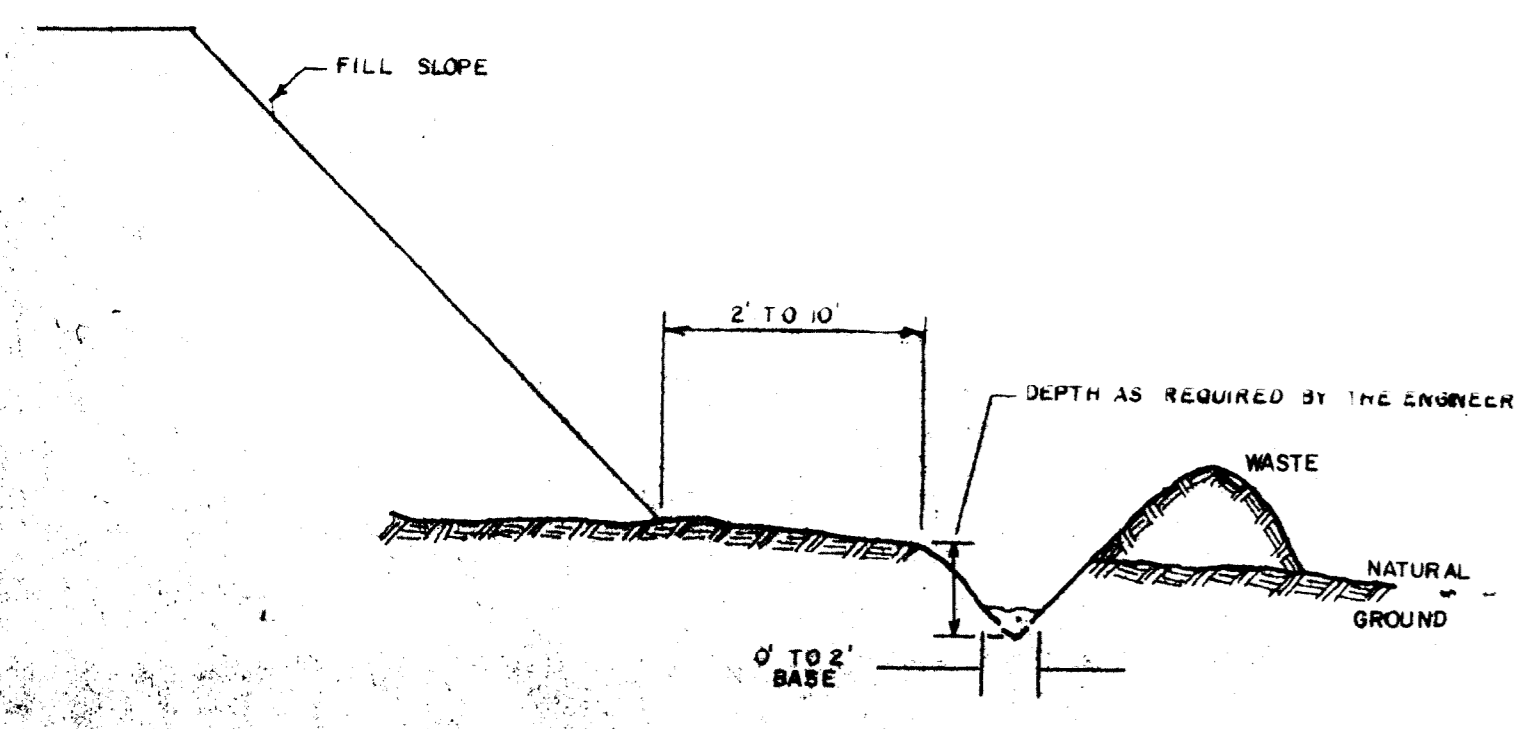

**TEMPORARY SILT DITCH**  
 STD. 60.03

**SEEDING SPECIFICATIONS**

- 1. SLOPES OR FLATTER**  
 1. APPLY AGRICULTURAL LIME AT THE RATE OF 900lb./1000s.f.  
 2. APPLY 10-10-10 COMMERCIAL FERTILIZER AT THE RATE OF 20lb./1000s.f.  
 3. SEED IN ACCORDANCE WITH THE FOLLOWING SCHEDULE AND APPLICATION RATES:
- | DATE     | TYPE   | PLANTING RATE   |
|----------|--|---|
| JULY-NOV | TALL FESCUE  | 300lb./ac. OR 7lb./1000s.f.   |
| NOV-MAR  | TALL FESCUE<br>ABRUZZI RYE                                     | 500lb./ac. OR 7lb./1000s.f.<br>25lb./ac. OR 1/2lb./1000s.f.                               |
| MAR-APR  | TALL FESCUE  | 300lb./ac. OR 7lb./1000s.f.   |
| APR-15   | MULLED COMMON<br>BERMUDAGRASS                                  | 300lb./ac. OR 1lb./1000s.f.   |
| 15-AUG   | TALL FESCUE AND<br>BROWNTOP MILLET OR<br>SORGHUM-SUDAN HYBRIDS | 500lb./ac. OR 7lb./1000s.f.<br>35lb./ac. OR 7lb./1000s.f.<br>30lb./ac. OR 3/4lb./1000s.f. |
4. MULCH WITH STRAW APPLIED AT THE RATE OF 75-100lb./1000s.f.  
 5. HEAVILY MULCHED DURING JANUARY-MARCH PERIOD.

- 2. SLOPES GREATER THAN 3:1 TO 2:1 SLOPES**  
 1. APPLY AGRICULTURAL LIME AT THE RATE OF 50lb./1000s.f.  
 2. APPLY 10-10-10 COMMERCIAL FERTILIZER AT THE RATE OF 20lb./1000s.f.  
 3. SEED IN ACCORDANCE WITH THE FOLLOWING SCHEDULE AND APPLICATION RATES:

DATE	TYPE	PLANTING RATE
MAR-JUN	SERICEA LESPEDEZA (SCARIFIED) AND ADD TALL FESCUE	50lb./ac. OR 1 1/4lb./1000s.f. OR 150lb./ac. OR 3 1/2lb./1000s.f.
MAR-JUNE	ADD WEEPING LOVEGRASS	5lb./ac. OR 1/8lb./1000s.f.
JUNE-SEPT	TALL FESCUE AND BROWNTOP MILLET OR SORGHUM-SUDAN HYBRIDS	60lb./ac. OR 1 1/2 lb./1000s.f. 35lb./ac. OR 7lb./1000s.f. 30lb./ac. OR 3/4 lb./1000s.f.
SEPT-MAR	SERICEA LESPEDEZA (UNHALED-UNSCARIFIED) TALL FESCUE MILLET OR SUDAN	70lb./ac. OR 1 3/4lb./1000s.f. 150lb./ac. OR 3 1/2 lb./1000s.f. 20lb./ac. OR 1/2 lb./1000s.f.

4. MULCH WITH 3" STRAW APPLIED AT THE RATE OF 50-90lb./1000s.f. AND ANCHOR WITH ASPHALT EMULSION TACK COAT APPLIED AT THE RATE OF 1/4-28 GAL./1000s.f. OR 800-1200 GAL./ACRE.

**SEEDBED PREPARATION NOTES**

- SURFACE WATER CONTROL MEASURES TO BE INSTALLED ACCORDING TO PLAN.
- AREAS TO BE SEEDBED SHALL BE RIPPED & SPREAD WITH AVAILABLE TOPSOIL 3" DEEP. TOTAL SEEDBED PREPARED DEPTH SHALL BE 4"-6" DEEP.
- LOOSE ROCKS, ROOTS AND OTHER OBSTRUCTIONS SHALL BE REMOVED FROM THE SURFACE SO THAT THEY WILL NOT INTERFERE WITH ESTABLISHMENT AND MAINTENANCE OF VEGETATION. SURFACE FOR FINAL SEEDBED PREPARATION, AT FINISH GRADES SHOWN, SHALL BE REASONABLY SMOOTH & UNIFORM.
- IF NO SOIL TEST IS TAKEN, FERTILIZER & LIME TO BE ACCORDING TO SEEDING SPECIFICATIONS ABOVE. IN ADDITION, PROVIDE 15lb./1000s.f. OF SUPERPHOSPHATE.
- IF SOIL TEST IS TAKEN, PROVIDE LIME & FERTILIZER ACCORDING TO SOIL TEST REPORT.
- LIME & FERTILIZER SHALL BE APPLIED UNIFORMLY & MIXED WITH THE SOIL DURING SEEDBED PREPARATION.

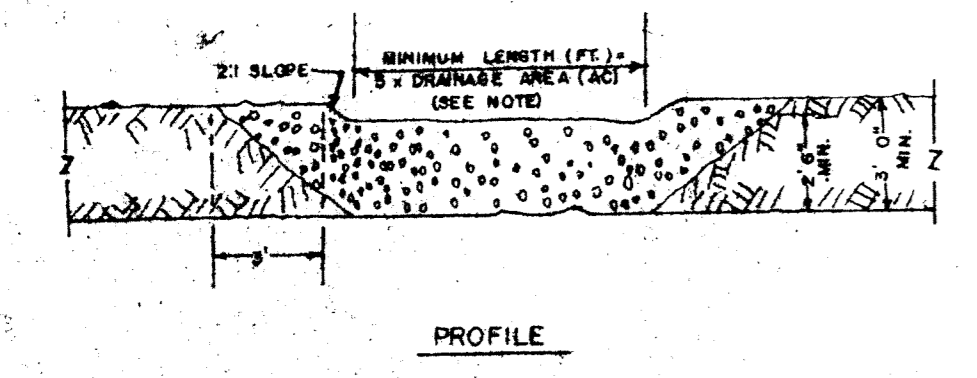
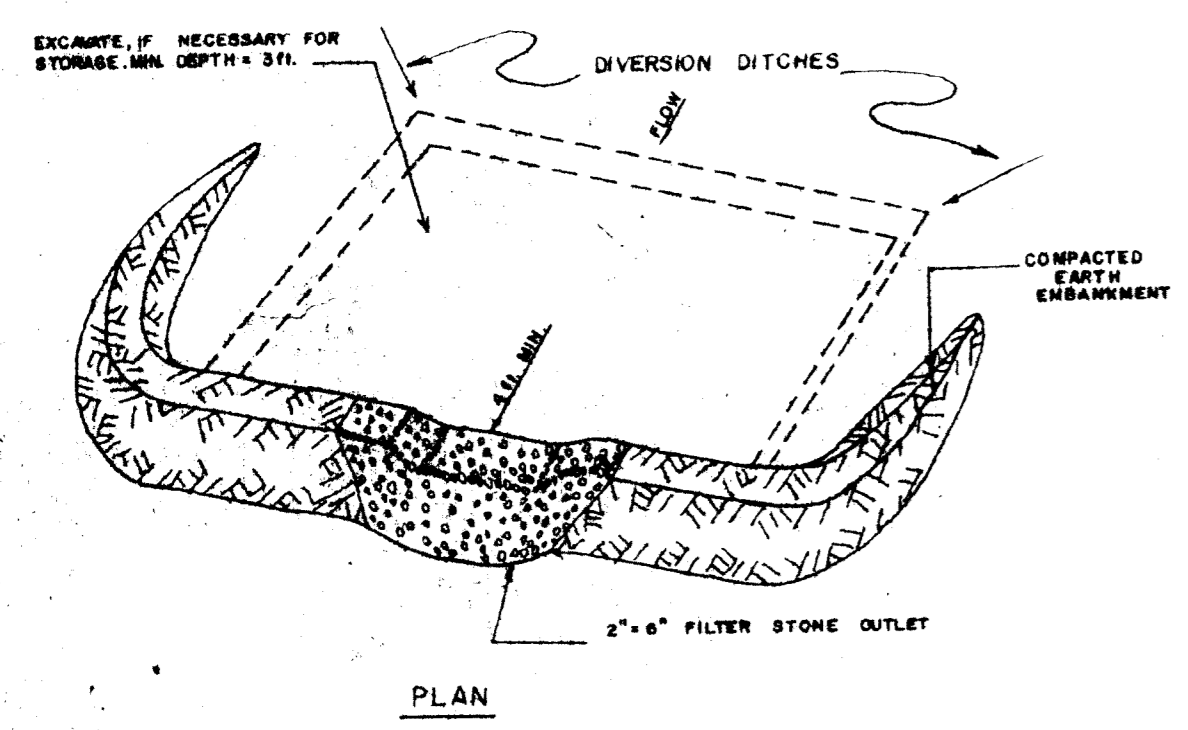

**STONE OUTLET SEDIMENT TRAP**  
 STD. 30.09

ADDITIONAL EROSION CONTROL MEASURES MAY BE REQUIRED DEPENDING ON FIELD CONDITIONS.

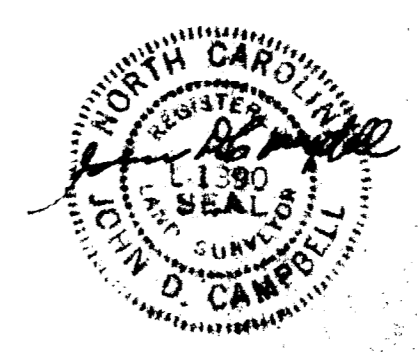

**SOIL EROSION AND SEDIMENT CONTROL PLAN**

PROJECT: A PLAN OF MOBIL HOME RENTAL LOTS AT HUNTLYNN ACRES SECTION 4

SURVEY FOR: HUNTLYNN ASSOCIATES  
 2222 SAM WILSON RD., CHARLOTTE, N.C. 28214

LOCATION: BERRYHILL TOWNSHIP, MECKLENBURG COUNTY, N.C.

SCALE: DATE: DEC. 13, 1985 DRAWN BY: FILE NO.: E.N.C. B-35

1023 SOUTH CALDWELL ST. CHARLOTTE, N.C. 28208  
 JOHN D. CAMPBELL, PLS.