

PETITIONER: JOHN HARDING  
 PETITION NO. 84-45

**NOTE:**

EACH OF THE PLANTING AREAS IMMEDIATELY ADJACENT TO SELWYN AVENUE SHALL CONTAIN A 4" RED OAK TREE.  
 B-1 (CD) AREA OF 2727 SELWYN AVE. = 6,629.625 SF. (1.022 AC)  
 B-1 (CD) AREA OF 2801 SELWYN AVE. = 4,782.000 SF. (1.098 AC)  
 DRAWING REVISED 5-23-84 TO SUPPLEMENT DETAILS OF PLAN AS SUBMITTED MAY 4, 1984  
 DRAWING REVISED 6-15-84 TO ILLUSTRATE BRICK FENCE.

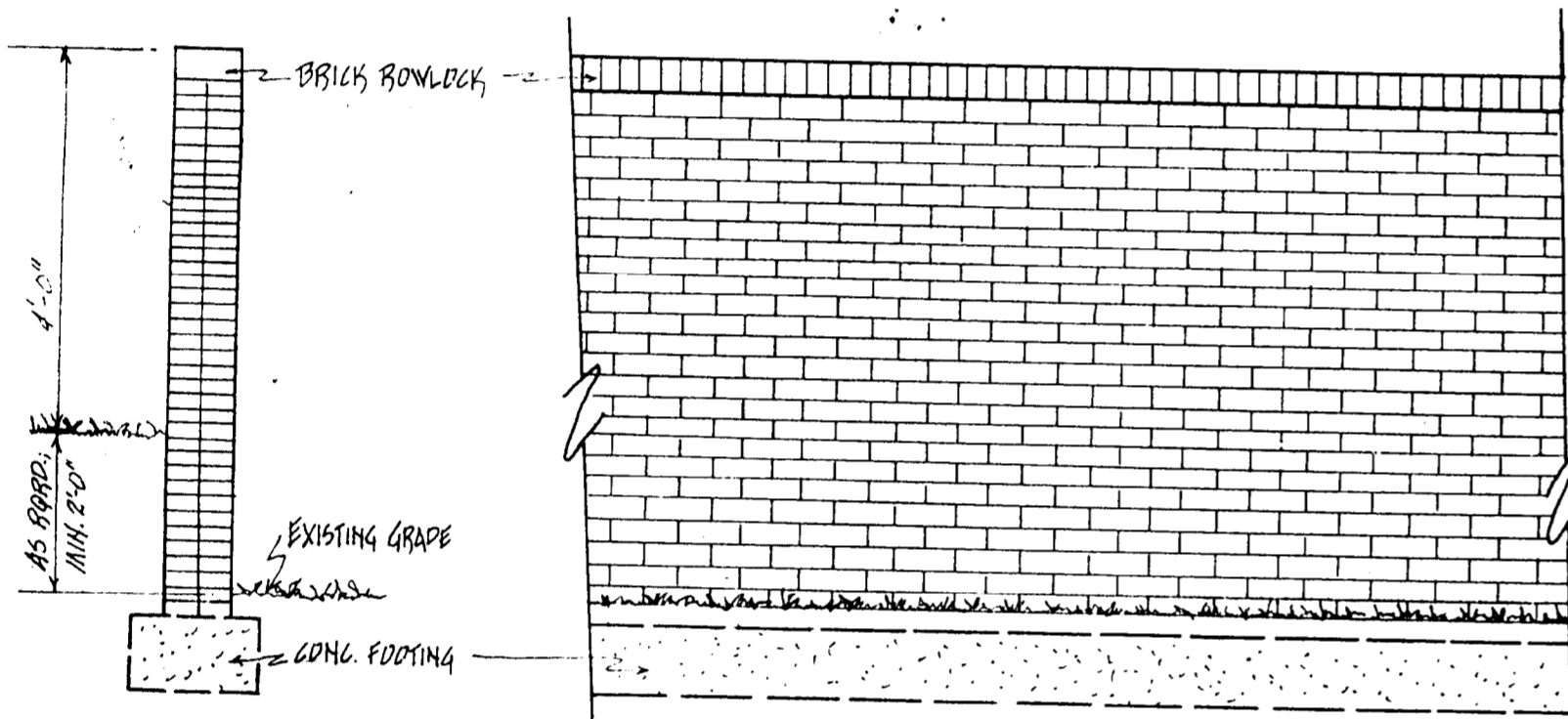

FENCE ELEVATION

FENCE SECTION

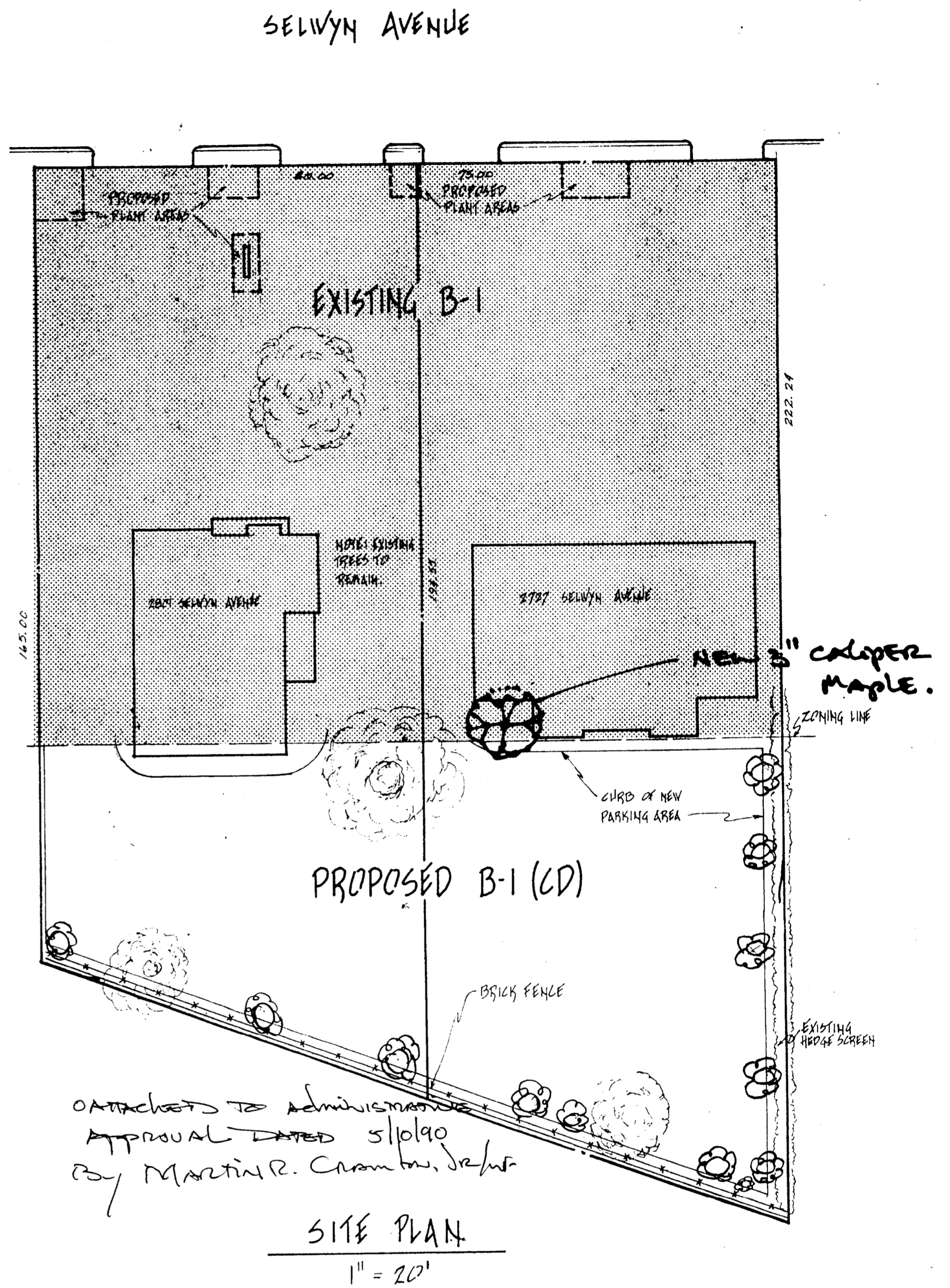

ATTACHED TO ADMINISTRATIVE APPROVAL DATED 5/10/90 BY MARTIN R. CRAMTON, JR.

SITE PLAN  
1" = 20'

CHARLOTTE-MECKLENBURG  
 PLANNING COMMISSION

INTER-OFFICE COMMUNICATION

DATE: May 10, 1990

TO: Robert Brandon  
 Zoning Administrator

FROM: *Martin R. Cramton, Jr.*  
 Martin R. Cramton, Jr.  
 Planning Director

SUBJECT: Administrative Approval for Petition #84-45 by John W. Harding  
 Tax Parcel #175-082-10, 11

Attached is a revised plan for the above mentioned rezoning petition. The plan is being amended to replace a tree that was on the original plan that has died. The tree will be replaced by a new 3" caliper maple as shown on the plan.

Pursuant to my authority as granted by the zoning ordinance, I am administratively amending this plan. Please use this plan when evaluating requests for building permits.

MRC/KHM:sls

Attachment