

~ WHER RENA MARINA, INC ~

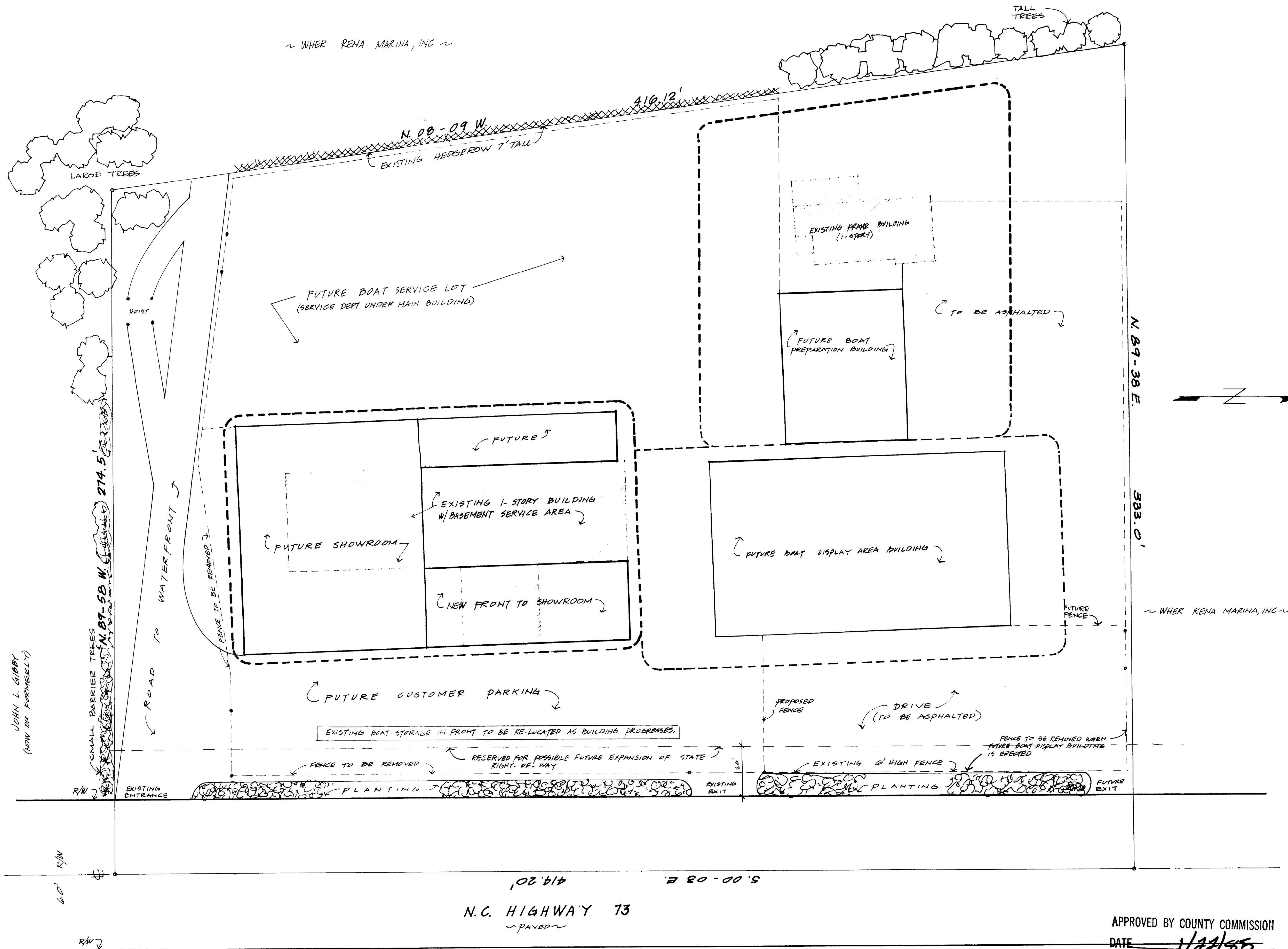

APPROVED BY COUNTY COMMISSION  
DATE 1/22/85

# LAND USE PLAN

FOR

## WHER RENA BOAT SALES

LEMLEY TOWNSHIP, MECKLENBURG COUNTY, N.C.

SCALE: 1"=20'

REQUESTED ZONING CHANGE FROM  
R-R TO D-2 (CD)

- NOTES:
1. TOTAL SITE AREA: 2.88 ACRES
  2. ENTRANCE & IDENTIFICATION SIGNS WILL BE PROVIDED & WILL BE LOCATED ACCORDING TO APPLICABLE ORDINANCE REGULATIONS.
  3. ACCESSORY FACILITIES NORMALLY ASSOCIATED WITH THIS TYPE OF DEVELOPMENT (SUCH AS DUMPSTERS, SERVICE AREAS, ELEC. TRANSFORMERS) WILL BE ALLOWED.
  4. EXACT LOCATIONS OF ISLANDS IN PARKING LOTS ARE SUBJECT TO CHANGE DEPENDING ON SITE CONDITIONS. (I.E. TREE LOCATION, PROPOSED GRADES, ETC.)
  5. EXPANSION WILL OCCUR IN PHASES
  6. EXISTING BOAT STORAGE IN FRONT TO BE RE-LOCATED AS BUILDING PROGRESSES
  7. ARCHITECTURAL CONTINUITY WILL BE CARRIED OUT TO EACH BUILDING.
  8. PERMITTED ACTIVITIES ON THIS SITE TO BE: BOAT SALES, BOAT REPAIRS, & ACCESSORY SALES.

84-050(c)