



* 0 0 B R E A K 0 0 *



**ADVANCED
IMAGING
SYSTEMS**

www.aisimc.com

An Information
Management Company

City of Charlotte – Planning Dept. Scanning Rezoning Files

Petition # _____

Document type:

- Applications
- Correspondence
- Department Comments
- Land Use Consistency
 - Mail Info
 - Mapping
 - Other
- Site Plans



* 0 0 B R E A K 0 0 *

PETITIONER Robert Young and T. Redmond

PETITION NO. 85-11 HEARING DATE February 18, 1985

ZONING CLASSIFICATION, EXISTING R-9MF REQUESTED R-9

LOCATION The area along both sides of Finchley Drive between Shamrock Drive and Jennie Linn Drive

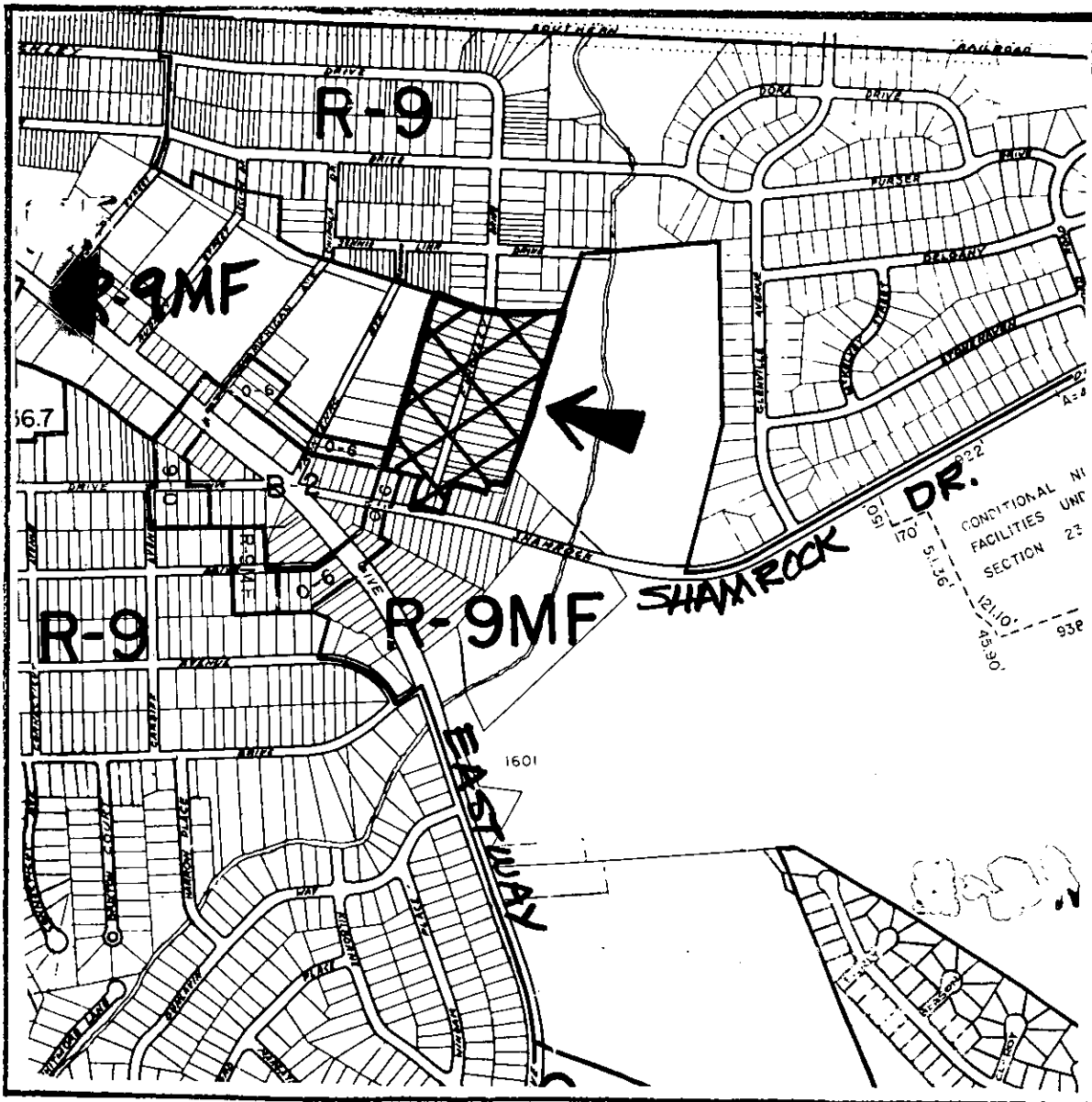

ZONING MAP NO. 20

SCALE 1" = 800'

PROPERTY PROPOSED FOR CHANGE



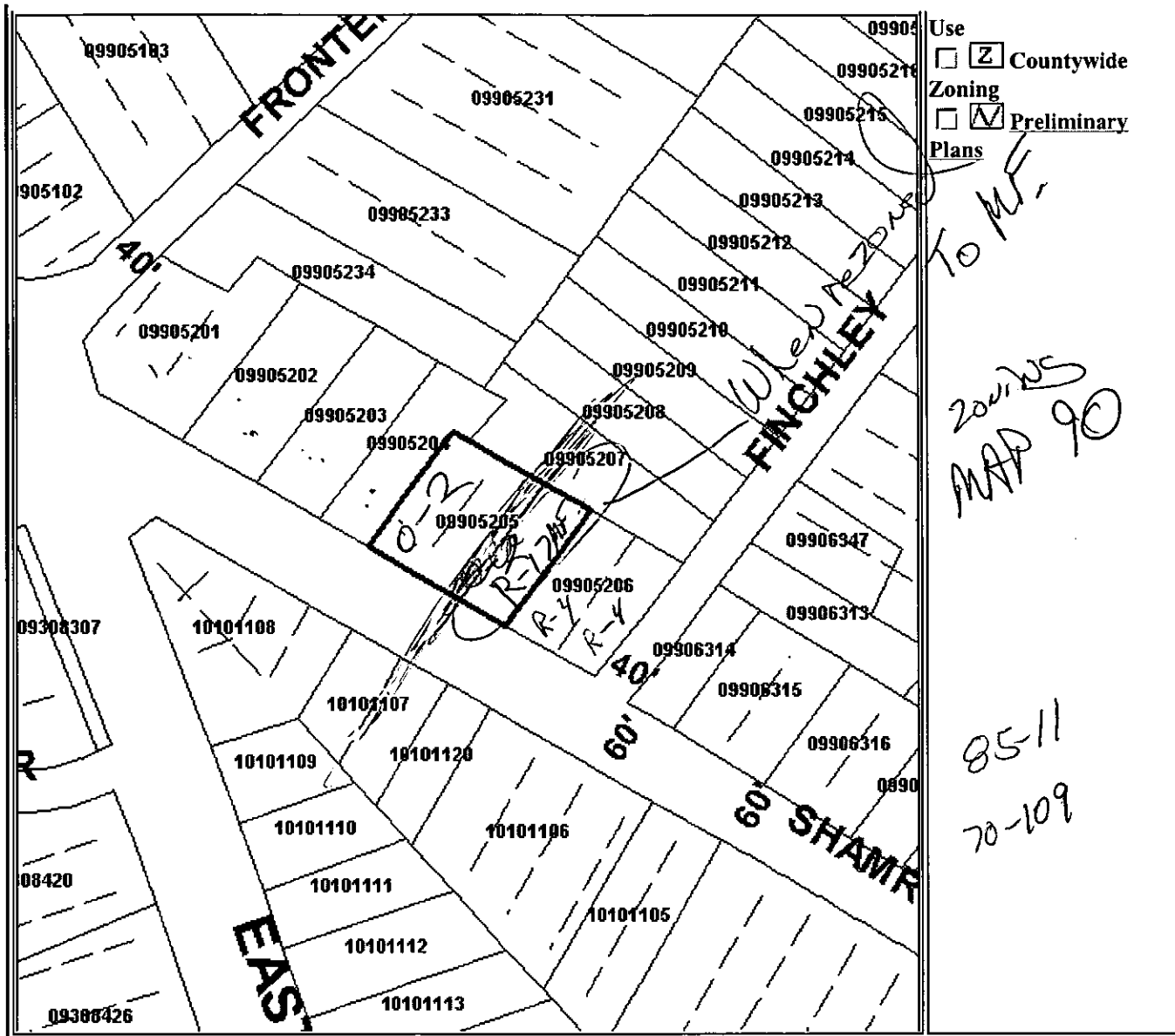

Click here to submit questions or comments about the information shown on this page.
Additional Tax Information (Tax Bills, Real and Personal Property, etc.) is available through the:

[Tax Information System](#)

Map Scale: 1 Inch = 157 Feet Date and Time Stamp 5/2/2002 8:09:36 AM EST	This map is prepared for the inventory of real property within Mecklenburg County and is compiled from recorded deeds, plats, tax maps, surveys, planimetric maps, and other public records and data. Users of this map are hereby notified that the aforementioned public primary information sources should be consulted for verification. Mecklenburg County and its mapping contractors assume no legal responsibility for the information contained herein.
--	--

Tax Real Estate Information	
BUILDING PHOTOS ARE NOW AVAILABLE! SEE MAJOR IMPROVEMENT SECTION BELOW FOR LINK.	
*** Images of real estate documents from the Register of Deeds are available from 11/9/1998 to the present. ***	
Parcel-Id#: 09905205 GIS Map#: 09905205 Account Type: INDIVIDUAL	Legal Desc.: P9-11 BE M3-280 Deed Book/Page: 08781/252 Date: 10/16/1996

Owner: TUCKER EFTEHEA CHONIS Add. Owner: Mailing: 2779 ASBURY LN Address: City: WINSTON-SALEM State: NC ZIP: 27103 Location: SHAMROCK DR Municipality: CHARLOTTE	Sales Price: \$0 Sales Date: 10/16/1996 Qualified Sale: N Neighborhood Code: 09901 Historic Desig.: Farm Desig.: Deed Acreage: 0 Assessed Acreage: 0.455 Assessed Land Value: \$38000 Total Assessed Value: \$38000 Tax Bill Information: Click Here!
--	--

Site Location Information

Zoning: R-17MF and O-2 Fire District: N/A Voter District: Click to Find Out School District: Click to Find Out Reg. Watershed Class: N/A	Parks Within 3 Miles: Click to Find Out FEMA Flood Panel#: 3701590009B More Flood Information FEMA Flood Zone: OUT FEMA Flood Map Date: 03/02/1993 Census Tract Number: 001604
---	---

Major Improvement Information

Parcel-Id# & Card#: 09905205-001 Land-Use Type: VACANT Building Type: OFFICE Approximate Square Footage: 0 Actual Year Built: 0 Number of Stories: Bedrooms: 0 Bathrooms: 0 Restrooms: 0	Situs Location: SHAMROCK DR Ext. Type: Heating Type: AC Type: Fireplace: Garage: N Basement: N Assessed Net Bldg. Value: \$0 Total Assessed Bldg. Value: \$0
---	---

This site is powered by



MapObjects2 Internet Map Server



This site was developed by [Mecklenburg County GIS](#) and was last updated on 5/1/2002 7:37:59 AM