



* 0 0 B R E A K 0 0 *



**ADVANCED
IMAGING
SYSTEMS**

www.aisimc.com

An Information
Management Company

City of Charlotte – Planning Dept. Scanning Rezoning Files

Petition # 1985-65

Document type:

- Applications
- Correspondence
- Department Comments
- Land Use Consistency
 - Mail Info
 - Mapping
 - Other
- Site Plans



* 0 0 B R E A K 0 0 *

OFFICIAL REZONING APPLICATION

CITY OF CHARLOTTE

Petition No.	<u>85-65</u>
Date Filed	<u>8/1</u>
Received By	<u>JCL</u>
OFFICE USE ONLY	

Ownership Information

Property Owner SHARON FOREST BAPTIST CHURCH
Owner's Address 7300 WALLACE LANE
CHARLOTTE, N.C. 28212
Date Property Acquired 1955
Deed Reference 2771-283 Tax Parcel Number 165-111-17

Location Of Property (address or description) 7300 WALLACE LANE

Description Of Property

Size (Sq. Ft.-Acres) 11,250 Sq. Ft. Street Frontage (ft.) 142.38
Current Land Use PARKING LOT

Zoning Request

Existing Zoning R-9 Requested Zoning B-2
Purpose of zoning change COMPLETE LOT TO SAME ZONING B-2 DUE TO SALE OF
PROPERTY AND PURCHASERS WANT CONSISTENT ZONING

NANCY D. FOGLE
Name of Agent
4631 SUNLEA LANE, CHARLOTTE, N.C. 28212
Agent's Address
337-4057
Telephone Number

Name of Petitioner(s)

Address of Petitioner(s)

Telephone Number
Rev. David Trammell
Signature

Signature of Property Owner if Other
Than Petitioner

CONVENTIONAL REZONING APPLICATION FILING REQUIREMENTS:

1. two signed official applications;
2. two survey maps delineating the property in question;
3. a list of all adjacent property owners, with their current mailing addresses coded to the survey map or tax map (this information is available at the Mecklenburg County Tax Office, 720 East Fourth Street);
4. a filing fee of one hundred dollars (\$100.00) to help defray administrative expenses (checks payable to the Charlotte-Mecklenburg Planning Commission); and
5. a written boundary description showing distances and bearings of property lines (a metes and bounds description).

CONDITIONAL DISTRICT REZONING APPLICATION FILING REQUIREMENTS:

1. two signed application forms;
 2. a filing fee of one hundred dollars (\$100.00) to help defray administrative expenses (checks payable to the Charlotte-Mecklenburg Planning Commission);
 3. ten (10) copies of a schematic site plan, drawn to scale and at a minimum size of 24" x 36," which includes the following items (ten copies are needed for interdepartmental review):
 - (a) a boundary survey showing the total acreage, present zoning classification(s), date, and north arrow;
 - (b) adjoining property lines and names, addresses, and tax parcel numbers of current adjoining property owners (this information is available at the Mecklenburg County Tax Office, 720 East Fourth Street);
 - (c) all existing easements, reservations, and rights-of-way, and all yards required for the zoning district requested (show setback, side and rear yard requirements for proposed zoning district);
 - (d) proposed use of land and structures: for residential uses this shall include the number of units and an outline of the area within which the structures will be located; for non-residential uses, this shall include approximate square footage of structures and an outline of the area within which the structures will be located;
 - (e) traffic, parking, and circulation plan, showing proposed locations and arrangement of parking spaces and entrance and exit to adjacent streets (show existing and proposed parking, what is required, and what is to be provided);
 - (f) proposed screening, including walls, fences, or planting areas, as well as treatment of any existing natural features, or a statement specifying that buffering and/or screening will conform to City/County Zoning Ordinance requirements;
 - (g) the proposed number of signs and their locations, or a statement specifying that all signs will conform to City/County Zoning Ordinance requirements;
 - (h) generalized information as to the number, height, size, or in especially critical situations, the location of structures;
 - (i) proposed phasing, if any, and approximate completion time of the project;
 - (j) delineation of areas within the regulatory floodplain as shown on the official Charlotte flood areas map;
 - (k) topography at four foot contour intervals or less (existing and proposed);
 - (l) schematic site plan must be titled with project name and proposed use;
 - (m) size of schematic site plan not to exceed 42" in width;
 4. a list of all adjacent property owners with current addresses coded to the schematic site plan; and
 5. a written boundary description showing distances and bearings of property lines (a metes and bounds description).
-

PETITIONER Sharon Forest Baptist Church

PETITION NO. 85-65 HEARING DATE September 16, 1985

ZONING CLASSIFICATION, EXISTING R-9 REQUESTED B-2

LOCATION An 11,250 square foot site at 7300 Wallace Lane.

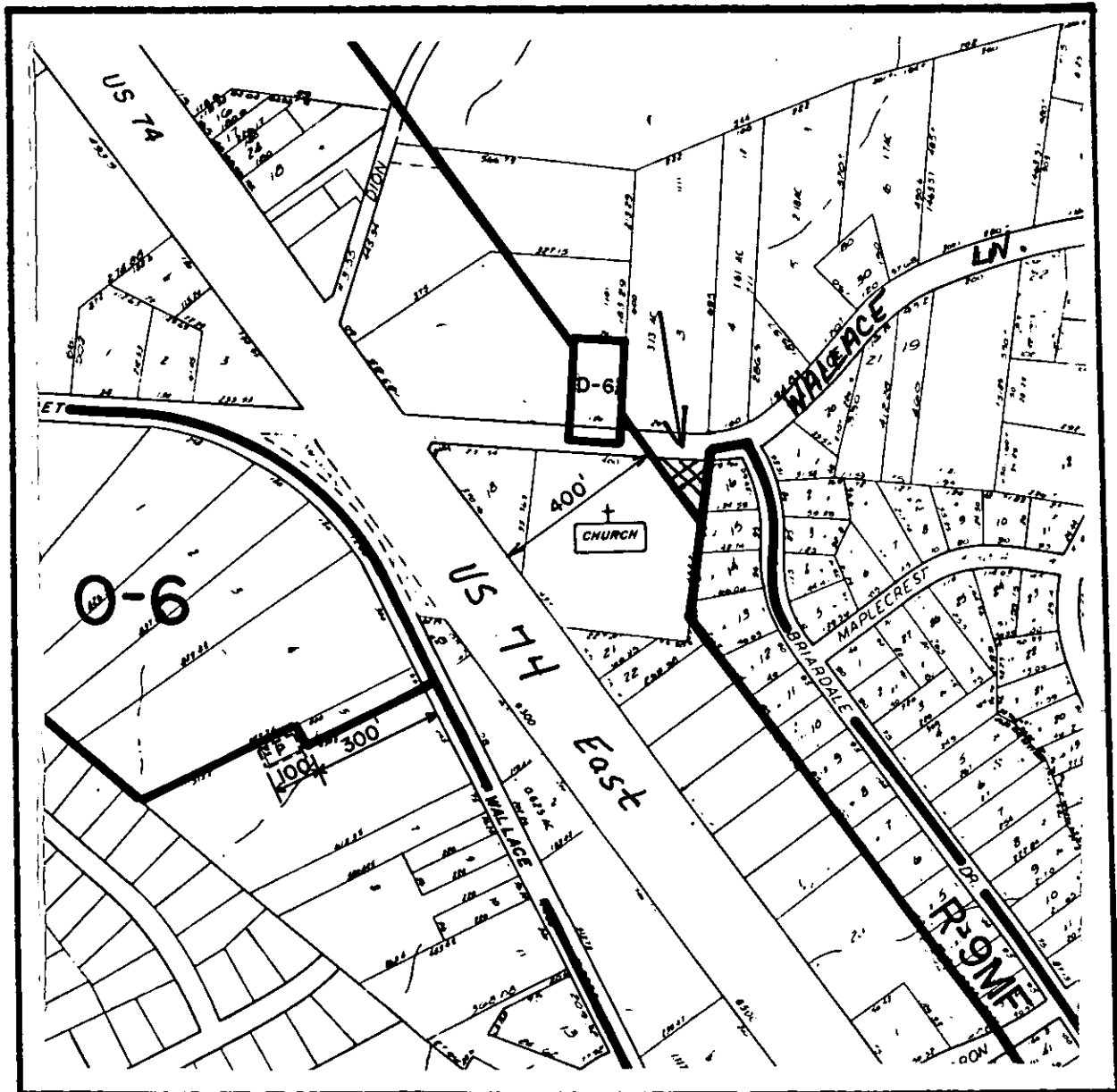

ZONING MAP NO. 123

SCALE 1" = 400'

PROPERTY PROPOSED FOR CHANGE

