

NOTES:

1. REZONING REQUEST: B-2 to B-2 (CD)

2. CONDITIONS OF REZONING:

- A.) A 10' SOLID, LANDSCAPED BUFFER WILL BE PROVIDED ALONG ALL PROPERTY LINES ABUTTING RESIDENTIAL ZONING ON RUSSELL PROPERTY.
- B.) SIGNS WILL BE DESIGNED AND INSTALLED IN ACCORDANCE WITH COUNTY SIGN ORDINANCE WITH THE EXCEPTION THAT BILLBOARDS WILL NOT BE PERMITTED ON THE PROPERTY.
- C.) ALL B-2 USES WILL BE PERMITTED EXCEPT THE FOLLOWING:
 - 1.- TRAILER, OVERNIGHT CAMPING
 - 2.- AMUSEMENT, COMMERCIAL, OUTDOORS
 - 3.- ARMORIES
 - 4.- AUTOMOBILE AND TRUCK RENTALS
 - 5.- SELF-SERVICE AUTOMOBILE LAUNDRIES
 - 6.- AUTOMOBILE REPAIR GARAGES (RUSSELL PROPERTY ONLY)
 - 7.- AUTOMOBILE, NEW AND USED, RETAIL AND WHOLESALE SALES AND REPAIR
 - 8.- BOATS, RETAIL SALES AND REPAIR
 - 9.- EXTERMINATORS
 - 10.- FABRIC SAMPLES ASSEMBLY (RUSSELL PROPERTY ONLY)
 - 11.- FENCES AND FENCE MATERIAL, RETAIL SALES
 - 12.- FERTILIZER, PACKAGED RETAIL SALES
 - 13.- FROZEN FOOD LOCKERS
 - 14.- MARINAS
 - 15.- MOBILE HOME SALES
 - 16.- MOTORCYCLES, RETAIL SALES AND REPAIR
 - 17.- PARKING LOTS AND PARKING STRUCTURES (COMMERCIAL)
 - 18.- PAWN SHOPS AND SECOND HAND GOODS, RETAIL SALES
 - 19.- SIGN PAINTING EXCLUSIVE OF MANUFACTURE
 - 20.- TRAILERS, OVERNIGHT CAMPING, RETAIL AND WHOLESALE SALES, RENTAL AND REPAIR
 - 21.- TRAILERS, UTILITY OR HAULING, RETAIL SALES AND RENTAL
 - 22.- TRUCKS, RETAIL AND WHOLESALE SALES, RENTAL AND SERVICE
 - 23.- DAIRY PRODUCTS PROCESSING
 - 24.- RIDING STABLES AND ACADEMIES
 - 25.- MASSAGE PARLORS

D.) PARKING SHALL BE IN ACCORDANCE WITH ORDINANCE REQUIREMENTS

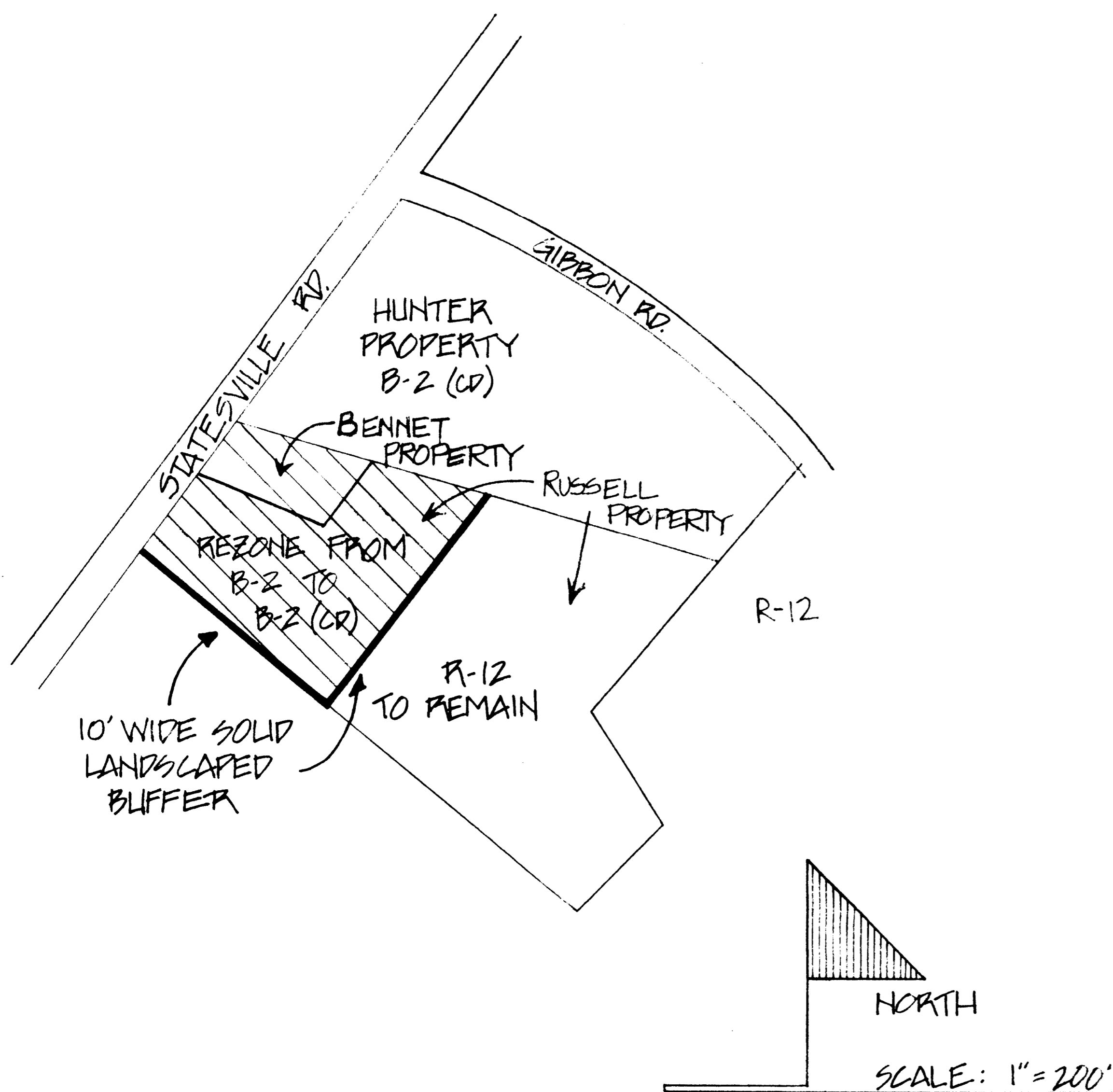

M. Russell and Charles Bennett Properties
Conditional Plan

APPROVED BY COUNTY COMMISSION
DATE 12-1-86