

LOCATION MAP

- APPROXIMATE LOCATION FOR:
- ① STADIUM - MAX. HEIGHT = 40'
 - ② MAINTENANCE ROAD
 - ③ PARKING

PARCEL No. 143-14-08
18.8 AC. YORKMONT RD.
MRS. ELIZABETH PRICE GRAHAM
1301 AYLESFORD RD.
CHARLOTTE, N.C. 28211

PROPOSED TRACT "B"
56,747 SF = 1.303 AC
ZONE R9

APPROVED BY CITY COUNCIL
DATE 5-18-87

PARCEL No. 143-13-01
61 AC. YORKMONT RD.
CITY OF CHARLOTTE
600 E TRADE ST.
CHARLOTTE, N.C. 28202
ZONE R9

- INDEX
- 1 SITE PLAN
 - 2
 - 3
 - 4
 - 5

PROPOSED TRACT "C"
44,282 SQ. FT. = 1.017 AC.
RESERVED FOR FUTURE DEVELOPMENT

- LEGEND
- EARTH
 - SAND
 - CONCRETE
 - INSULATION
 - STEEL
 - G GAS
 - W WATER
 - 3ES 3PHASE ELECTRICAL SERVICE
 - ESE ELECTRICAL SERVICE ENTRANCE
 - SD DRAIN LINE
 - CB CATCH BASIN
 - FENCE
 - YH YARD HYDRANT

47' 10" North

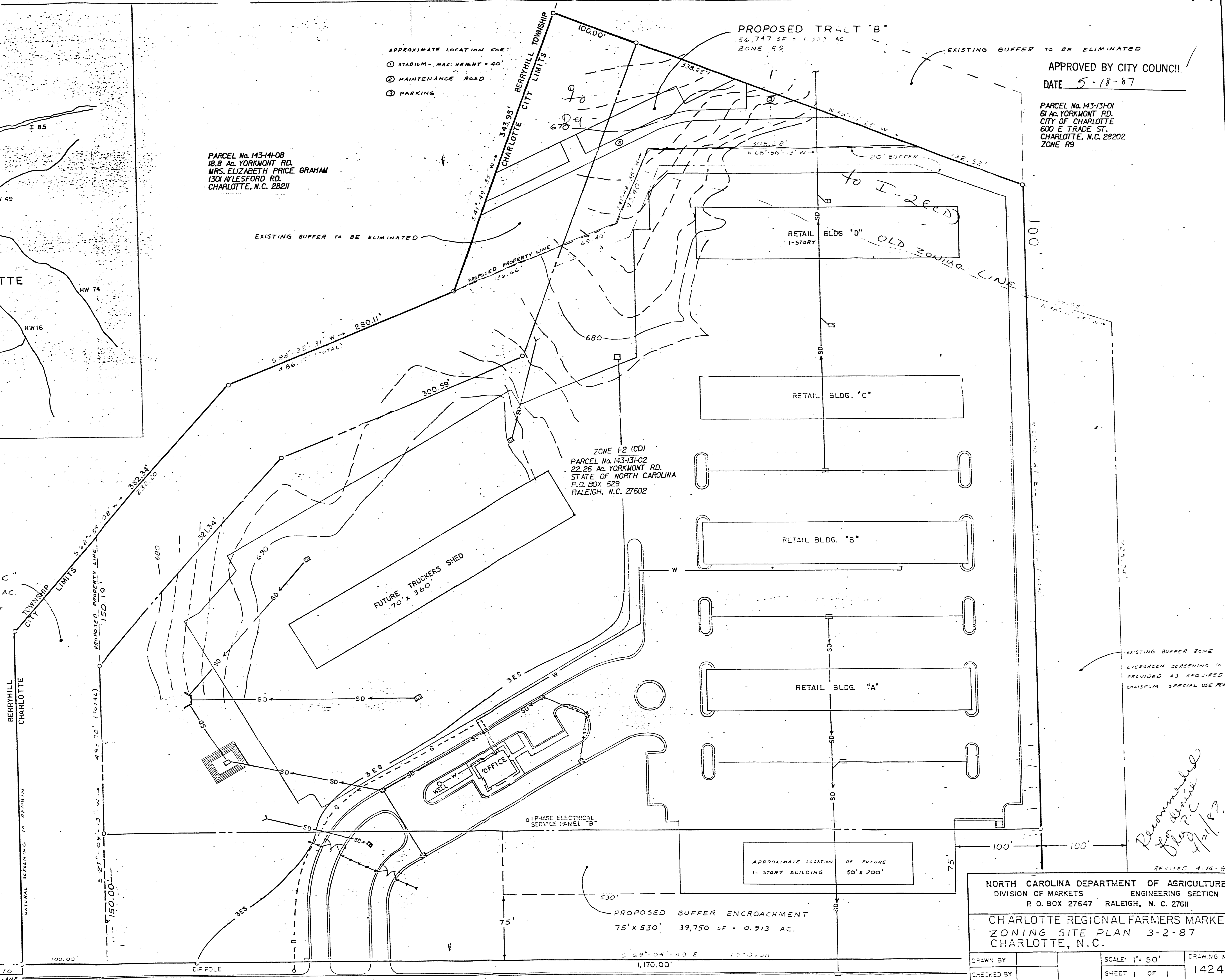

EXISTING BUFFER ZONE
EVERGREEN SCREENING TO BE PROVIDED AS REQUIRED BY COLOSSEUM SPECIAL USE PERM.

Recommended for plan P.C. 4/21/87

REVISED 4-14-87

NORTH CAROLINA DEPARTMENT OF AGRICULTURE
DIVISION OF MARKETS ENGINEERING SECTION
P. O. BOX 27647 RALEIGH, N. C. 27611

CHARLOTTE REGIONAL FARMERS MARKET
ZONING SITE PLAN 3-2-87
CHARLOTTE, N.C.

DRAWN BY	SCALE: 1" = 50'	DRAWING NO.
CHECKED BY	SHEET 1 OF 1	1424