



* 0 0 B R E A K 0 0 *



ADVANCED
IMAGING
SYSTEMS

www.aisimc.com

An Information
Management Company

City of Charlotte – Planning Dept. Scanning Rezoning Files

Petition # _____

Document type:

- Applications
- Correspondence
- Department Comments
- Land Use Consistency
 - Mail Info
 - Mapping
 - Other
- Site Plans



* 0 0 B R E A K 0 0 *

PETITIONER Plantation Pointe Development Company

PETITION NO. 88-39(c) HEARING DATE 7/11/88

ZONING CLASSIFICATION, EXISTING RR REQUESTED R-20MF(CD)

LOCATION Approx. 4.09 acres located off N.C. 49 (York Road) at the end of Woolwine Road on Lake Wylie.

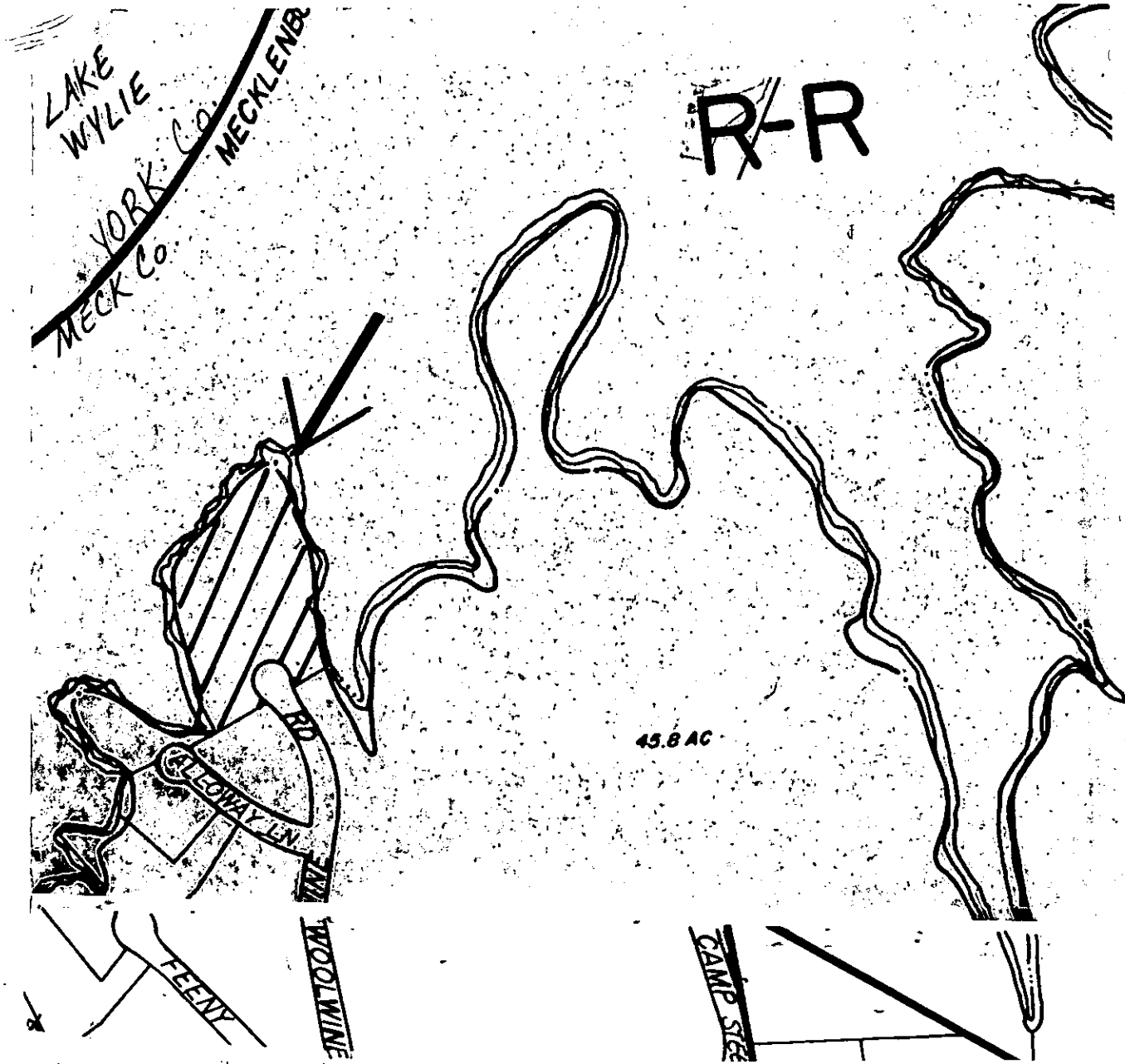

ZONING MAP NO. 153 & 172

SCALE 1" = 400'

PROPERTY PROPOSED FOR CHANGE

