

OFFICIAL REZONING APPLICATION  
MECKLENBURG COUNTY

Petition No. 89-38(E)  
Date Filed August 7, 1989  
Received By MM  
OFFICE USE ONLY

Ownership Information

Property Owner HERSHELL D. PORTER  
Owner's Address 129 MARGO DRIVE  
CHARLOTTE, N.C. 28214  
Date Property Acquired 1982 & 1989  
Tax Parcel Number 053-143-15 (E5)

Location Of Property (address or description) 3710/3722 PERFORMANCE RD

Description Of Property

Size (Sq. Ft./Acres) 6.2490 Street Frontage (ft.) 798.38  
Current Land Use AT 3722 JANGO INC (AIRPORT RENTAL CAR Light Body Repair)  
AT 3710 Metro Woodcraft (CUSTOM CASEWORKS - COMMERCIAL)

Zoning Request

Existing Zoning I1CD AT 3722 Requested Zoning I1CD RECLASSIFY  
B-D AT 3710 I1CD QUALIFIED USES  
Purpose of Zoning Change TO PERMIT QUALIFIED USES UNDER I1CD

Name Of Agent \_\_\_\_\_ Name of Petitioner(s) HERSHELL D. PORTER  
Agent's Address \_\_\_\_\_ Address of Petitioner(s) 129 MARGO DRIVE  
Telephone Number \_\_\_\_\_ Telephone Number DAY 554-2728 EVE 399-9838  
Signature \_\_\_\_\_ Signature

Signature of Property Owner if Other Than Petitioner

PETITIONER Herschell D. Porter

PETITION NO. 89-38(c)

HEARING DATE October 9, 1989

ZONING CLASSIFICATION, EXISTING B-D & I-1(CD) REQUESTED I-1(CD) and I-1(CD) Site Plan Amendment

LOCATION Approximately 6.2 acres located on the north side of Performance Road north of I-85 located in the western portion of Mecklenburg County.

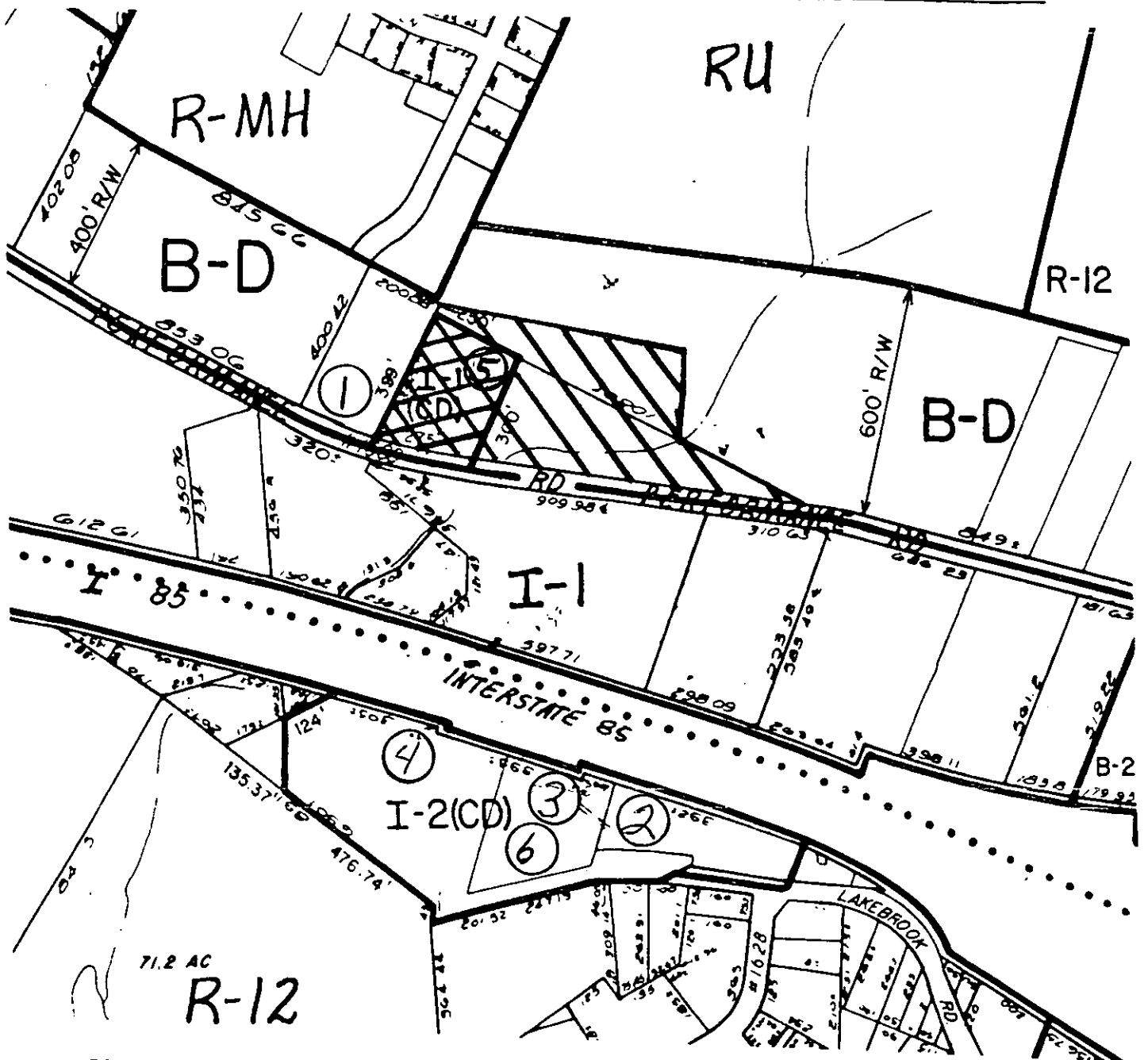

ZONING MAP NO. 83

SCALE 1" = 400'

PROPERTY PROPOSED FOR CHANGE

