

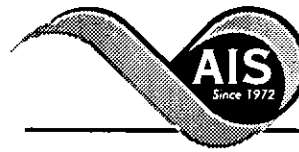

* 0 0 B R E A K 0 0 *



**ADVANCED
IMAGING
SYSTEMS**

www.aisimc.com

An Information
Management Company

City of Charlotte – Planning Dept. Scanning Rezoning Files

Petition # _____

Document type:

- Applications
- Correspondence
- Department Comments
- Land Use Consistency
 - Mail Info
 - Mapping
 - Other
- Site Plans



* 0 0 B R E A K 0 0 *

PETITIONER Summitt Properties
 PETITION NO. 90-8(c) HEARING DATE February 12, 1990
 ZONING CLASSIFICATION, EXISTING R-15 REQUESTED R-12MF(CD)
 LOCATION Approximately 44.4 acres located on the southeasterly corner of Pineville-Matthews Road (N.C. 51) and Hugh Forest Road.

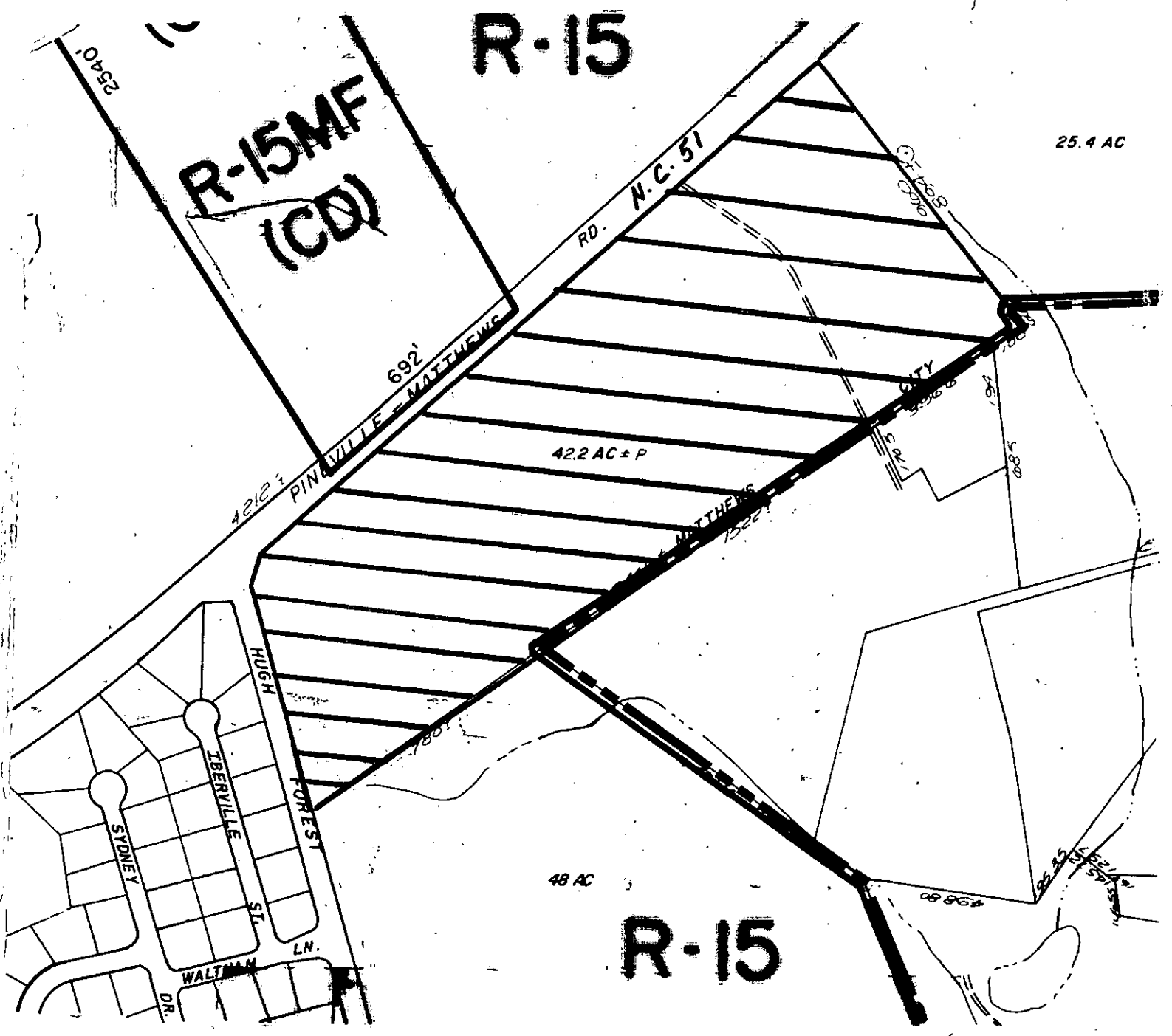

ZONING MAP NO. 160

SCALE 1" = 400'

PROPERTY PROPOSED FOR CHANGE

