

PARKING REQUIREMENTS

DESCRIPTION	TOTAL AREA	REQUIREMENT OF AREA	EMPLOY. SPALES	REQ. SPALES
AREA I	2400 S.F.	2400 S.F.	-	8
AREA II	1200 S.F.	800 S.F.	2	5
TOTAL REQUIRED:				13
TOTAL AVAILABLE:				16

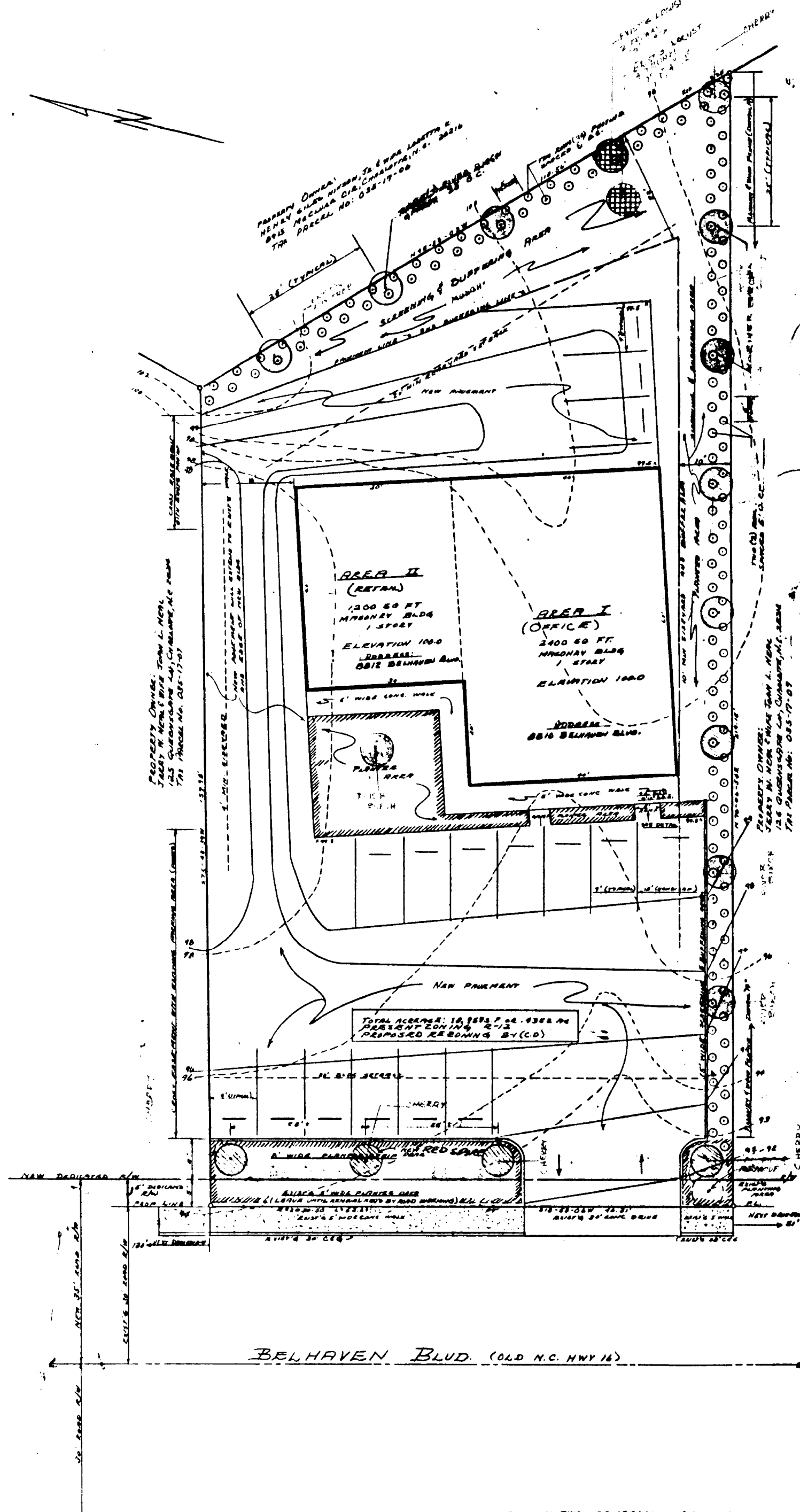

PLANT LIST

QTY	SCIENTIFIC NAME	COMMON NAME	SIZE	REMARKS	SYMBOL
117	PHOTINA ERBSEI OR PHOTINA DE HEALEN	PHOTINA DE HEALEN	3" GAL	FULLY BRANCHED	○
4	KUWASON CEREY	LUCKY	2" CAL	B & B	○
2	LUCKY	LUCKY (EXIST'G)	0.5" CAL	EXIST'G	○
5	HERITAGE RIVER BIRCH	RIVER BIRCH	2" CAL (NEW)		○

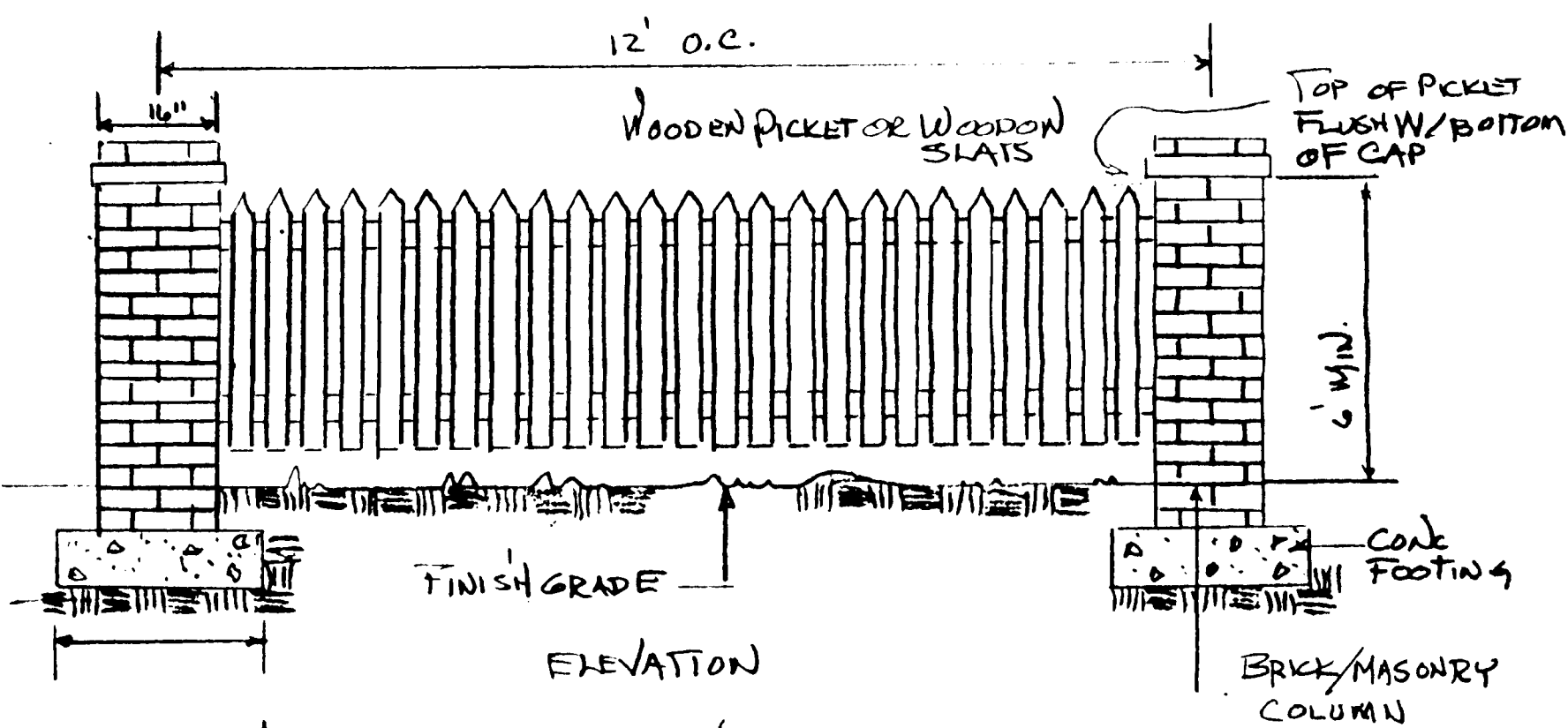

MASONRY AND WOOD FENCE
SCALE: 1/4" = 1'-0"
DETAIL "A"

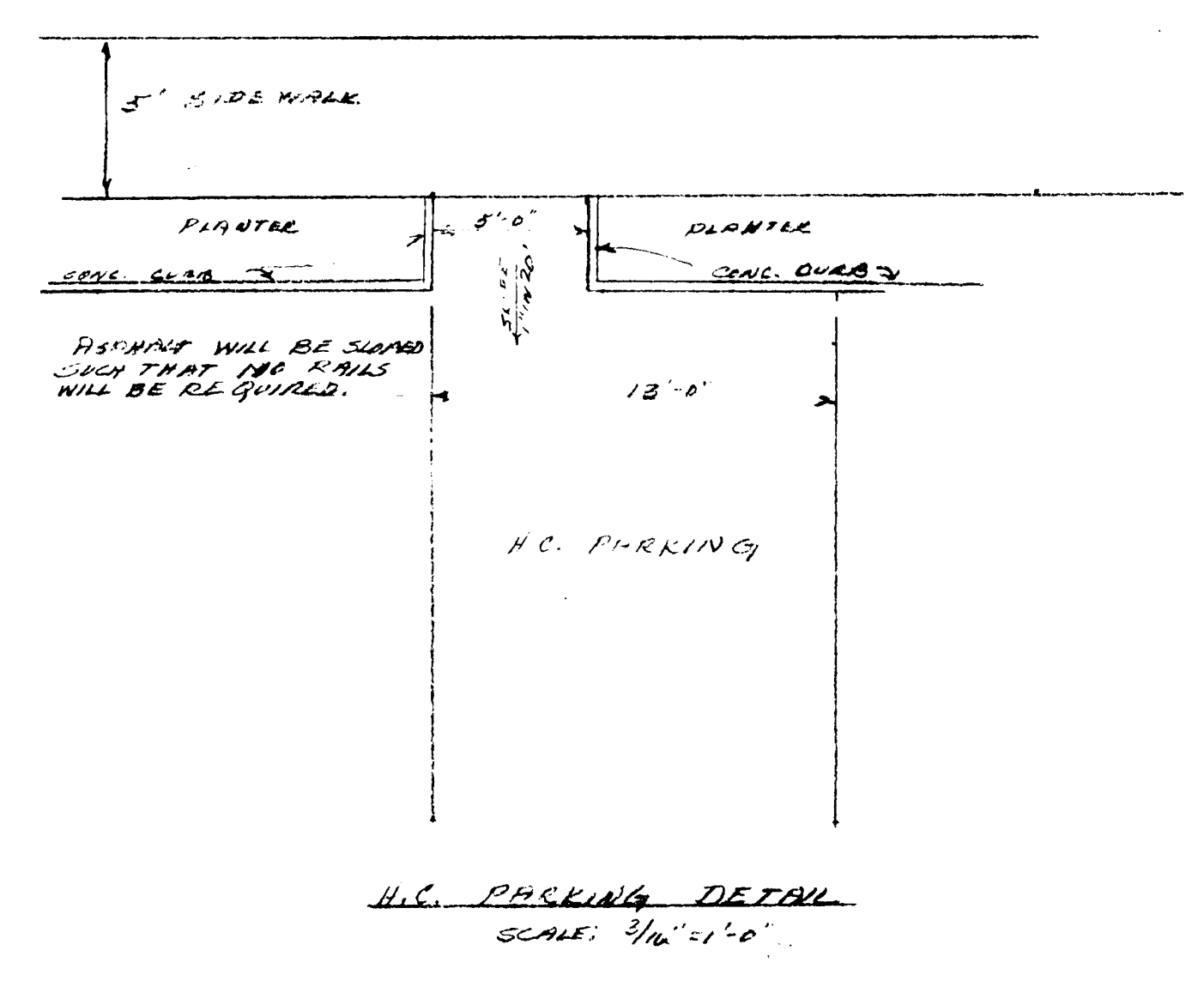

H.C. PARKING DETAIL
SCALE: 3/16" = 1'-0"

GENERAL NOTES

- ALL TREE PLANTING AND SCREENING WILL COMPLY WITH TREE ORDINANCE.
- STORM WATER DETENTION SYSTEM WILL BE DESIGNED AND INSTALLED TO MEET ALL APPLICABLE ORDINANCES.
- OWNER WILL DEDICATE 5' R/W FOR FUTURE WIDENING OF BELHAVEN BLVD. DISTANCE FROM CENTER LINE WILL BE 35'.
- NO DUMPSTER WILL BE USED. EACH AREA WILL HAVE SMALL 30 GAL TRASH CONTAINER AT REAR DOOR.
- NEW BUILDING TO BE CONSTRUCTED IN ACCORDANCE WITH 1990 NORTH CAROLINA BUILDING CODE.

ATTACHED TO ADMINISTRATIVE APPROVAL
DATED: 8/2/90
BY: MARTIN R. CRAMTON, JR.

<p>NEAL PROPERTIES CONSTRUCTION CO. CHARLOTTE, N.C.</p> <p>GENERAL CONTRACTORS — ENGINEERS 800-A BELHAVEN CHARLOTTE, N.C. 28214 (704) 399-2000</p>	<p>TITLE</p> <p>SCHROEDER BUILDING for NEW 1200 S.F. SERVICE SPACE AND 2400 S.F. OFFICE 8010 & 8012 BELHAVEN BLVD.</p>	<p>REVISIONS</p> <p>1. ADDED DETAIL "A" WITH NOTES ON DWG. 2. CHANGED NO AND TYPE OF TREES AND PLANTS</p>	<p>DATE</p> <p>8/2/90 10/1/91</p>	
	<p>PROJECT NUMBER</p> <p>DATE: 11/14/91 REV: 1/15/92 SCALE: 1" = 20'-0" DRAWN BY: J.W.N.</p>			

CHARLOTTE-MECKLENBURG PLANNING COMMISSION
INTER-OFFICE COMMUNICATION

DATE: December 4, 1991

TO: Robert Brandon
Zoning Administrator

FROM: Martin R. Cramton, Jr.
Planning Director

SUBJECT: Administrative Approval for Petition No. 90-9 by Jerry W. Neal
Tax Parcel No. 035-017-07

Attached is a revised plan for the above mentioned rezoning petition. The plan has been revised to change the types of trees and shrubs required as well as the type and number of trees required. Since these changes are minor and do not reduce the yards at the exterior of the property I am administratively approving these plans. Please use these plans when evaluating requests for building permits and certificates of occupancy.

MRCjr/RBM/cln