



* 0 0 B R E A K 0 0 *



**ADVANCED
IMAGING
SYSTEMS**

www.aisimc.com

An Information
Management Company

City of Charlotte – Planning Dept. Scanning Rezoning Files

Petition # _____

Document type:

- Applications
- Correspondence
- Department Comments
- Land Use Consistency
 - Mail Info
 - Mapping
 - Other
- Site Plans



* 0 0 B R E A K 0 0 *

PETITIONER Charlotte-Mecklenburg Planning Commission

PETITION NO. 90-34 HEARING DATE April 16, 1990

ZONING CLASSIFICATION, EXISTING I-2 REQUESTED B-2

LOCATION Approximately .394 acres located on the northwest corner of the intersection of East Carson Boulevard and South Boulevard.

South Boulevard Rezoning # 10



REZONED I-2 TO B-2

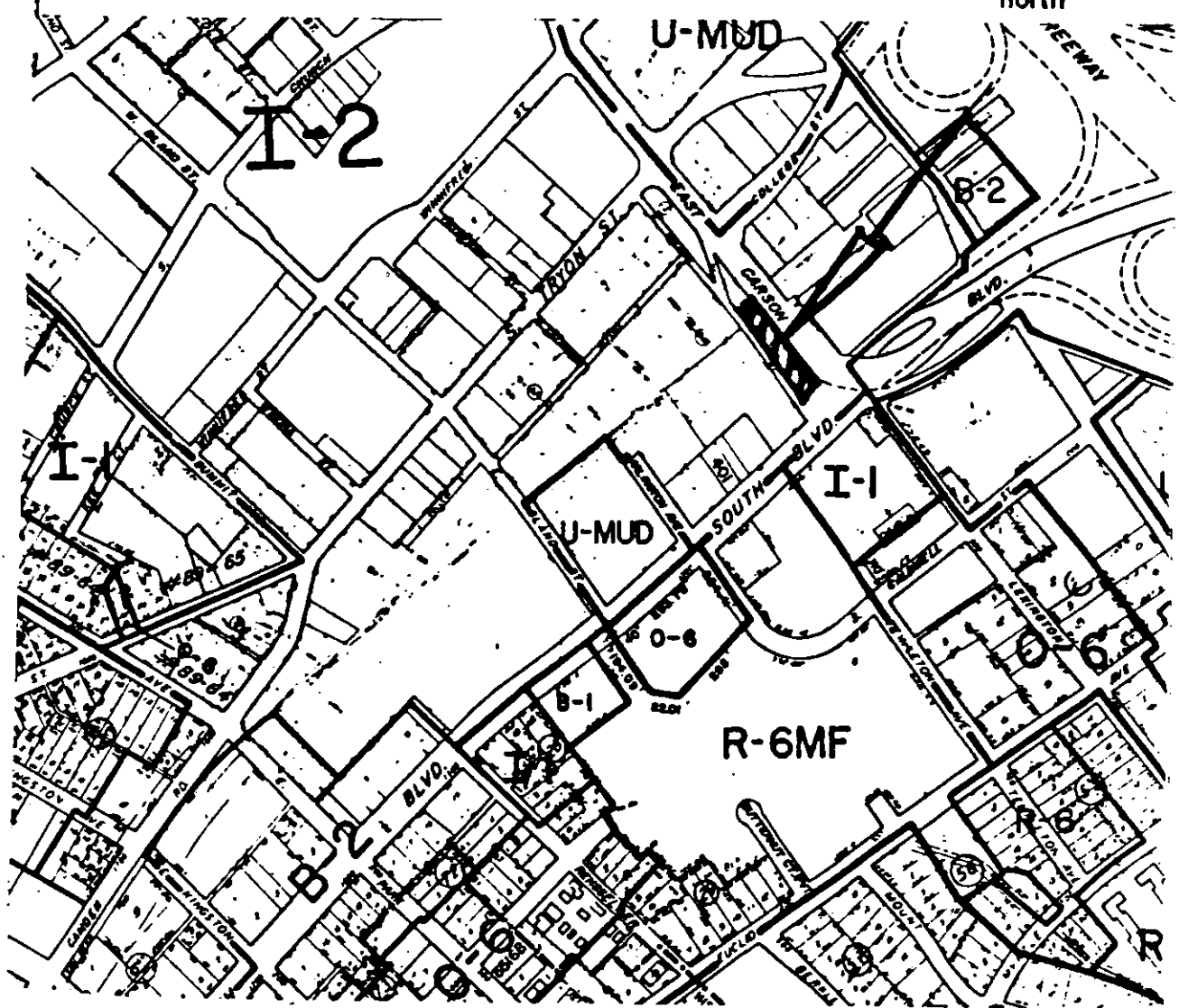

ZONING MAP NO. 102

SCALE 1" = 400'

PROPERTY PROPOSED FOR CHANGE



1159

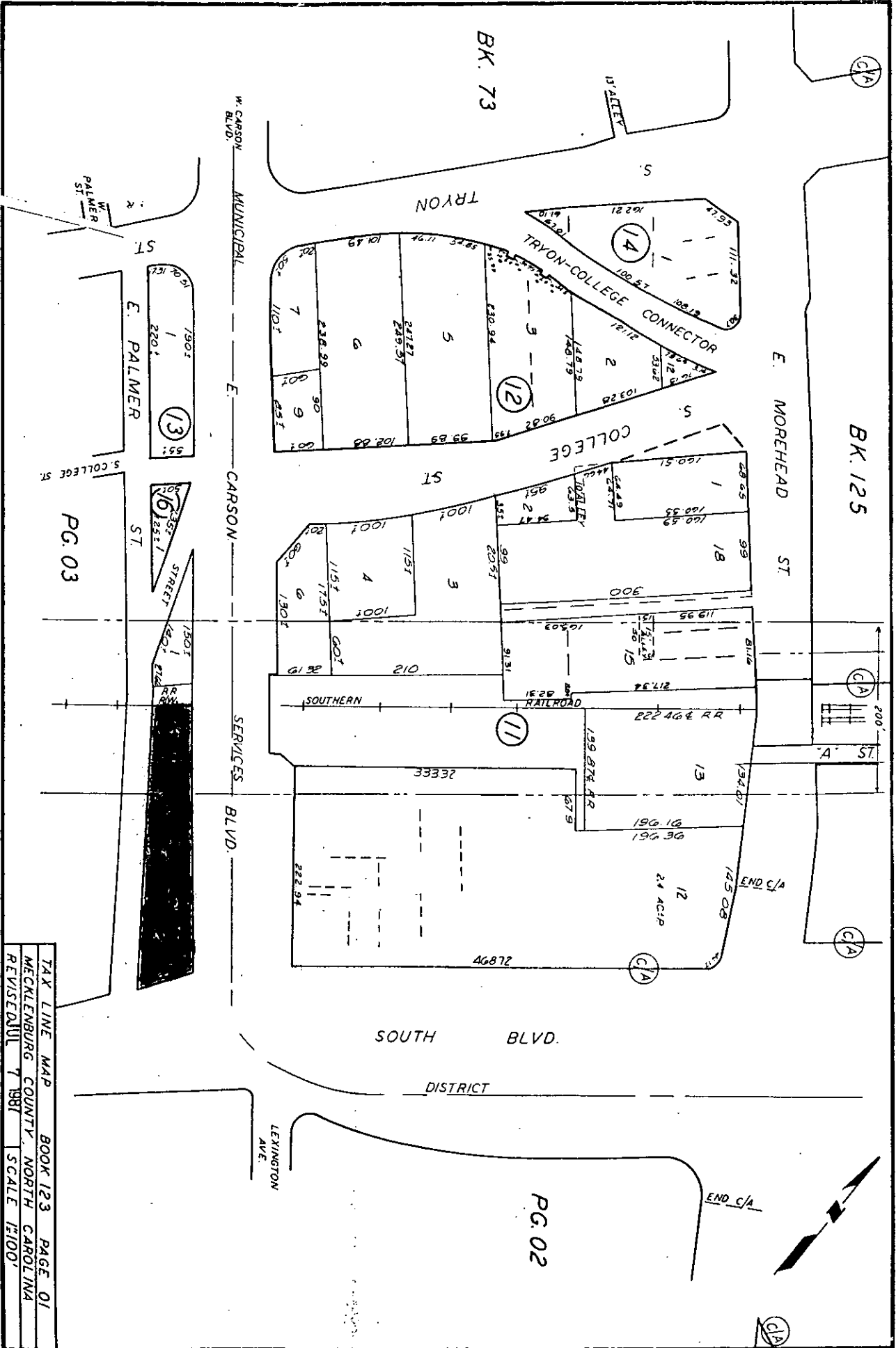

South Boulevard Rezoning # 10

REZONE FROM I-2 TO B-2

PROPERTY OWNERS

TAX LINE MAP	BOOK 123	PAGE 01
MECKLENBURG COUNTY, NORTH CAROLINA		
REVISED JUL 7 1987	SCALE 1"=100'	

South Boulevard Rezoning # 10

ADJACENT PROPERTY OWNERS

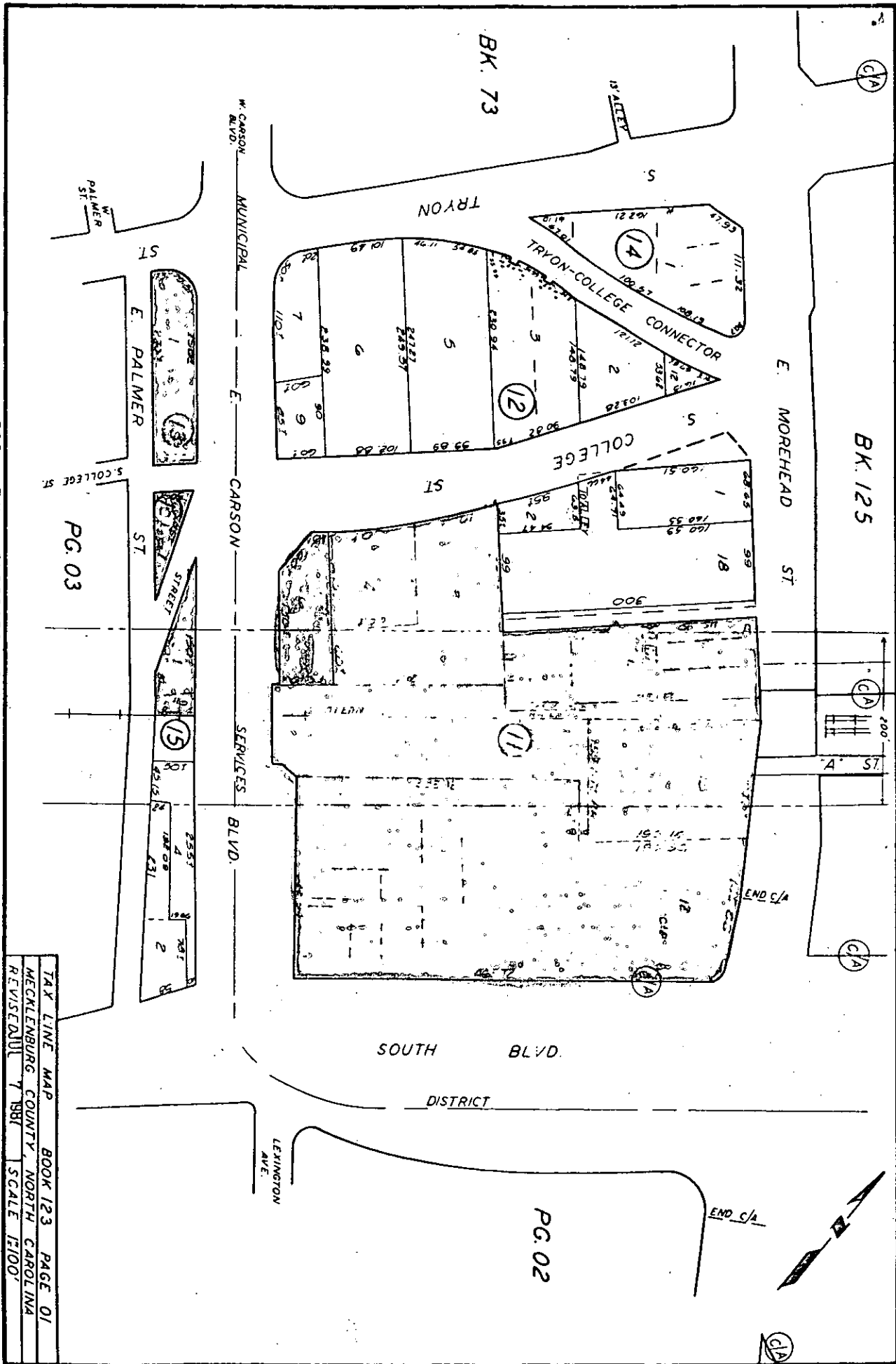

TAX LINE MAP BOOK 123 PAGE 01
 MECKLENBURG COUNTY, NORTH CAROLINA
 REVISED 7 1981 SCALE 1/100'

South Boulevard Rezoning # 40

ADJACENT PROPERTY OWNERS

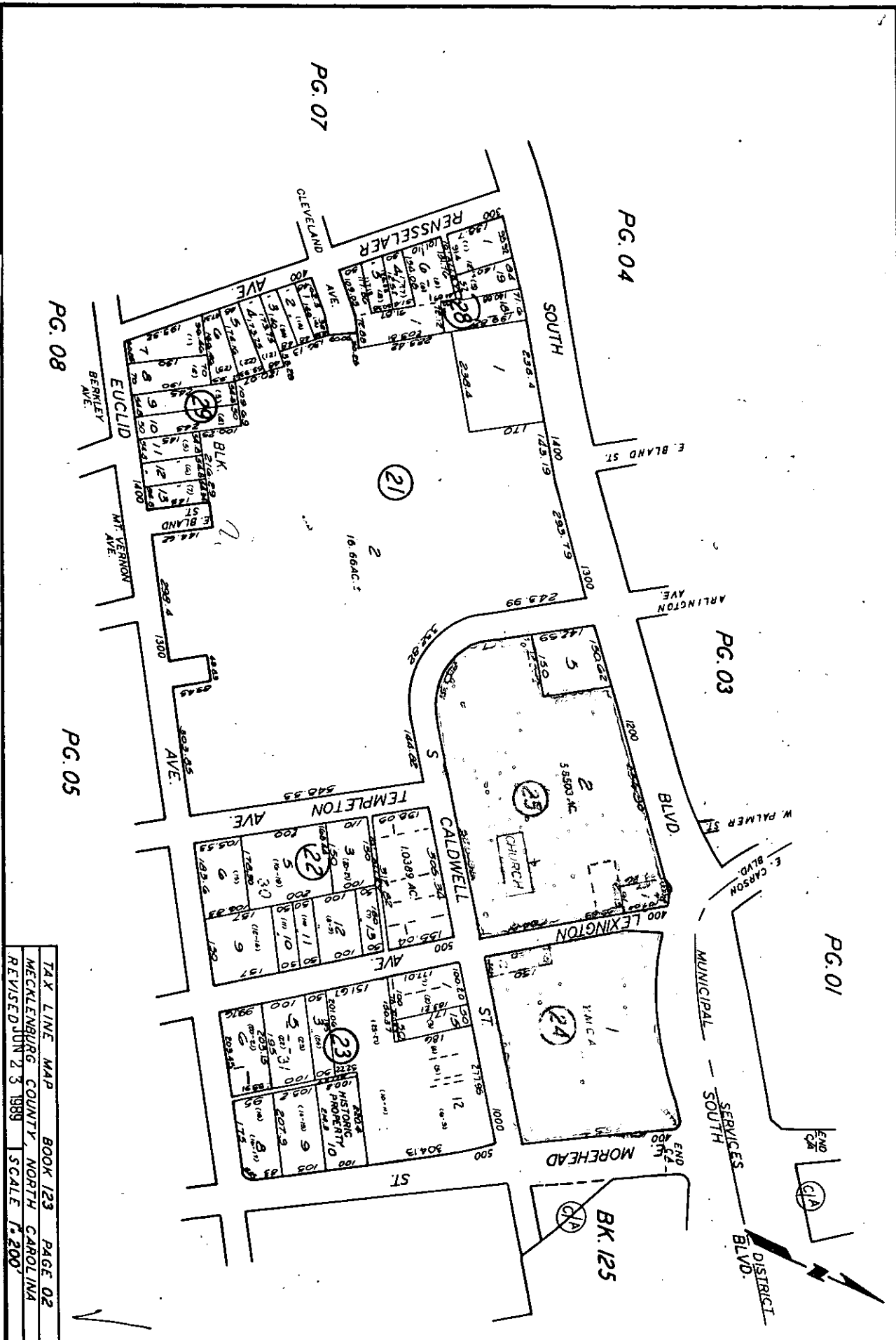

TAX LINE MAP	BOOK 123	PAGE 02
MECKLENBURG COUNTY	NORTH CAROLINA	
REVISED JUN 23 1989	SCALE 1"=200'	

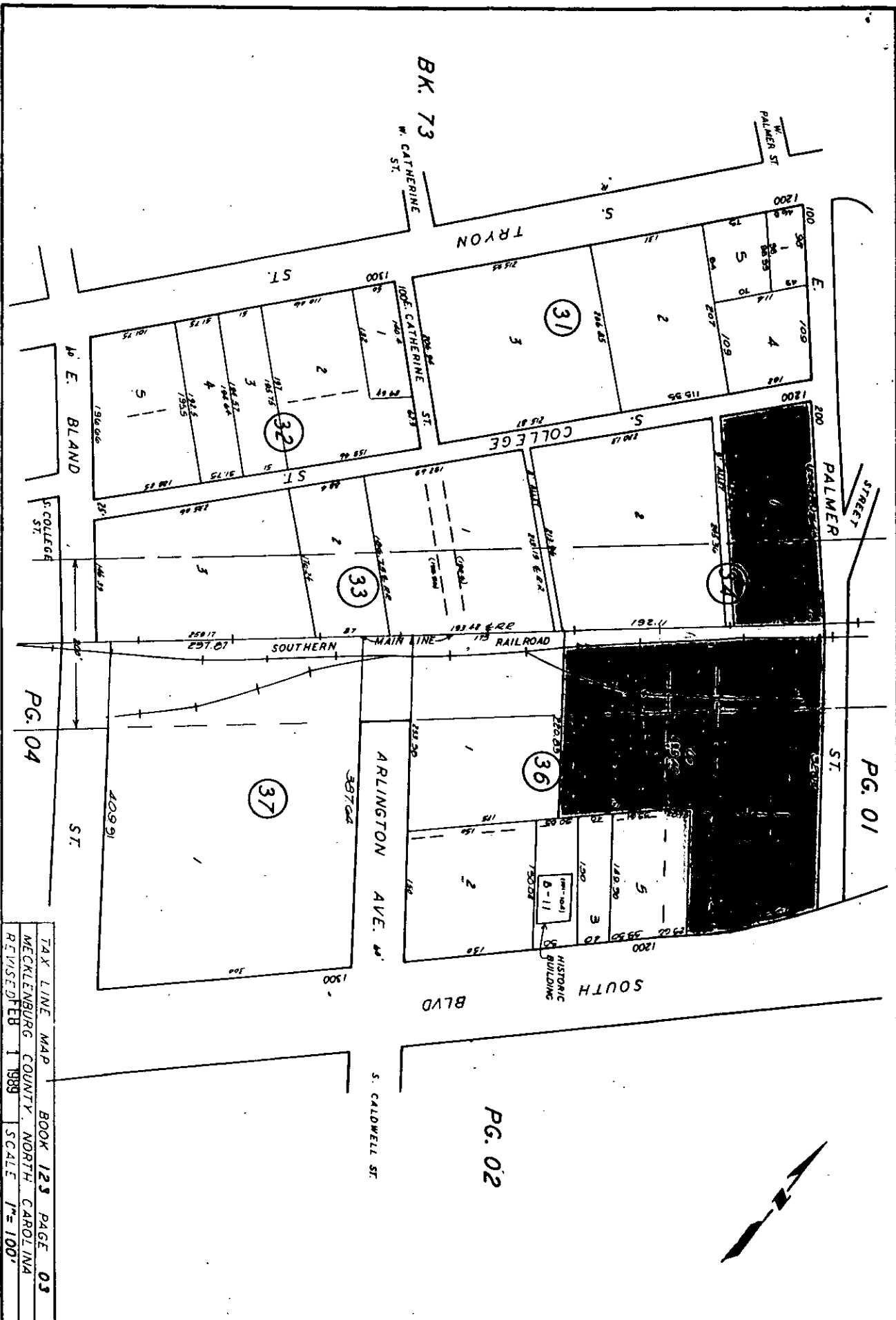

South Boulevard Rezoning # 10
ADJACENT PROPERTY OWNERS

TAX LINE MAP	BOOK 123	PAGE 03
MECKLENBURG COUNTY, NORTH CAROLINA		
REVISED FEB 1 1989	SCALE	1" = 100'

PG. 04

PG. 01

PG. 02