



* 0 0 B R E A K 0 0 *



**ADVANCED
IMAGING
SYSTEMS**

www.aisinc.com

An Information
Management Company

City of Charlotte – Planning Dept. Scanning Rezoning Files

Petition # _____

Document type:

- Applications
- Correspondence
- Department Comments
- Land Use Consistency
 - Mail Info
 - Mapping
 - Other
- Site Plans



* 0 0 B R E A K 0 0 *

PETITIONER Executive Retreats, Inc.

PETITION NO. 90-35(c) HEARING DATE September 10, 1990

ZONING CLASSIFICATION, EXISTING R-15&B-D(CD) REQUESTED Inst.(CD)

LOCATION Approximately 25.83 acres located on the west side of U.S. 521 south of Clems Branch.

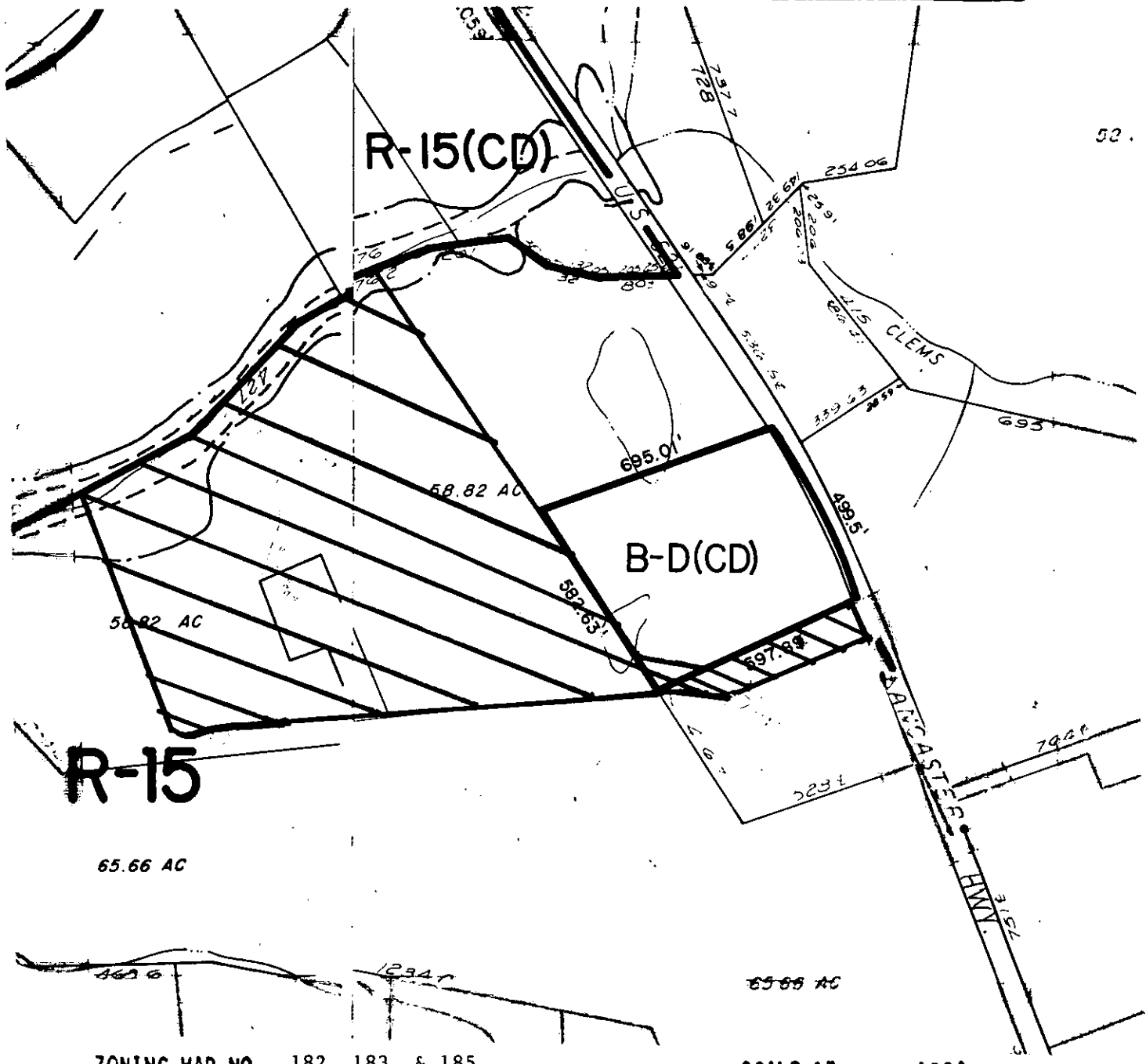

ZONING MAP NO. 182, 183, & 185

SCALE 1" = 400'

PROPERTY PROPOSED FOR CHANGE

