

SITE UTILIZATION SUMMARY

B-1 RCD	194,000 sq ft
Proposed Zoning	220,000 sq ft
Existing, Allowable Building Area	184,316 sq ft
Proposed Additional Building Area	220,000 sq ft
Existing Building Area	220,000 sq ft
Proposed Additional Building Area	179,999 sq ft
Total Building Area	
Total Parking Provided	

- NOTES**
- The only intent of this site plan amendment is to permit the addition of a maximum of 25,000 sq ft of the approved area. All other existing site plan requirements including setbacks, parking, signage, screening, and open space.
 - The plan depicts proposed location of building additions. Some additions in the plan may be subject to change. Changes in the existing building and/or parking arrangement may occur subject to normal administrative procedures.
 - Any new signage related to the building additions shall be provided in accordance with applicable ordinance provisions.



ADJACENT PROPERTY OWNERS

04-201-01	Charitable First Fed. Bankruptcy, 113 S. Salisbury St., Charlotte, NC 28203	04-211-02A	University of North Carolina at Charlotte, 2211 Northpark Dr., Charlotte, NC 28213
04-211-03	First State Four Seasons, 2700 Old 1st Bank Center, Charlotte, NC 28202	04-211-02B	Southpark 211, 211 Northpark Dr., Atlanta, GA 30301
04-211-05	John E. Kirk and Wife, 1201 Ballantyne Creek Church Road, Charlotte, NC 28215	04-211-07	State Employees Credit Union, Charlotte, NC 28255
04-211-06	John E. Kirk and Wife, 8000 Midway Drive, Charlotte, NC 28215	04-211-12	State of North Carolina, Raleigh, NC 27602
04-211-07	Ann E. Spence, 8001 Midway Drive, Charlotte, NC 28215	04-211-17	State of North Carolina, Raleigh, NC 27602
04-211-08	University Professional Park Associates, 453 N. Henderson Blvd., Charlotte, NC 28211	04-211-23A	State of North Carolina, Raleigh, NC 27602
04-211-09	American Commercial Service Bank Inc., Charlotte, NC 28203	04-211-23B	State of North Carolina, Raleigh, NC 27602
		04-211-23C	State of North Carolina, Raleigh, NC 27602
		04-211-22	ALTA Bank and WFA, Charlotte, NC 28213

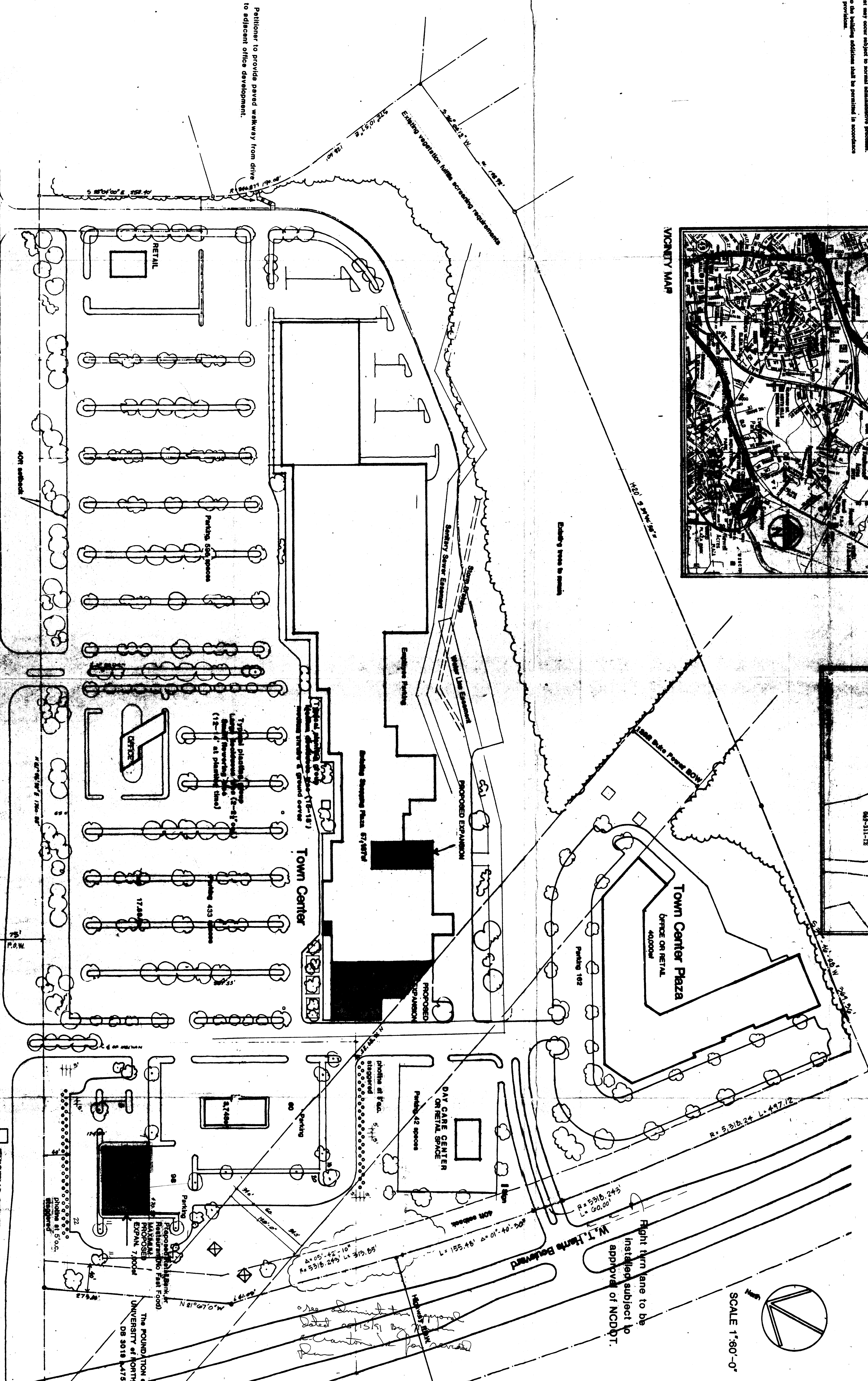

Patitioner to provide paved walkway from drive to adjacent office development.

40ft setback

University Boulevard (N.C. Highway 440)

EXISTING BUILDING

PROPOSED ADDITIONS

Project Number: 2264

Sheet: RZ-1

VARETOS

GOPFOLD

Drawn By: [Signature]

Date: 9-27-80

Project: [Redacted]

APPROVED BY COUNTY COMMISSION

CHARLOTTE, N.C. DATE: 1/22/91

90-556

Sheet Title: **REZONING PLAN FOR PUBLIC HEARING SITE PLAN AMENDMENT**

Crosland-Erwin-Associates