



\* 0 0 B R E A K 0 0 \*



ADVANCED  
IMAGING  
SYSTEMS

www.aisimc.com

An Information  
Management Company

# City of Charlotte – Planning Dept. Scanning Rezoning Files

Petition # \_\_\_\_\_

## Document type:

- Applications
- Correspondence
- Department Comments
- Land Use Consistency
  - Mail Info
  - Mapping
  - Other
- Site Plans



\* 0 0 B R E A K 0 0 \*

PETITIONER: William T. Birchfield, Jr.

PETITION NO.: 91-35(c) HEARING DATE: October 14, 1991

ZONING CLASSIFICATION, EXISTING: R-12 REQUESTED: B-D(CD)

LOCATION: A 40,000 square foot parcel located on the west side of Wallace Neel Road south of Old Dowd Road (4312 Wallace Neel Road).

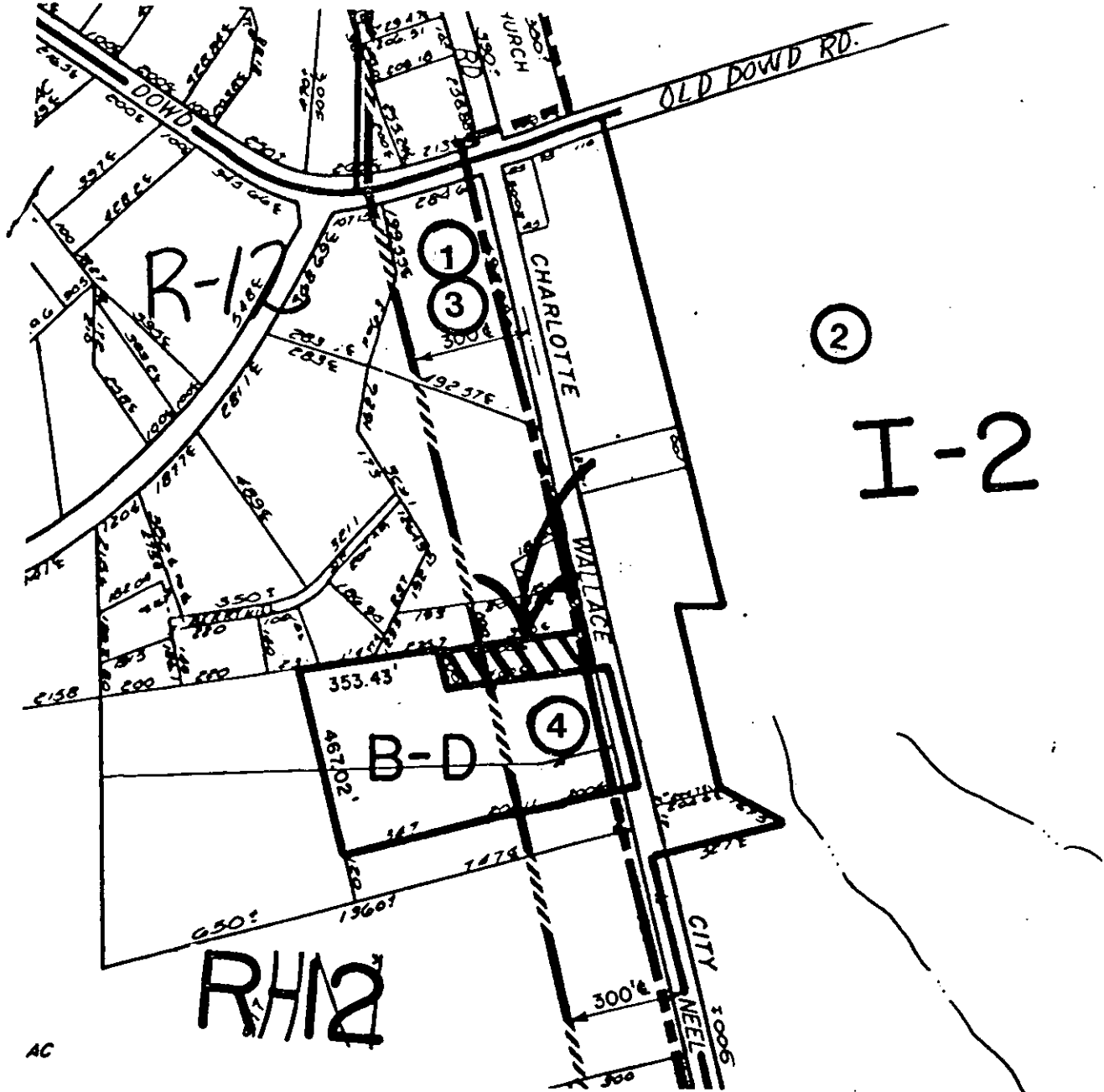

ZONING MAP NO(s): 105

SCALE 1" = 400'

PROPERTY PROPOSED FOR CHANGE



OFFICIAL REZONING APPLICATION  
MECKLENBURG COUNTY

Petition No.	91-35(c)
Date Filed	August 12, 1991
Received By	MCN
OFFICE USE ONLY	

Staff Review - Tues. Sept 3 @ 2:00 P.M.

Ownership Information

Property Owner William T. Birchfield, Jr.  
 Owner's Address 16069 TABO TABO DR. TEGA CAY, SC 29715  
 Date Property Acquired May 1991  
 Tax Parcel Number 113 133 04

Location of Property (address or description) 4312 WALLACE NEEL RD. Charlotte, NC 28208

Description of Property  
 Size (Sq. Ft.-Acres) 40,000 Street Frontage (ft.) 100  
 Current Land Use RESIDENTIAL SINGLE FAMILY HOUSE

Zoning Request

Existing Zoning R-12 Requested Zoning B-D(CD)  
 Purpose of Zoning Change OWNER WISHES TO BUILD A 6800 SQ. FT. WAREHOUSE ON THE PROPERTY.

Name of Agent \_\_\_\_\_ Name of Petitioner(s) William T. Birchfield, Jr.  
 Agent's Address \_\_\_\_\_ Address of Petitioner(s) 16069 TABO TABO - TEGA CAY, SC  
 Telephone Number \_\_\_\_\_ Telephone Number H-803-548-5491 O-704-399-4450

William T. Birchfield, Jr.  
Signature

Signature of Property Owner  
if Other Than Petitioner