



\* 0 0 B R E A K 0 0 \*



www.aisimc.com

**ADVANCED  
IMAGING  
SYSTEMS**

An Information  
Management Company

# City of Charlotte – Planning Dept. Scanning Rezoning Files

Petition # \_\_\_\_\_

## Document type:

- ☐ Applications
- ☐ Correspondence
- ☐ Department Comments
- ☐ Land Use Consistency
  - ☐ Mail Info
  - ☒ Mapping
  - ☐ Other
- ☐ Site Plans



\* 0 0 B R E A K 0 0 \*

PETITIONER: Child Acre Day Care Center, Inc.

PETITION NO.: 91-47 HEARING DATE: July 15, 1991

R-9 Special Use Permit &  
ZONING CLASSIFICATION, EXISTING: Conditional Use REQUESTED: R-9MF(CD)

LOCATION: Approximately 7.9 acres located on the west side of Old Pineville Road north of Old Pineville Road.

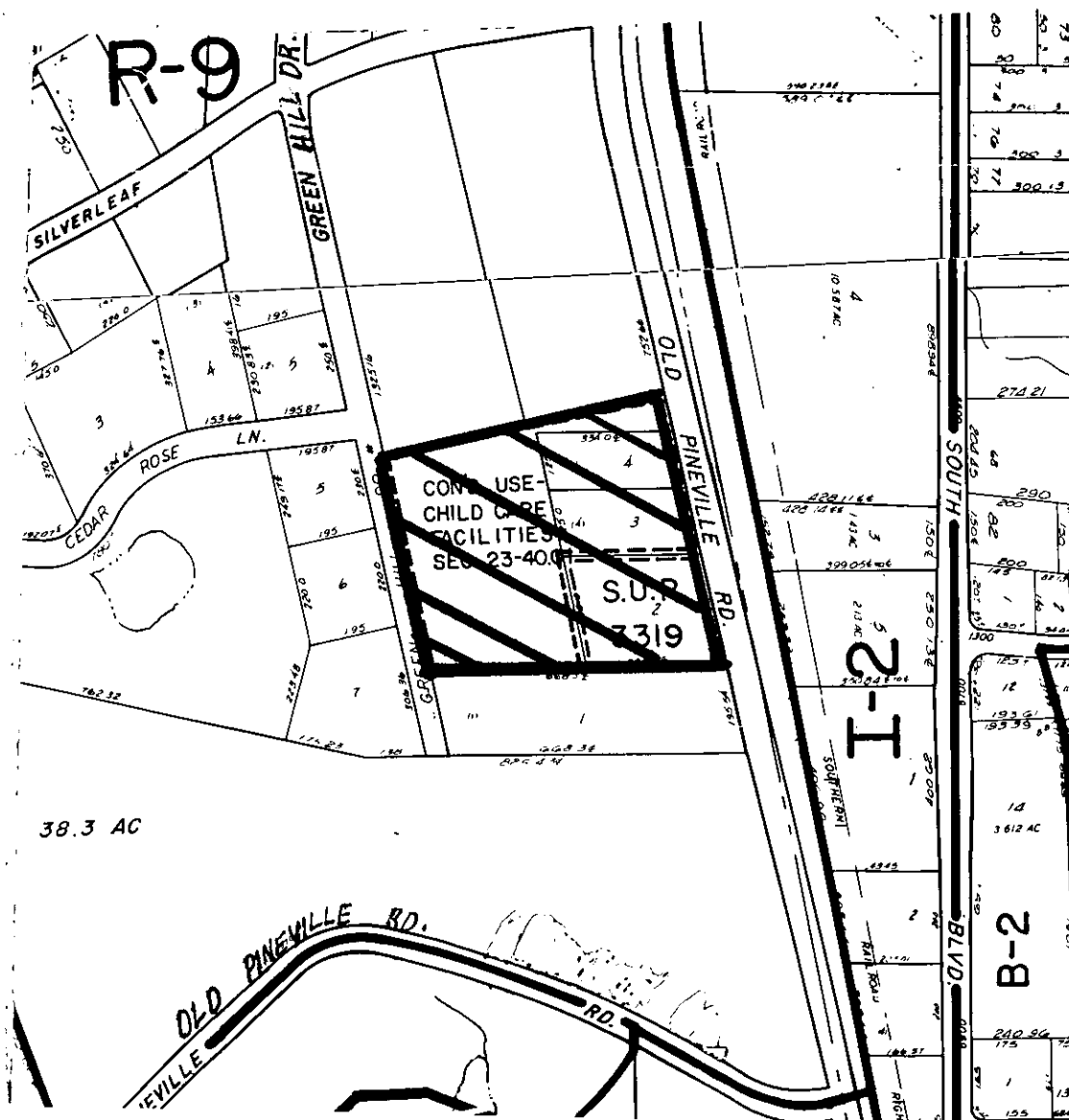

ZONING MAP NO(s): 134 & 148

SCALE 1" = 400'

PROPERTY PROPOSED FOR CHANGE

