

GENERAL STORAGE

- THE AIRPORT AGREES TO PROVIDE FOR THE CONTINUATION OF THE GOFFEY CREEK GREENWAY SYSTEM'S PEDESTRIAN PATHWAY AT A WIDTH BETWEEN 60 AND 75 FEET THROUGH THE SUBJECT PROPERTY TO PROVIDE CONNECTION WITH THE AIRPORT'S PERIMETER WALKING TRAIL.
- BOUNDARY INFORMATION TAKEN FROM SURVEY BY JOHN D. CAMPBELL, NCRLS, DATED MAY 1, 1991.
- ALL SIGNAGE AND PARKING REQUIREMENTS SHALL CONFORM WITH APPLICABLE SECTIONS OF THE CITY OF CHARLOTTE ZONING ORDINANCE.
- THE TWENTY FOOT BUFFER EXTENDING ALONG THE EASTERN PORTION OF THE SITE IS TO REMAIN UNDISTURBED EXCEPT TO THE EXTENT NECESSARY TO ACCOMMODATE PEDESTRIAN PATHWAYS, FENCES OR STORM WATER RETENTION PONDS.
- BUILDINGS OR PARKING LOTS ARE PROHIBITED WITHIN ANY SETBACK AREA OR BUFFER AREA SPECIFICALLY DESIGNATED ON THIS PLAN.
- LANDSCAPING ALONG BYRUM DRIVE AND PINEY TOP DRIVE, AS ILLUSTRATED ON THE LANDSCAPING SECTION, SHALL BE CONSISTENT WITH THE AIRPORT LANDSCAPING MASTER PLAN. THIS SHALL INCLUDE EXISTING AND RANDOMLY PLANTED TREES RANGING IN SIZE FROM 1" TO 8" CALIBER AT PLANTING, A WALKING TRAIL (PARCEL "A" ONLY), AND A SIX FOOT CHAIN LINK FENCE FOR SECURITY PURPOSES. INSTALLATION OF LANDSCAPING SHALL BE PHASED WITH DEVELOPMENT. FOR EXAMPLE, LANDSCAPING ALONG THE FRONTAGE OF BYRUM DRIVE ASSOCIATED WITH THE CHARLOTTE-MECKLENBURG ANIMAL CONTROL FACILITY SHALL BE INSTALLED SIMULTANEOUSLY WITH THE DEVELOPMENT OF THIS FACILITY. EXISTING VEGETATION ILLUSTRATED ON THE LANDSCAPING PLAN SECTION SHALL BE PRESERVED TO THE EXTENT THAT IS PRACTICAL TO ACCOMMODATE THE WALKING TRAIL AND ALLOW VISIBILITY OF THE SECURITY FENCE.
- THIS SITE PLAN DEPICTS THE GENERAL LOCATION OF THE SPECIFIED USES. (MECKLENBURG COUNTY WOOD AND YARD WASTE PROCESSING FACILITY, CHARLOTTE-MECKLENBURG ANIMAL CONTROL FACILITY AND THE AIR NATIONAL GUARD FIRE TRAINING PIT). SPECIFIC BUILDING ENVELOPES FOR THE ABOVE USES ARE NOT DEPICTED ON THIS SITE PLAN.
- ACCESS POINTS: A MAXIMUM OF SIX (6) ACCESS POINTS ARE ALLOWED FOR PARCEL "A", (3 FOR BYRUM DRIVE AND 3 FOR PINEY TOP DRIVE). A MAXIMUM OF THREE (3) ACCESS POINTS ARE ALLOWED FOR PARCEL "B". ALL POINTS OF ACCESS ARE SUBJECT TO C.D.O.T. AND/OR N.C.D.O.T. APPROVAL.
- SCREENING SHALL MEET OR EXCEED THE REQUIREMENTS OF SECTION 1601 OF CITY OF CHARLOTTE ZONING ORDINANCE.
- SPECIFIC LANDSCAPING PLANS SHALL BE COORDINATED WITH PLANNING STAFF FOR ADMINISTRATIVE APPROVAL PRIOR TO ISSUANCE OF BUILDING PERMITS.
- NO OUTDOOR STORAGE SHALL BE PERMITTED WITHIN 100 FEET OF THE RIGHTS-OF-WAY OF BYRUM DRIVE AND PINEY TOP DRIVE AS ILLUSTRATED ON THE SITE PLAN.

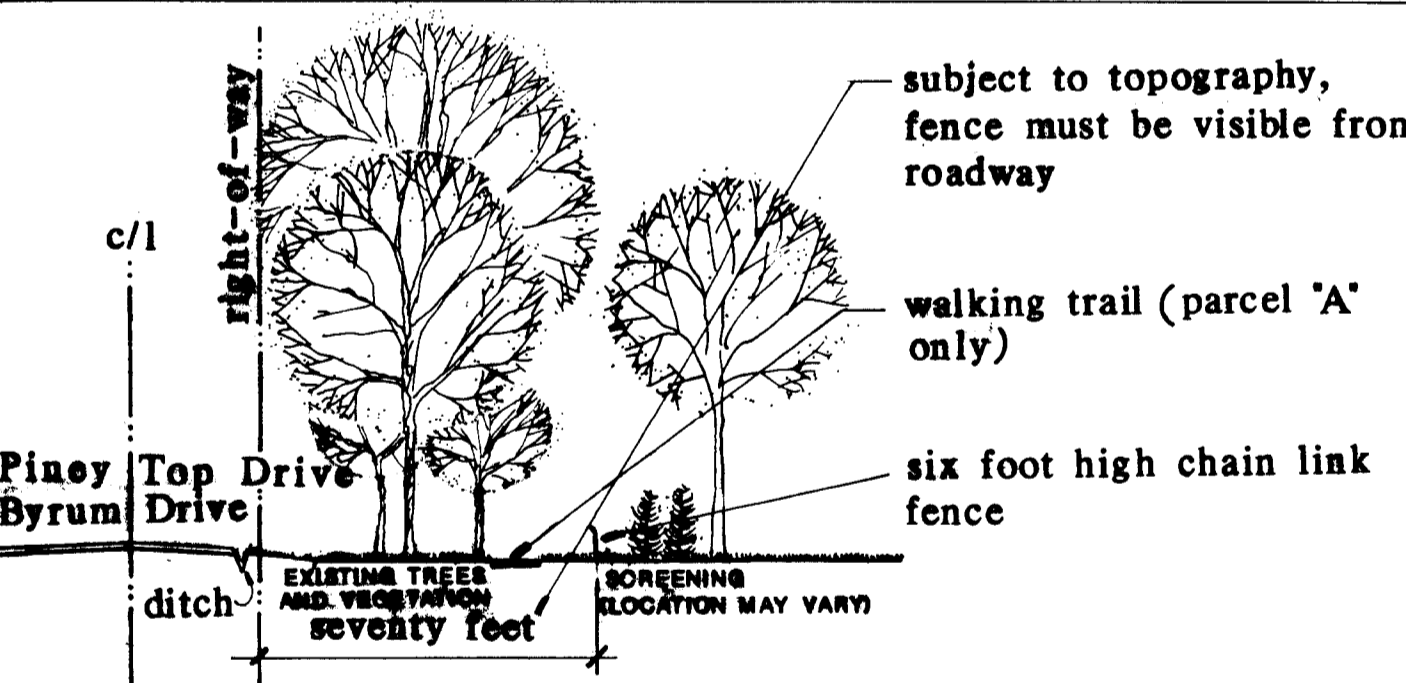

LANDSCAPING SECTION

one inch equals forty feet

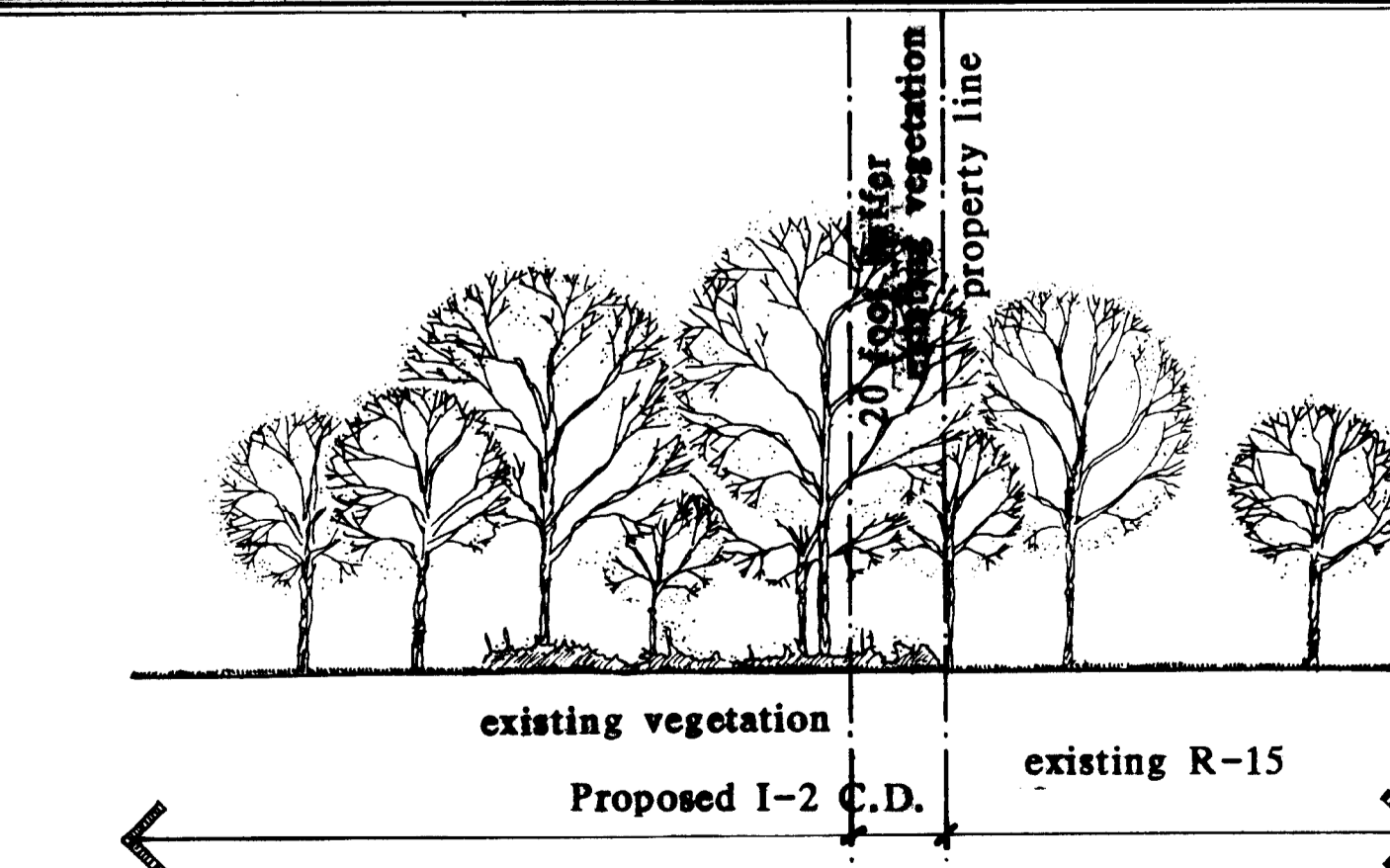

SECTION THROUGH 20' BUFFER

one inch equals forty feet

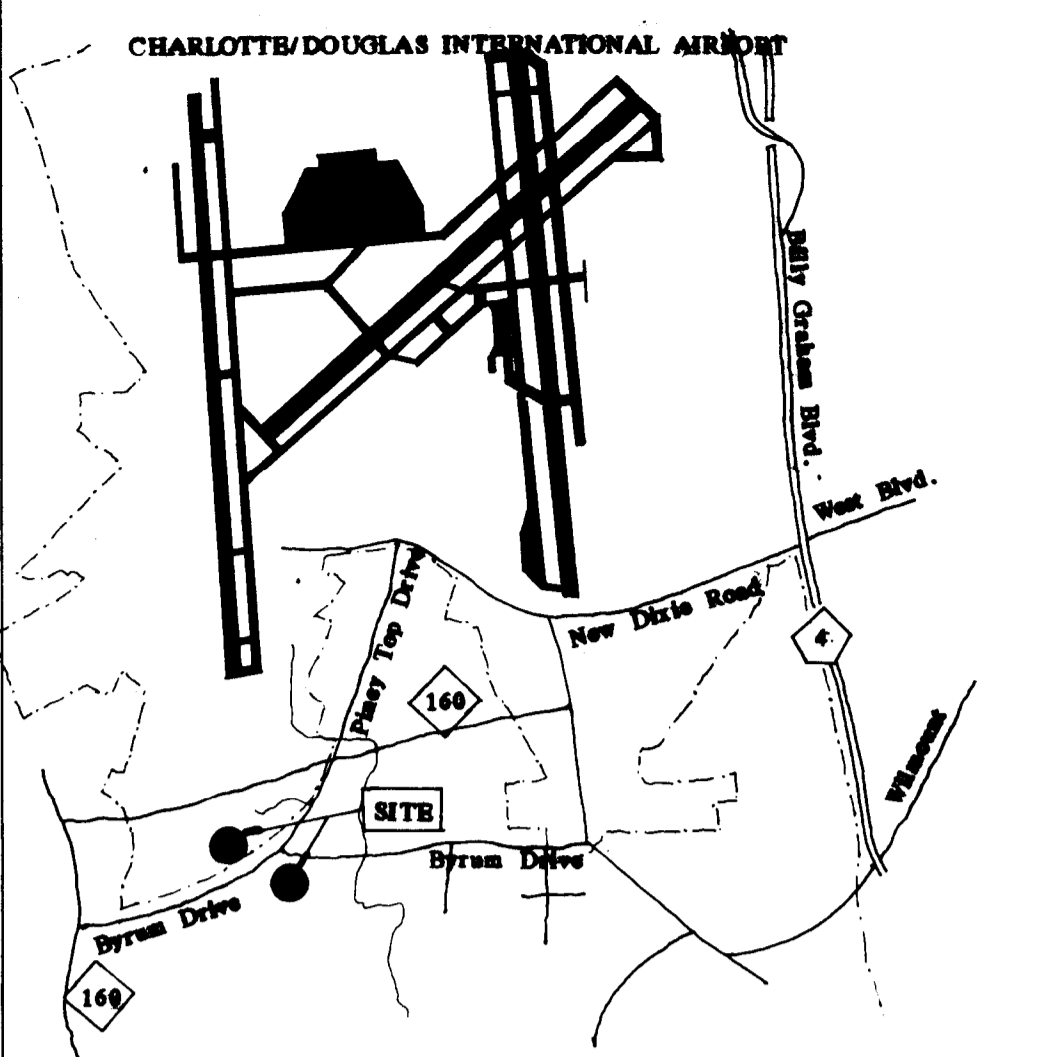
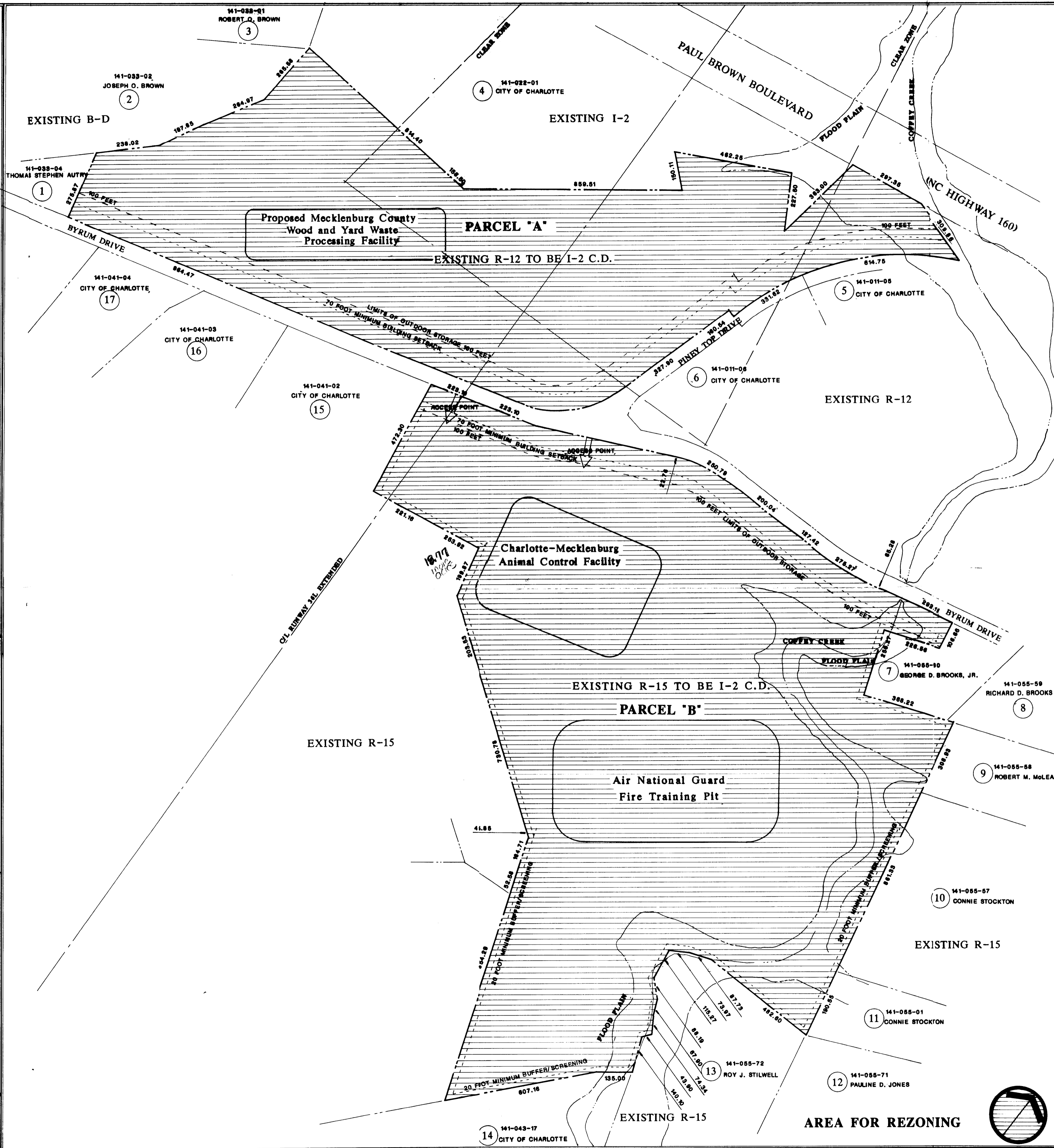

DEVELOPMENT NOTES

Site Area To Be Rezoned 134.94 acres
 Existing Zoning R-12 & R-15
 Proposed Zoning I-2 C.D.

Parcel A
 Existing Zoning R-12
 Proposed Zoning I-2 C.D.
 Acreage 52.10 acres
 Proposed Uses: Mecklenburg County Wood and Yard Waste Processing Facility, any use permitted in I-2 zoning district and/or any use associated with the operation of the airport.

Parcel B
 Existing Zoning R-15
 Proposed Zoning I-2 C.D.
 Acreage 82.84 acres
 Proposed Uses: Charlotte-Mecklenburg Animal Control Facility, Air National Guard Fire Training Pit, any use permitted in I-2 zoning district and/or any use associated with the operation of the airport.

DATE: BY MARTIN R. CRAMTON, JR.
 FOR REVISED PLAN

APPROVED BY CITY COUNCIL
 DATE 11/18/91

"FOR PUBLIC HEARING" 9/1-67

Byrum Drive/Piney Top Drive/NC Highway 160 Site
 Scale 1"=200' Date OCTOBER 28, 1991 Drawn CTD